

ALTERNATE ACTION, LED ILLUMINATED & SEALED



Front Mount



Raised Dome



The LP5 offers the same rugged, sealed construction as the proven P5 series with the added benefit of reliable LED illumination. It is a precision snap-action switch designed for use in off-highway, material handling, industrial controls, marine, medical and other demanding Commercial applications. Choose from the standard mounting styles and electrical ratings, or contact us for custom configurations.

Now you can design panels with both alternate and momentary action switches and have uniform panel appearance. The OTTO LP5 series features alternate action in the same pushbutton and housing configurations as the OTTO momentary LP3 series.

Push and the LP5 series switch turns "on." Push again and the LP5 switch turns "off." Positive tactile feedback is featured so the operator is clearly aware the switch mode has been actuated. The button returns to the original position after each actuation.

## Features:

- **Watertight to IP68S; moistureproof & dusttight to IP64**
- **LED lighted with the ability to accommodate 2, 6, 12 & 24VDC power & includes reverse voltage protection**
- **Tall & dome style buttons in translucent white, red, amber, green and blue permitting sublimated & pad printed legends**
- **Quick disconnect terminals**
- **15/32" & 5/8" thread, press fit & dome case options**
- **RoHS compliant**

### Standard Characteristics/Ratings:

#### ELECTRICAL RATINGS:

Load	Sea Level @ 28VDC or 115VAC
Resistive	5A
Inductive	3A
Lamp	1A
Motor	3A
DWV	1000Vrms through switch contacts only
Logic Level	10mA @ 5VDC

**Electrical Life:** Standard 25,000 cycles, Logic Level 200,000 cycles

#### LIGHTING:

Light Source Voltage (DC)	Typ. Forward Voltage (DC)	Voltage Max (DC)
2*	1.9 to 3.3 (dep. on color)	2.5 to 4 (dep. on color)
6	6	8
12	12	14.5
24	24	28.6

**Mechanical Life:** 200,000 cycles

**Seal:** Unsealed, IP64 or IP68S

**Operating Temp Range:** -55°C to +85°C

**Operating Force:** 3.0 lbs. +1.0/-0.5 lb.

**Total Travel:** 0.180 inches max

**Overtravel:** 0.012 inches min

#### MATERIALS:

**Case:** Anodized aluminum alloy

**Button:** Thermoplastic

**Mounting Hardware:** Hex nut, lockwasher, and panel gasket (watertight only)

## LP5 PART NUMBER CODE

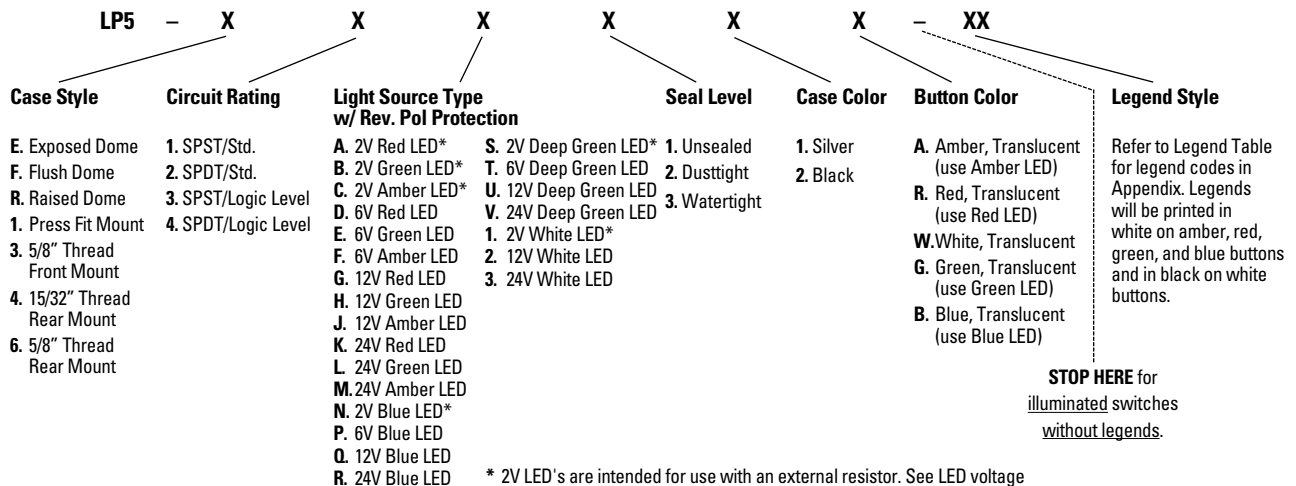

\* 2V LED's are intended for use with an external resistor. See LED voltage chart in appendix for details on the approximate value of the resistor. See appendix for complete voltage/ratings table.

For super bright LEDs, contact factory.

# ILLUMINATED ALTERNATE ACTION PUSHBUTTONS

**LP5**  
ILLUMINATED  
PUSHBUTTONS

## ALTERNATE ACTION, LED ILLUMINATED & SEALED

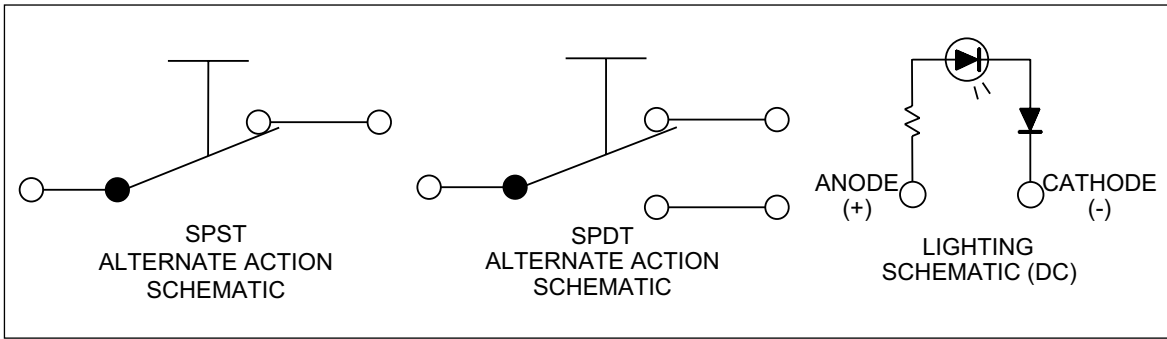

**LP5-EXXXXX**  
Alternate Action, Exposed Dome Button

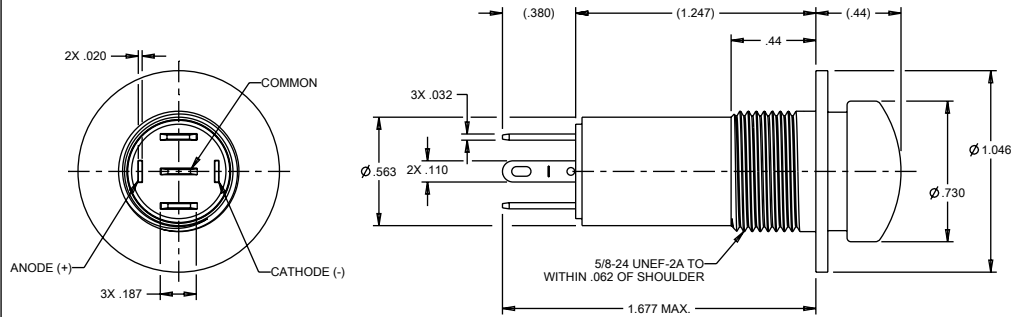
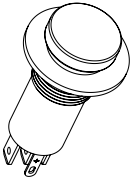

**LP5-FXXXXX**  
Alternate Action, Flush Dome Button

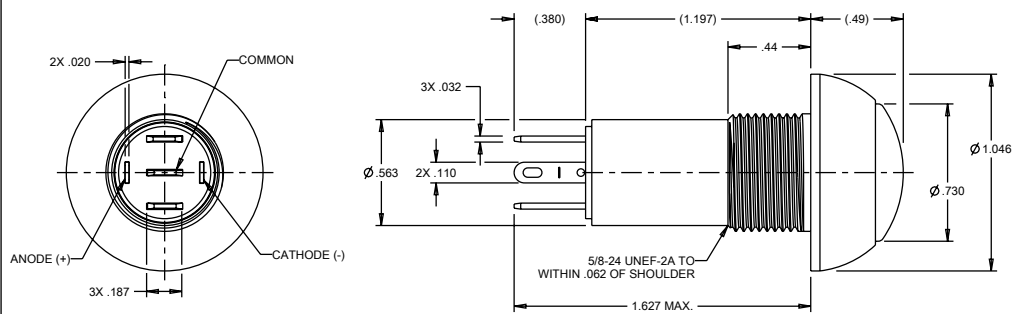
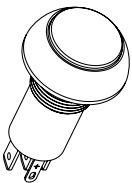

**LP5-RXXXXX**  
Alternate Action, Raised Dome Button

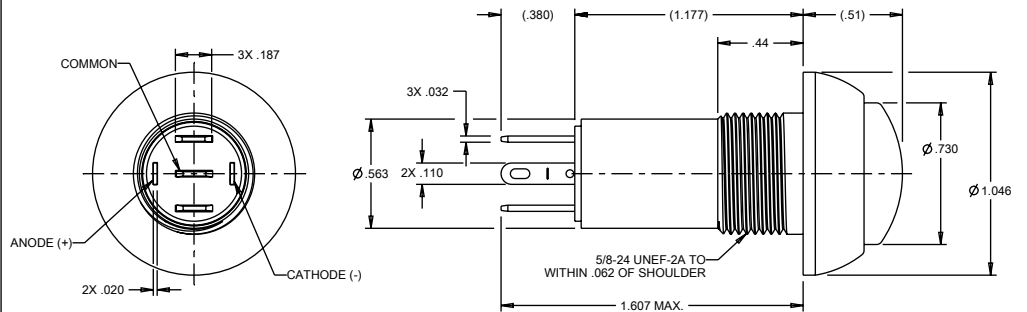
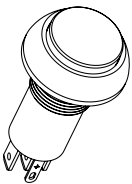

PUSHBUTTON SWITCHES

ALTERNATE ACTION, LED ILLUMINATED & SEALED

**LP5-1XXXXX**

Alternate Action, Press Fit Mount

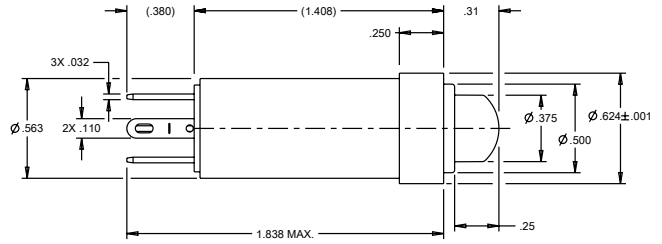
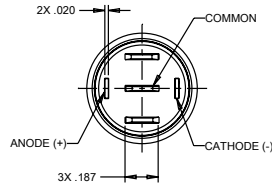
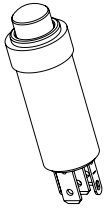

**LP5-3XXXXX**

Alternate Action, 5/8" Threaded Front Mount

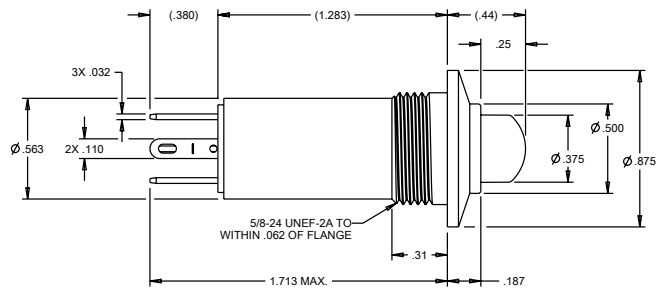
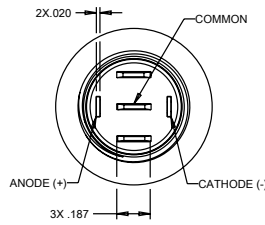
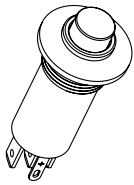

**LP5-4XXXXX**

Alternate Action, 15/32" Threaded Rear Mount

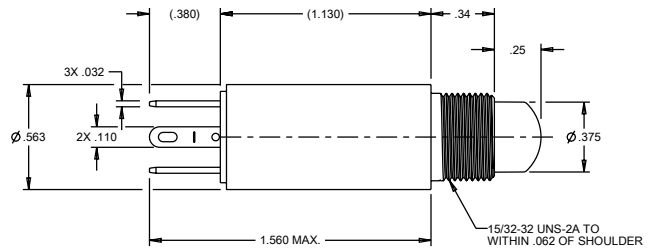
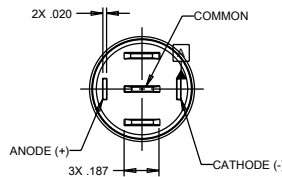

**LP5-6XXXXX**

Alternate Action, 5/8" Threaded Rear Mount

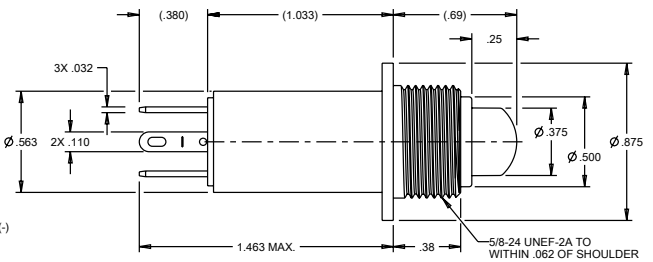
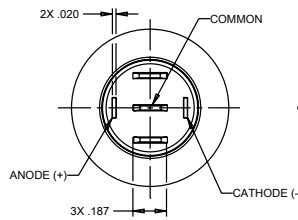
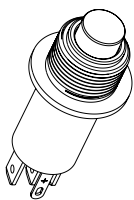

**NOTE:**  
For indicator light only,  
see LPL indicator light pages 153-155.