

PANEL PLUGS FOR ROCKER & R2 SERIES

K1 THROUGH K5 & R2 PANEL PLUGS

K1-PA Panel Plug One Piece Molded

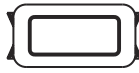

OPTIONAL PANEL GASKET:

0.062" THICKNESS =
P/N C807039-25-1

0.031" THICKNESS =
P/N C807039-25-2

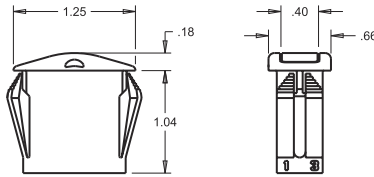

MOUNTING HOLE

RECOMMENDED PANEL THICKNESS:

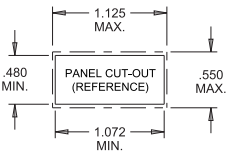

RANGE 0.025 - 0.105 OPTIONAL PANEL GASKET RECOMMENDED
RANGE 0.105 - 0.187 WITHOUT GASKET

Panel Opening:	Min.	Typ.	Max.
Width	0.480	0.515	0.550
Length	1.072	1.099	1.125

K2-PB Panel Plug Assembled Plug

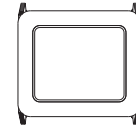

OPTIONAL PANEL GASKET:

0.062" THICKNESS =
P/N C807038-25-1

0.031" THICKNESS =
P/N C807038-25-2

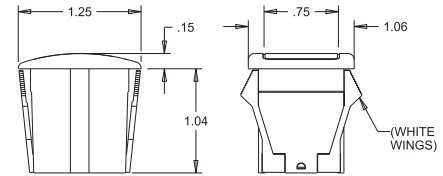

MOUNTING HOLE

RECOMMENDED PANEL THICKNESS:

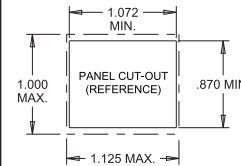

RANGE 0.025 - 0.105 OPTIONAL PANEL GASKET RECOMMENDED
RANGE 0.105 - 0.187 WITHOUT GASKET

Panel Opening:	Min.	Typ.	Max.
Width	0.870	0.937	1.00
Length	1.072	1.099	1.125

K4-PB Panel Plug Assembled Plug

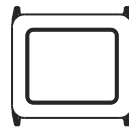

OPTIONAL PANEL GASKET:

0.062" THICKNESS =
P/N C807038-25-1

0.031" THICKNESS =
P/N C807038-25-2

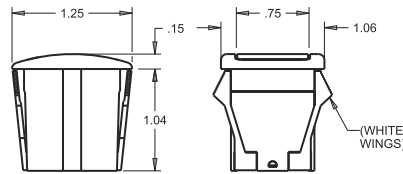

MOUNTING HOLE

RECOMMENDED PANEL THICKNESS:

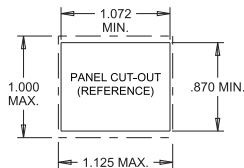

RANGE 0.025 - 0.105 OPTIONAL PANEL GASKET RECOMMENDED
RANGE 0.105 - 0.187 WITHOUT GASKET

Panel Opening:	Min.	Typ.	Max.
Width	0.870	0.937	1.00
Length	1.072	1.099	1.125

K3-PB Panel Plug Assembled Plug

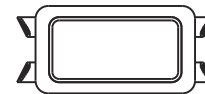

OPTIONAL PANEL GASKET:

P/N C807037-25

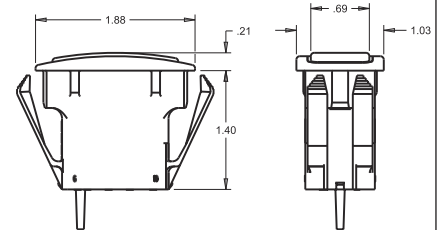

MOUNTING HOLE

RECOMMENDED PANEL THICKNESS:

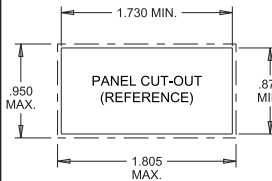

RANGE 0.025 - 0.105 OPTIONAL PANEL GASKET RECOMMENDED
RANGE 0.102 - 0.187 WITHOUT GASKET

Panel Opening:	Min.	Typ.	Max.
Width	0.870	0.937	0.950
Length	1.730	1.768	1.805

K5-PA Panel Plug One Piece Molded

Also Fits R2 Rotary Switches



OPTIONAL PANEL GASKET:

P/N C807109-25-1

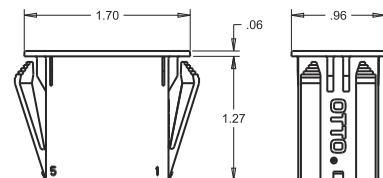

MOUNTING HOLE

RECOMMENDED PANEL THICKNESS:

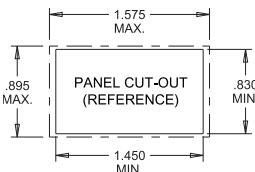

RANGE 0.025 - 0.105 OPTIONAL PANEL GASKET RECOMMENDED
RANGE 0.105 - 0.187 WITHOUT GASKET

Panel Opening:	Min.	Typ.	Max.
Width	0.830	0.863	0.895
Length	1.450	1.513	1.575

PANEL PLUG PART NUMBER CODE

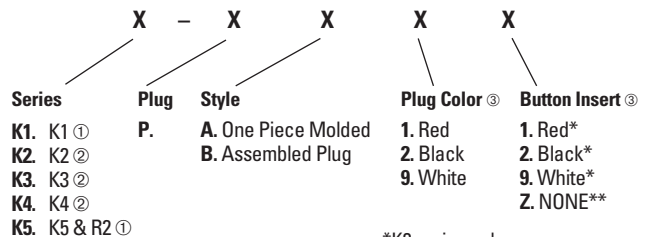

*K3 series only.
**Molded plug only.

- ① Available in Style A only.
- ② Available in Style B only.
- ③ Additional colors available. Contact factory.