

Data Sheet for Article: MM216540--

# Surface mounting enclosure, 6 holes, black/ light grey

IP66



## Technical Data

Series	MM
Illumination	non-illuminated
Colour	Black/light gray
Device category	6
Make-up	Surface mount housing
Optional Accessories	MM216374--;MM216594--;MM216643--;MM216378--;MM216376--;MM216609--;MM216611--
shock resistance	30G
Ambient temperature Open (°C)	-25°C...+70°C
Climatic proofing	Damp heat, constant, to IEC 60068-2-78 Damp heat, cyclic, to IEC 60068-2-30
Standards	IEC/EN 60947, VDE 0660
Mounting position	any
Type No.	M22-16

## Maßbild

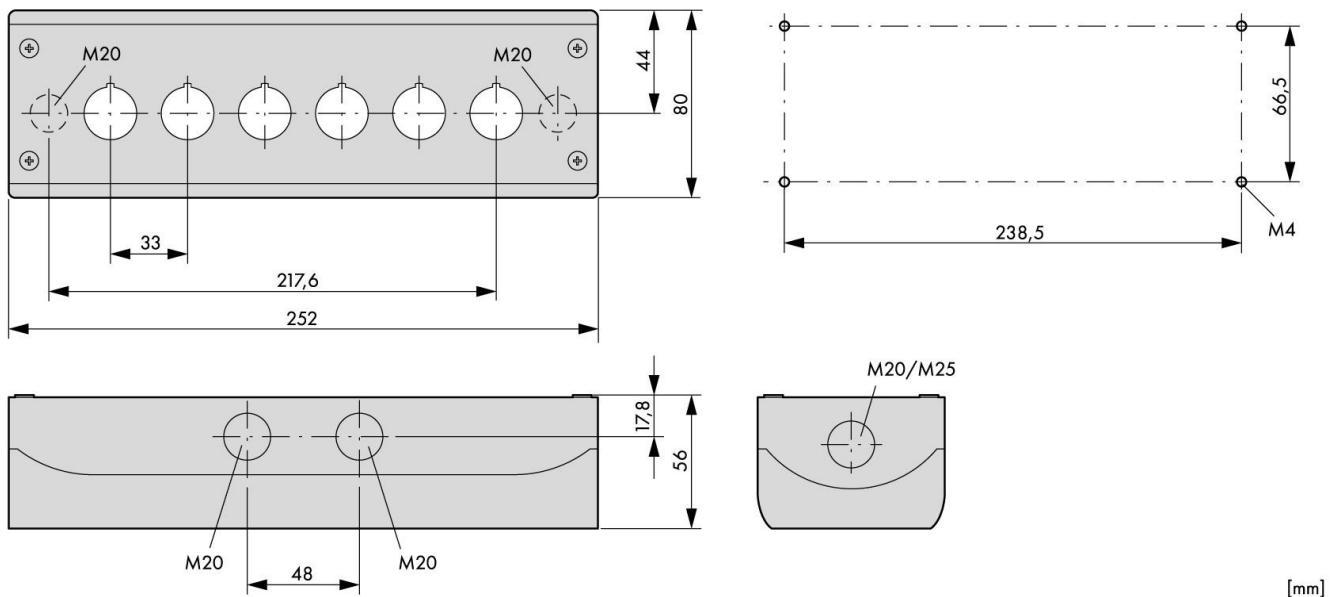

## Article Table

DESCRIPTION	Order No.
Surface mounting enclosure, 6 holes, black/light grey IP66	MM216540
<b>Optional Accessories</b>	
Adapter ( front)	MM216374
Push-button flat, spring-return, red IP67	MM216594
Push-button extended, spring-return, green IP67	MM216643
NC contact block front mount	MM216378
NO contact block front mount	MM216376
Push-button flat, `0`, spring-return, black IP67	MM216609
Push-button flat, `I`, spring-return, white IP67	MM216611