

Dimension (Allowable error: ± 1mm)

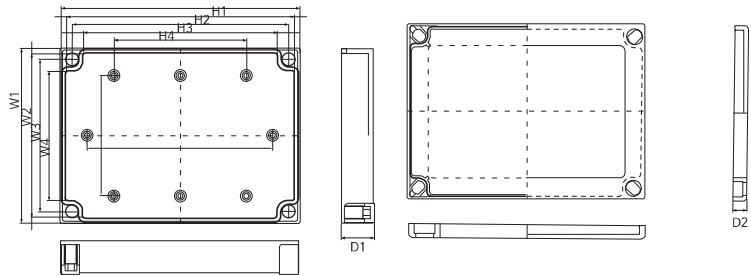

BODY

COVER

Model	Division	H1	H2	H3	H4	W1	W2	W3	W4	D1	D2
EL-1308		132	126	113	95	82	76	63	45	25	10
EL-1313		130	124	113	95	130	124	113	95	25	10
EL-1318		180	172	163	146	130	122	113	96	25	10
EL-1308-B		132	126	113	95	82	76	63	45	50	10
EL-1313-B		130	124	113	95	130	124	113	95	50	10
EL-1318-B		180	172	163	146	130	122	113	96	50	10

※ 000 mark of product at the above product list is to express a material.

Dimensions(mm)			Inch	Part Number						Internal Plate	
Width	Height	Depth		AG	AT	PG	PT	PCG	PCT	STEEL	PLASTIC
										Steel Mounting Plate	Plastic Mounting Plate
80	130	35	3.15×5.12×1.38	EL-000-1308							
130	130	35	5.12×5.12×1.38	EL-000-1313							
130	180	35	5.12×7.09×1.38	EL-000-1318							
80	130	60	3.15×5.12×2.36	EL-000-1308-B							
130	130	60	5.12×5.12×2.36	EL-000-1313-B							
130	180	60	5.12×7.09×2.36	EL-000-1318-B							

Waterproof, Dustproof, Protection Class	IP67	
Impact Test	IK08	
Temperature Table	AG(ABS)	PG(PC/ABS)
	-40°C ~+85°C	-40°C ~+90°C
	PCG(PBT/PC)	Clear cover (PC)
	-40°C ~+100°C	-40°C ~+130°C
Flammability	ABS : 94-HB	
	PC / ABS : 94-5VB~5VA	
	PBT : 94-5VA	
	PC : 94-HB, 94-V-0~5VA	

Materials & Composition Table

A G · Material : ABS · Color : Gray	A T · Material : Cover(PC), Body(ABS) · Color : Cover(Clear), Body(Gray)
P G · Material : AC Flammability · Color : Gray	P T · Material : Cover(PC), Body(AC) · Color : Cover(Clear), Body(Gray)
P C G · Material : POLYESTER · Color : Gray	P C T · Material : Cover(PC), Body(POLYESTER) · Color : Cover(Clear), Body(Gray)

ABS : Acrylonitrile Butadiene Styrene	PC : PolyCarbonate
Polyester : PBT+PC	AC : ABS(30%)+PC(70%)

Application Accessories

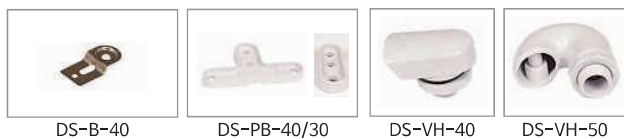

DS-B-40

DS-PB-40/30

DS-VH-40

DS-VH-50