

Data Sheet for Article: BZH11151--

Analog time switch 1 MW, without power reserve

for DIN rail mounting



Schrack-Info

- Daily program
- Slim format 17,5mm
- Captive setting keys
- Manual override switch
- Permanent ON / Permanent OFF / AUTO

Technical Data

Net width (mm)	17,80
Net height (mm)	90,00
Min. ambient temperature (°C)	-10
Max. ambient temperature (°C)	50
Operating voltage AC (V)	230
Power consumption	0,4W
Switching contacts	1 NO
Contact material	AgSnO ₂
Switching capacity [Resistive]	16A / 250V~ bei cosΦ=1

Technical Data - continued

Switching capacity [inductive load]	2,5A / 250V~ at $\cos\Phi=0,6$
Switching capacity (kW)	min. 1000mW (10V / 10mA)
Shortest switching distance	15 min
Accuracy	Quarz: $\leq \pm 1$ sec./day
Temperature range - Operation (°C)	-10 to +50
Housing	Self-extinguishing thermoplastic
Mounting	35mm DIN-Rail
IP Rating	IP20
Protection class	II
Pollution degree	2
Rated impulse withstand voltage [Uimp] (V)	4kV

Switching loads

Glüh-, Halogenlampen	2000W
Leuchtstofflampe unkompensiert	1000W
Leuchtstofflampe reihenkompensiert	750W
Energiesparlampe	200W
LED (230VAC)	200W

Circuit diagram: Analog time switch 1MW, without power reserve

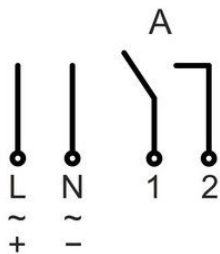

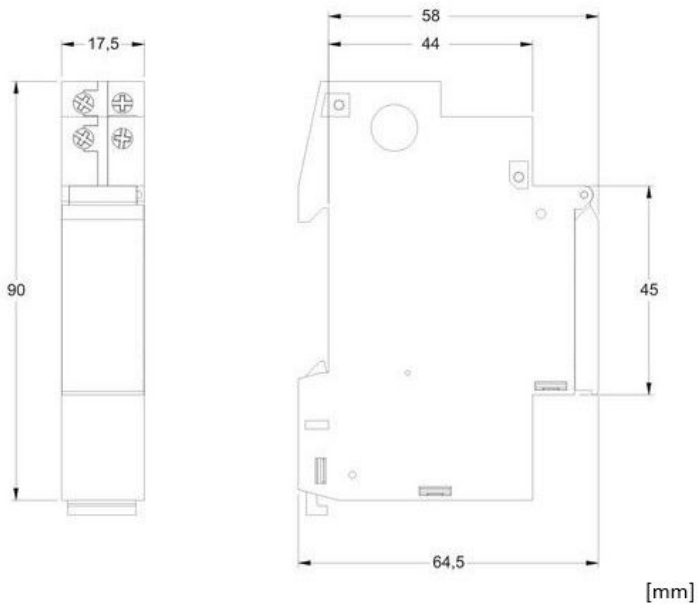
Dimensioned drawing: Analog time switch 1MW, without power reserve

DESCRIPTION

Analog time switch 1MW, without power reserve
for DIN rail mounting

Order No.

BZH11151