



LINKWELL[®]
ELECTRIC



CABLE MANAGEMENT SYSTEM



LKP SERIES

PLASTIC RECTANGULAR CABLE ENTRY PLATE

Energy saving, environmental protection, and efficient product performance meet the requirements of temperature control systems

IP65 

LKP/N 24/11



LKP/N 24/12



LKP/N 24/13



LKP/N 24/14



LKP/N 24/17



LKP/N 24/17-1



LKP/N 24/22



LKP/N 24/22-1



LKP/N 24/23



LKP/N 24/29



LKP/N 24/29-1



LKP/N 24/80



PARAMETERS

Material: improved polyamides

Temperature range: -30°C ~ +70°C

Protection grade: IP65

Flame retardancy: UL 94 V0

External dimensions: L=147mm×B=59×15mm

The tensile properties are consistent DIN/EN 50262/98 weak acids and bases.

Color: black

The size of the hole: 36×112mm

Thickness of protection: 14mm

Harmful ingredients: halogen-free

PECULIARITY

- Save space
- Built-in sealing structure
- Single entry mode
- The possibility of cable and cable marking

DIMENSION (mm)

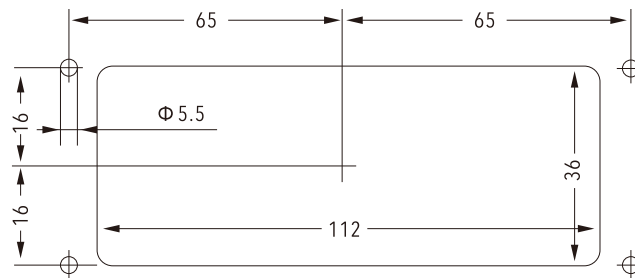

| Model No. | The corresponding cable diameter(mm) | | | | | | | | | Holes |
|---------------|--------------------------------------|---------|---------|---------|---------|----------|----------|----------|-----------|-------|
| | 1.5-2.6 | 2.5-5.0 | 3.0-6.5 | 4.1-8.1 | 5.0-9.2 | 8.0-12.5 | 9.0-14.0 | 9.6-15.9 | 14.0-20.0 | |
| LKP/N 24/11 | -- | -- | 4 | -- | 4 | -- | -- | -- | 3 | 11 |
| LKP/N 24/12 | -- | -- | -- | -- | -- | 12 | -- | -- | -- | 12 |
| LKP/N 24/13 | -- | -- | 2 | 6 | -- | -- | 4 | -- | 1 | 13 |
| LKP/N 24/14 | -- | -- | 6 | -- | 4 | -- | -- | 4 | -- | 14 |
| LKP/N 24/17 | -- | -- | -- | -- | 17 | -- | -- | -- | -- | 17 |
| LKP/N 24/17-1 | -- | -- | 11 | 1 | -- | 5 | -- | -- | -- | 17 |
| LKP/N 24/22 | -- | -- | 15 | -- | 6 | -- | -- | -- | 1 | 22 |
| LKP/N 24/22-1 | -- | -- | 16 | -- | 4 | 2 | -- | -- | -- | 22 |
| LKP/N 24/23 | -- | -- | -- | 23 | -- | -- | -- | -- | -- | 23 |
| LKP/N 24/29 | -- | -- | 29 | -- | -- | -- | -- | -- | -- | 29 |
| LKP/N 24/29-1 | -- | -- | 26 | -- | 3 | -- | -- | -- | -- | 29 |
| LKP/N 24/80 | 78 | 2 | -- | -- | -- | -- | -- | -- | -- | 80 |

LK series



LK stress-relieving plates can be used to reduce the stress on cables, ropes or wires, making them reasonably arranged, simplifying and reducing costs.

Material: polyamides

Temperature range: -40 ~ +125°C can be up to +140°C in a short time.

Flame retardancy: UL 94 V0



| Model No. | Color | No. of Teeth | Model No. | Color | No. of Teeth |
|-----------|-------|--------------|-----------|-------|--------------|
| LK04 | black | 12 | LK87/50 | black | 6 |
| LK05 | black | 15 | LK103 | black | 7 |
| LK39 | black | 3 | LK121 | black | 8 |
| LK60 | black | 4 | LK140 | black | 9 |
| LK70 | black | 5 | LK180/6 | black | 12 |
| LK80 | black | 6 | LK180/8 | black | 12 |
| LK87/68 | black | 6 | | | |

LK-KAF series



LK stress-relieving plates can be used to reduce the stress on cables, ropes or wires, making them reasonably arranged, simplifying and reducing costs.

Applicable: 35mm HAT rail (EN 50022; Niedax 2934; 2936) or track C (Niedax2970); 2971).

Material: polyamides

Temperature range: -40 ~ +125°C can be up to +140°C in a short time.

Flame retardancy: UL 94 V0



| Model No. | Color | No. of Teeth |
|-----------|-------|--------------|
| LK-KAF11 | Black | 1 |
| LK-KAF75 | Black | 5 |
| LK-KAF140 | Black | 9 |

LK-MH series



MH is to add metal gaskets to standard LK products to enhance the fixed strength.

Material: polyamides

Temperature range: -40 ~ +125°C can be up to +140°C in a short time.

Flame retardancy: UL 94 V0

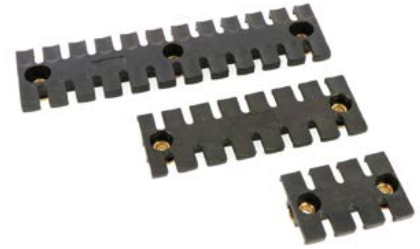

| Model No. | Color | No. of Teeth | Model No. | Color | No. of Teeth |
|-----------|-------|--------------|------------|-------|--------------|
| LK-MH39 | black | 3 | LK-MH39/6 | black | 3 |
| LK-MH60 | black | 4 | LK-MH60/6 | black | 4 |
| LK-MH87 | black | 6 | LK-MH70/6 | black | 5 |
| LK-MH103 | black | 7 | LK-MH87/6 | black | 6 |
| LK-MH121 | black | 8 | LK-MH103/6 | black | 7 |
| LK-MH140 | black | 9 | LK-MH121/6 | black | 8 |
| LK-MH180 | black | 12 | LK-MH140/6 | black | 9 |
| | | | LK-MH180/6 | black | 12 |

LK-SW series



SW is a metal fixing device which can be directly fixed on the C track on the standard LK products and is specially used in the locomotive industry.

Material: polyamides

Temperature range: -40 ~ +125°C can be up to +140°C in a short time.

Flame retardancy: UL 94 V0



| Model No. | Color | No. of Teeth |
|------------|-------|--------------|
| LK-SW39 | black | 3 |
| LK-SW60 | black | 4 |
| LK-SW87 | black | 6 |
| LK-SW103 | black | 7 |
| LK-SW121 | black | 8 |
| LK-SW140 | black | 9 |
| LK-SW180/6 | black | 12 |

CES-CABLE ENTRY SYSTEMS





FRAME HEIGHT: 17MM

CES 6 Standard cable entry frame

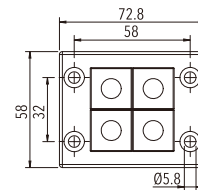
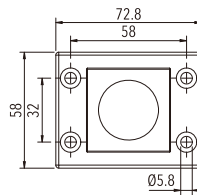

Material: Nylon 66, halogen free
Protection level: IP54/IP65 (with gasket and correct selection of the cable inserts)
Cut-out dimensions: 46x46mm

| Type | Inserts Small/large | Order No. | PU |
|--------|---------------------|-----------|----|
| CES6/1 | Insert Medium | 600101 | 5 |
| CES6/4 | Insert Small | 600102 | 5 |

CES 10 Standard cable entry frame

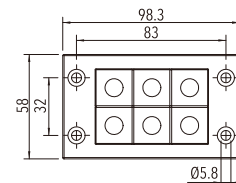
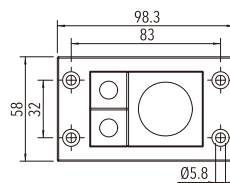

Material: Nylon 66, halogen free
Protection level: IP54/IP65 (with gasket and correct selection of the cable inserts)
Cut-out dimensions: 36x65mm

| Type | Inserts Small/large | Order No. | PU |
|---------|----------------------------|-----------|----|
| CES10/3 | Insert Medium/Insert small | 600103 | 5 |
| CES10/6 | Insert Small | 600104 | 5 |



Material: Nylon 66, halogen free
Protection level: IP54/IP65 (with gasket and correct selection of the cable inserts)
Cut-out dimensions: 36x86mm

CES 16 Standard cable entry frame

UL94-V0 -40 °C +140 °C

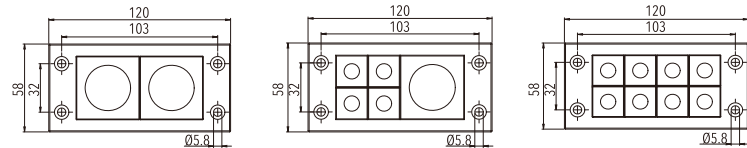

| Type | Inserts Small/large | Order No. | PU |
|----------|----------------------------|-----------|----|
| CES 16/2 | Insert Medium | 600105 | 5 |
| CES 16/5 | Insert Medium/Insert Small | 600106 | 5 |
| CES 16/8 | Insert Small | 600107 | 5 |



Material: Nylon 66, halogen free
Protection level: IP54/IP65 (with gasket and correct selection of the cable inserts)
Cut-out dimensions: 36x112mm

CES 24 Standard cable entry frame

UL94-V0 -40 °C +140 °C

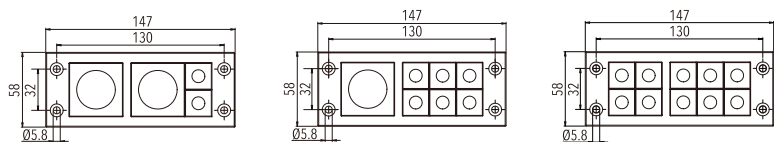

| Type | Inserts Small/large | Order No. | PU |
|-----------|----------------------------|-----------|----|
| CES 24/4 | Insert Medium/Insert Small | 600108 | 5 |
| CES 24/7 | Insert Medium/Insert Small | 600109 | 5 |
| CES 24/10 | Insert Small | 600110 | 5 |



Protection level: IP54/IP65(with gasket and correct selection of the cable inserts)

CES standard snap frame

UL94-V0 -40 °C +140 °C

Used to assemble CES6,10,16,24 series frame, connected with cabinet with screw bolts

| Type | Order No. | PU |
|------------|-----------|----|
| CES SNAP6 | 600111 | 5 |
| CES SNAP10 | 600112 | 5 |
| CES SNAP16 | 600113 | 5 |
| CES SNAP24 | 600114 | 5 |



Frame: polyamide (nylon)
Brush: polyamide (nylon)
Temperature: -20°C-90°C Halogen free, silicon free
Height: 10mm

Standard cable entry frame with brush

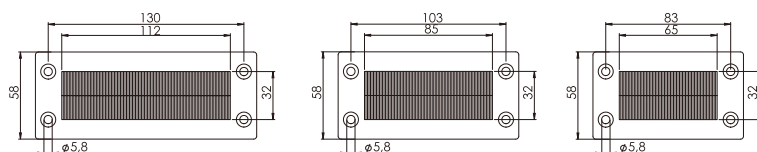

| Type | Cut-out dimensions | Order No. | PU |
|------------|--------------------|-----------|----|
| CES BES/24 | 36x112mm | 600431 | 5 |
| CES BES/16 | 36x86mm | 600432 | 5 |
| CES BES/10 | 36x65mm | 600433 | 5 |

Brush

UL94-V0 -40 +140 °C

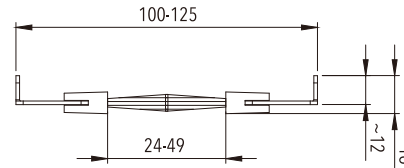
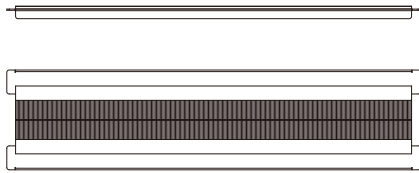

| Type | Control cabinet length | Brush Length | Drilling Length | Order No. | PU |
|------------------|------------------------|--------------|-----------------|-----------|----|
| CES-BES-TS8-600 | 600 | 458mm | 436mm | 600434 | 5 |
| CES-BES-TS8-800 | 800 | 658mm | 636mm | 600435 | 5 |
| CES-BES-TS8-1000 | 1000 | 858mm | 836mm | 600436 | 5 |

Single row cable entry frame

UL94-V0 -40 +140 °C

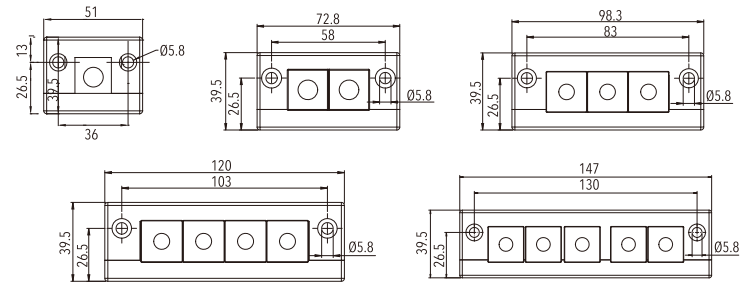

Material: Nylon 66, halogen free

Protection level: IP54/IP65 (with gasket and correct selection of the cable inserts)

Cut-out dimensions: E1: 24x24mm E2: 43x24mm
E3: 65x24mm E4: 86x24mm
E5: 112x24mm

| Type | Inserts Small/large | Order No. | PU |
|--------|---------------------|-----------|----|
| CES E1 | Insert Small | 600437 | 5 |
| CES E2 | Insert Small | 600115 | 5 |
| CES E3 | Insert Small | 600116 | 5 |
| CES E4 | Insert Small | 600117 | 5 |
| CES E5 | Insert Small | 600118 | 5 |

CES ED double row cable entry frame

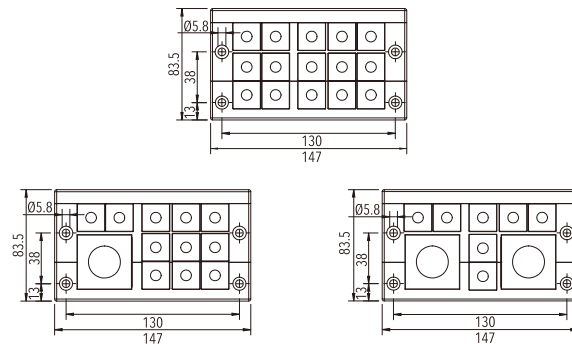

Frame: polyamide (nylon)

Brush: polyamide (nylon)

Temperature: -20°C-90°C Halogen free, silicon free

Cut-out dimensions: 62x112mm

| Type | Inserts Small/large | Order No. | PU |
|--------------|----------------------------|-----------|----|
| CES 24/15-ED | Insert small | 600119 | 5 |
| CES 24/12-ED | Insert Medium/Insert Small | 600120 | 5 |
| CES 24/9-ED | Insert Medium/Insert Small | 600121 | 5 |



Material: Nylon 66, halogen free
Protection level: IP54/IP65 (with gasket and correct selection of the cable inserts)
Cut-out dimensions: 82x112mm

CES ET double row cable entry frame

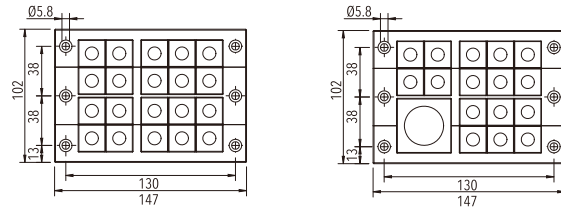

| Type | Inserts Small/large | Order No. | PU |
|--------------|----------------------------|-----------|----|
| CES 24/20-ET | Insert Small | 600122 | 5 |
| CES 24/17-ET | Insert Medium/Insert Small | 600123 | 5 |



Material: Nylon 66, halogen free
Protection level: IP54/IP65 (with gasket and correct selection of the cable inserts)
Cut-out dimensions: 82x112mm

CES ET double row cable entry frame

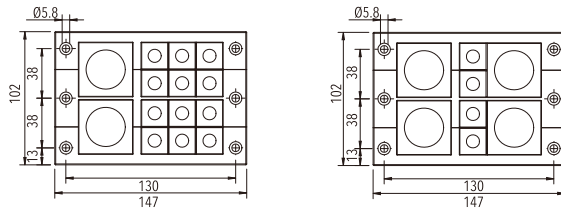

| Type | Inserts Small/large | Order No. | PU |
|--------------|----------------------------|-----------|----|
| CES 24/14-ET | Insert Medium/Insert Small | 600124 | 5 |
| CES 24/8-ET | Insert Medium/Insert Small | 600125 | 5 |



Material: Nylon 66, halogen free
Protection level: IP54/IP65 (with gasket and correct selection of the cable inserts)
Cut-out dimensions: 82x86mm

CES ET double row cable entry frame

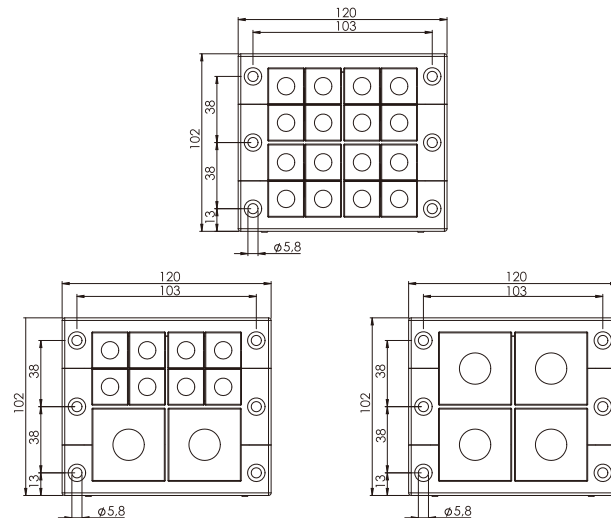

| Type | Inserts Small/large | Order No. | PU |
|--------------|----------------------------|-----------|----|
| CES 16/16-ET | Insert Small | 600438 | 5 |
| CES 16/10-ET | Insert Medium/Insert Small | 600439 | 5 |
| CES 16/4-ET | Insert Medium | 600440 | 5 |



CES ET Triple row cable entry frame

UL94-V0 -40 +140 °C

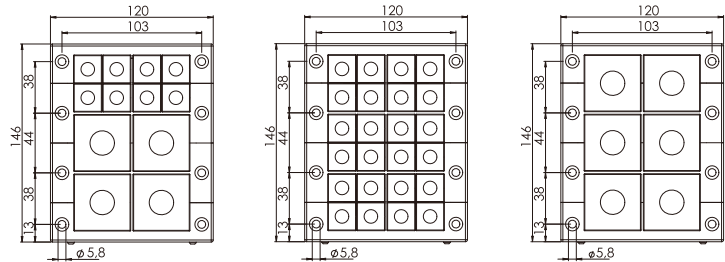

Material: Nylon 66, halogen free
Protection level: IP54/IP65 (with gasket and correct selection of the cable inserts)
Cut-out dimensions: 126x86mm

| Type | Inserts Small/large | Order No. | PU |
|---------------|----------------------------|-----------|----|
| CES 16/24-2ET | Insert Small | 600441 | 5 |
| CES 16/12-2ET | Insert Medium/Insert Small | 600442 | 5 |
| CES 16/6-2ET | Insert Medium | 600443 | 5 |



CES 2ET triple row cable entry frame

UL94-V0 -40 +140 °C

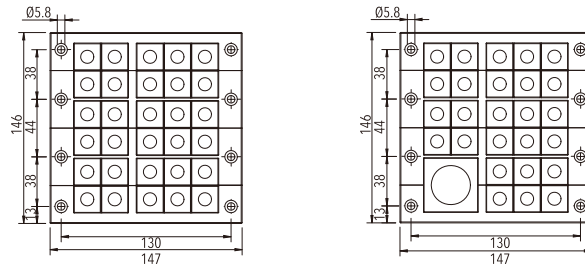

Material: Nylon 66, halogen free
Protection level: IP54/IP65 (with gasket and correct selection of the cable inserts)
Cut-out dimensions: 126x112mm

| Type | Inserts Small/large | Order No. | PU |
|---------------|----------------------------|-----------|----|
| CES 24/30-2ET | Insert small | 600126 | 5 |
| CES 24/27-2ET | Insert Medium/Insert small | 600127 | 5 |

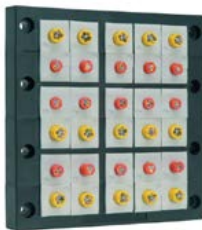

CES 2ET triple row cable entry frame

UL94-V0 -40 +140 °C

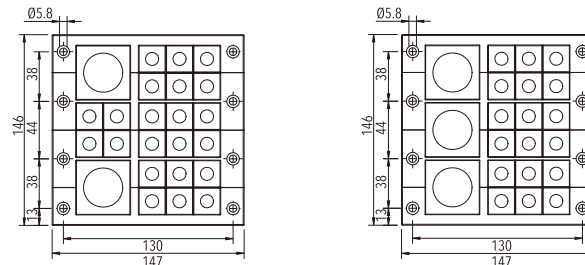

Material: Nylon 66, halogen free
Protection level: IP54/IP65 (with gasket and correct selection of the cable inserts)
Cut-out dimensions: 126x112mm

| Type | Inserts Small/large | Order No. | PU |
|---------------|----------------------------|-----------|----|
| CES 24/24-2ET | Insert Medium/Insert small | 600128 | 5 |
| CES 24/21-2ET | Insert Medium/Insert small | 600129 | 5 |



Material: Nylon 66, halogen free
Protection level: IP54/IP65 (with gasket and correct selection of the cable inserts)
Cut-out dimensions: 126x112mm

FRAME HEIGHT: 35MM

CES 2ET triple row cable entry frame

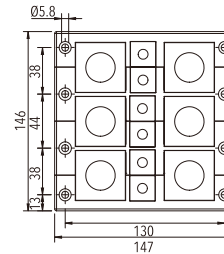

| Type | Inserts Small/large | Order No. | PU |
|---------------|----------------------------|-----------|----|
| CES 24/12-2ET | Insert Medium/Insert Small | 600130 | 5 |



Material: Nylon 66, halogen free
Protection level: IP54/IP65 (with gasket and correct selection of the cable inserts)
Cut-out dimensions: Cable diameter+15-50%
Thickness: 34.5mm

CES 64 Cable entry frame for large conductor

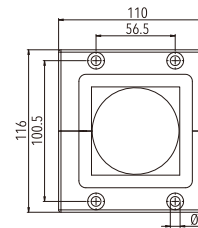

| Type | Inserts Small/large | Order No. | PU |
|----------|---------------------|-----------|----|
| CES 64/1 | Insert large | 6004501 | 5 |



Material: Nylon 66, halogen free
Protection level: IP54/IP65 (with gasket and correct selection of the cable inserts)
Cut-out dimensions: Cable diameter+15-50%
Thickness: 34.5mm

CES 64 Cable entry frame for large conductor

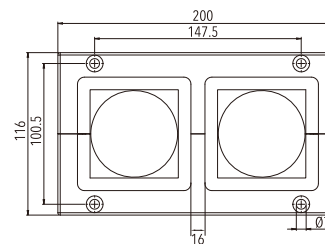

| Type | Inserts Small/large | Order No. | PU |
|----------|---------------------|-----------|----|
| CES 64/2 | Insert large | 6004502 | 5 |

Cable inserts for large Conductor



Inserts for large conductor X: 34-74mm
Material: TPE, halogen free
Color: Grey, Black
Protection level: IP54/IP65 (with gasket and correct selection of the cable inserts)
Flame Class: UL94 V2, V0(Customized)

| Type | Order No.(Grey) | Order No.(Black) | PU |
|-------------|-----------------|------------------|----|
| CES X-(X+1) | 60045X | 60145X | 5 |

FRAME HEIGHT: 17MM



Material: Nylon 66, halogen free
Protection level: IP54/IP65 (with gasket and correct selection of the cable inserts)
Cut-out dimensions: 24x24mm, 43x24mm, 65x24mm

CES NL Cable entry frame for flat conductor

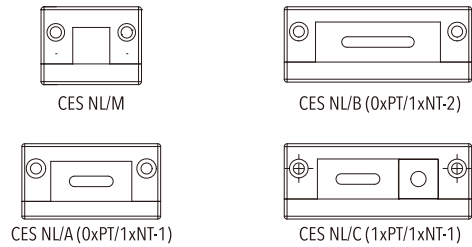

| Type | Order No. | PU |
|------------------------|-----------|----|
| CES NL/M | 600444 | 5 |
| CES NL/A (0xPT/1xNT-1) | 600133 | 5 |
| CES NL/B (0xPT/1xNT-2) | 600134 | 5 |
| CES NL/C (1xPT/1xNT-1) | 600135 | 5 |



Material: Nylon 66, halogen free
Protection level: IP54/IP65 (with gasket and correct selection of the cable inserts)
Cut-out dimensions: 86x24mm

CES NL Cable entry frame for flat conductor

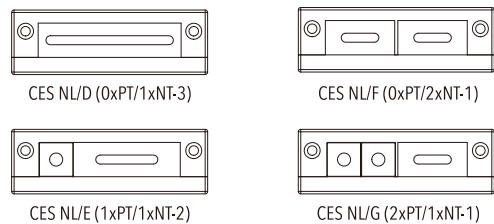

| Type | Order No. | PU |
|------------------------|-----------|----|
| CES NL/D (0xPT/1xNT-3) | 600136 | 5 |
| CES NL/E (1xPT/1xNT-2) | 600137 | 5 |
| CES NL/F (0xPT/2xNT-1) | 600138 | 5 |
| CES NL/G (2xPT/1xNT-1) | 600139 | 5 |



Material: Nylon 66, halogen free
Protection level: IP54/IP65 (with gasket and correct selection of the cable inserts)
Cut-out dimensions: 112x24mm

CES NL Cable entry frame for flat conductor

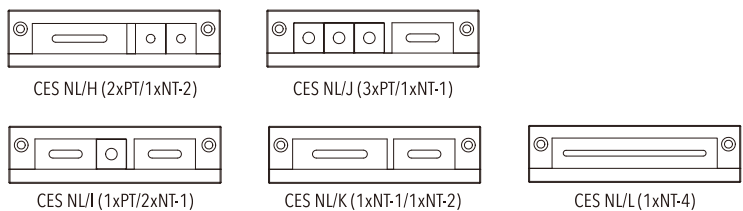

| Type | Order No. | PU |
|--------------------------|-----------|----|
| CES NL/H (2xPT/1xNT-2) | 600140 | 5 |
| CES NL/I (1xPT/2xNT-1) | 600141 | 5 |
| CES NL/J (3xPT/1xNT-1) | 600142 | 5 |
| CES NL/K (1xNT-1/1xNT-2) | 600143 | 5 |
| CES NL/L (1xNT-4) | 600144 | 5 |

Inserts for flat cables

UL94-V0 -40 +140 °C



Material: TPE, halogen free
Color: Light Grey
Protection level: IP54

| Type | Clamping range | Order No. | PU |
|--------|--|-----------|----|
| E1 | adapter inserts | 600445 | 5 |
| FT-1/0 | Blind Inserts | 600446 | 5 |
| FT-1/A | Width: 19.0-23.0mm Thickness5.5-6.0mm | 600447 | 5 |
| FT-1/B | Width: 28.0-33.0mm Thickness5.5-6.0mm | 600448 | 5 |
| FT-1/C | Width: 24.0-30.0mm Thickness8.5-9.0mm | 600449 | 5 |
| FT-1/F | Width: 28.0-33.0mm Thickness9.0-9.5mm | 600450 | 5 |
| FT-2/0 | Blind Inserts | 600451 | 5 |
| FT-2/A | Width: 32.5-38.0mm Thickness5.0-5.5mm | 600452 | 5 |
| FT-2/B | Width: 45.0-50.5mm Thickness6.0-6.5mm | 600453 | 5 |
| FT-2/C | Width: 47.0-52.0mm Thickness9.5-10.0mm | 600454 | 5 |
| FT-3/0 | Blind Inserts | 600455 | 5 |
| FT-3/A | Width: 72.0-77.0mm Thickness5.0-5.5mm | 600456 | 5 |
| FT-4/A | Width: 85.0-99.0mm Thickness4.2-5.2mm | 600457 | 5 |
| FT-4/0 | Blind Inserts | 600458 | 5 |

CES NG bowled angle cable entry frame

UL94-V0 -40 +140 °C

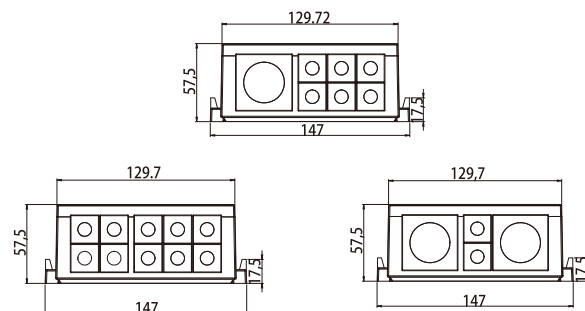

Material: Nylon 66, halogen free
Protection level: IP54/IP65 (with gasket and correct selection of the cable inserts)
Cut-out dimensions: 36x112mm

| Type | Inserts Small/large | Order No. | PU |
|------------|----------------------------|-----------|----|
| CES NG A10 | Insert Small | 600145 | 5 |
| CES NG A7 | Insert Medium/Insert Small | 600146 | 5 |
| CES NG A4 | Insert Medium/Insert Small | 600147 | 5 |

CES NG bowled angle cable entry frame

UL94-V0

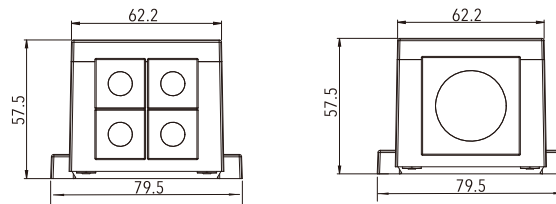

Material: Nylon 66, halogen free
Protection level: IP54/IP65 (with gasket and correct selection of the cable inserts)
Cut-out dimensions: 46x36mm

| Type | Inserts Small/large | Order No. | PU |
|-----------|---------------------|-----------|----|
| CES NG B4 | Insert Small | 600148 | 5 |
| CES NG B1 | Insert Medium | 600149 | 5 |

CES KPF conical cable seal

UL94-V0



Material: TPE, halogen free
Color: Light Grey
Protection level: IP54/IP65 (with gasket and correct selection of the cable inserts)

| Type | Bottom External Diameter | Order No. | PU |
|-------------------|--------------------------|-----------|----|
| CES KPF/M25/3-17 | 39mm | 600163 | 5 |
| CES KPF/M32/6-24 | 46mm | 600164 | 5 |
| CES KPF/M40/11-32 | 54mm | 600165 | 5 |
| CES KPF/M50/17-42 | 64mm | 600166 | 5 |
| CES KPF/M63/23-55 | 77mm | 600167 | 5 |

CES DPF conical cable seal

UL94-V0

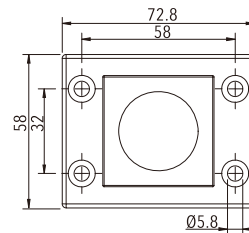

Material: TPE, Nylon 66, halogen free
Color: Light Grey
Protection level: IP54/IP65 (with gasket and correct selection of the cable inserts)

| Type | Order No. | PU |
|---------------|-----------|----|
| CES DPF-C-SET | 600168 | 5 |

CES DPF conical cable seal

UL94-V0

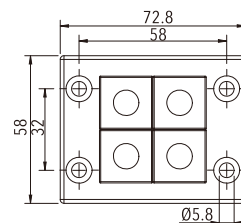

Material: TPE, Nylon 66, halogen free
Color: Light Grey
Protection level: IP54/IP65 (with gasket and correct selection of the cable inserts)

| Type | Order No. | PU |
|----------------|-----------|----|
| CES DPF-4A-SET | 600169 | 5 |

Accessories



| Type | product description | Order No. | PU |
|-----------|---------------------------------|-----------|----|
| CES BP 6 | Blind plate (Zinc-plated steel) | 600181 | 5 |
| CES BP 10 | | 600182 | 5 |
| CES BP 16 | | 600183 | 5 |
| CES BP 24 | | 600184 | 5 |
| RH 800449 | | 600459 | 5 |

CES RVT Split cable glands

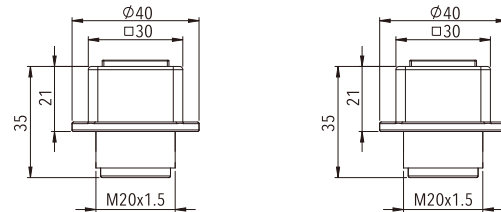

Material: Poly carbonate (PC), halogen free
Color: Light Grey, Black
Protection level: IP54/IP65 (with gasket and correct selection of the cable inserts)

| Type | Inserts Small/large | Order No. | PU |
|-------------|---------------------|-----------|----|
| CES RVT/M20 | Insert Small | 600158 | 5 |
| CES RVT/M25 | Insert Small | 600159 | 5 |

CES RVT Split cable glands

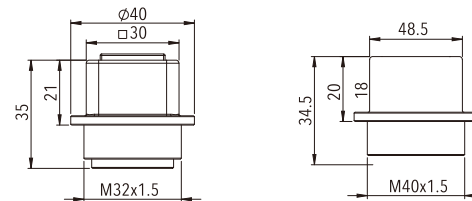

Material: Poly carbonate (PC), halogen free
Color: Light Grey, Black
Protection level: IP54/IP65 (with gasket and correct selection of the cable inserts)

| Type | Inserts Small/large | Order No. | PU |
|---------------|---------------------|-----------|----|
| CES RVT/M32 | Insert Small | 600160 | 5 |
| CES RVT/M40/2 | Insert Small | 600161 | 5 |

CES RVT Split cable glands

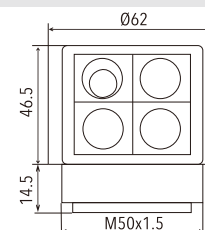

Material: Poly carbonate (PC), halogen free
Color: Light Grey, Black
Protection level: IP54/IP65 (with gasket and correct selection of the cable inserts)

| Type | Inserts Small/large | Order No. | PU |
|---------------|---------------------|-----------|----|
| CES RVT/M50/4 | Insert Small | 600162 | 5 |
| CES RVT/M50/1 | Insert Medium | 600164 | 5 |

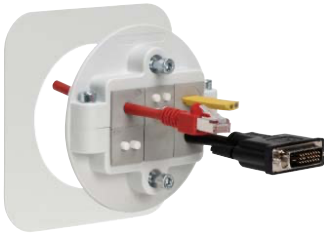

Material: Poly carbonate (PC)
Screw: stainless steel **Color:** Grey
Properties: Halogen-free, silicone-free
Protection level: IP54 (with gasket and correct selection of the cable inserts)
Cut-out dimension: 80mm in diameter

KVT 80 Split Cable Glands

UL94-V0 -30 +100 °C

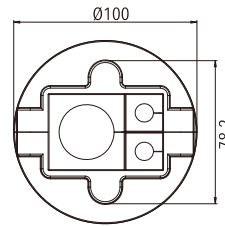

| Type | Inserts Small/large | Order No. | PU |
|--------------|----------------------------|-----------|----|
| CES RVT 80/3 | Insert Medium/Insert Small | 600465 | 1 |



Material: Poly carbonate (PC)
Screw: stainless steel **Color:** Grey
Properties: Halogen-free, silicone-free
Protection level: IP54 (with gasket and correct selection of the cable inserts)
Cut-out dimension: 80mm in diameter

KVT 80 Split Cable Glands

UL94-V0 -30 +100 °C

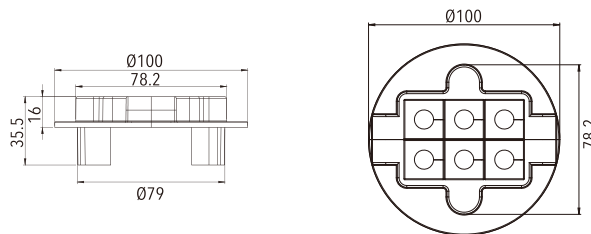

| Type | Inserts Small/large | Order No. | PU |
|--------------|---------------------|-----------|----|
| CES RVT 80/6 | Insert Small | 600466 | 1 |



Material: Poly carbonate (PC), halogen free
Color: Light Grey,Black
Protection level: IP54/IP65 (with gasket and correct selection of the cable inserts)

CES 90 Split Cable Glands

UL94-V0 -30 +100 °C

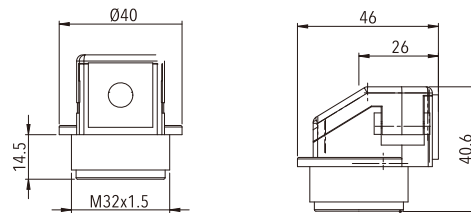

| Type | Inserts Small/large | Order No. | PU |
|----------------|---------------------|-----------|----|
| CES RVT 32-W90 | Insert Small | 600467 | 10 |



Material: Poly carbonate (PC), halogen free
Color: Light Grey,Black
Protection level: IP54/IP65 (with gasket and correct selection of the cable inserts)

CES 90 Split Cable Glands

UL94-V0 -30 +100 °C

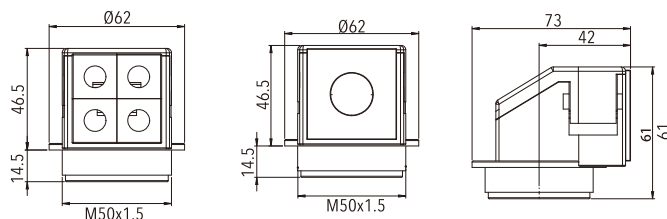

| Type | Inserts Small/large | Order No. | PU |
|------------------|---------------------|-----------|----|
| CES RVT 50/4-W90 | Insert Small | 600468 | 10 |
| CES RVT 50/1-W90 | Insert Medium | 600469 | 10 |



Material: PA6
Protection level: IP54

Split locknut

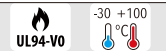

| Type | product description | Order No. | PU |
|-----------|---------------------|-----------|----|
| CES GMT20 | split locknut | 600470 | 10 |
| CES GMT25 | split locknut | 600471 | 10 |
| CES GMT32 | split locknut | 600472 | 10 |
| CES GMT40 | split locknut | 600473 | 10 |
| CES GMT50 | split locknut | 600474 | 10 |



Material: Poly carbonate (PC)
Properties: Halogen-free, silicone-free
Protection level: IP54

CES Bulk head fittings



The 90° angled conduit fitting is for installation of parallel corrugated cable protection conduits, for example in machines, control panels or control cabinets. The liftable cover is tightly fixed by a hinge to the mounting box. The system is therefore very easy to handle. CES-FWS will be offered for corrugated conduits with sizes NW 13, 17, 23, 29, 37 and 50.

CES-FWS Assembly



1. Fix FWS with screws



2. Insert conduit with cables



3. Lock FWS with screws

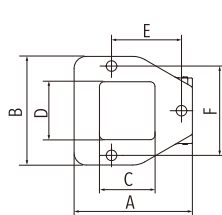

FWS-AD15.8 to 28.5

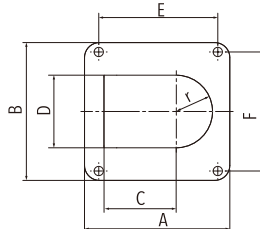

FWS-AD34.5 to 54.5

| Type | Hole Ø(mm) | Size (mm) | Cut-out (CxD)(mm) | Drill. Templ. (E × F)(mm) | Order No. | PU |
|----------------|------------|-------------|-------------------|---------------------------|-----------|----|
| CES FWS-AD15.8 | 3x4.3 | 49x45 | 22x26.5 | 29.0x37.0 | 600475 | 10 |
| CES FWS-AD21.2 | 3x4.3 | 49x45 | 22x26.5 | 29.0x37.0 | 600476 | 10 |
| CES FWS-AD28.5 | 3x4.3 | 67x63 | 37x28 | 41.5x51.5 | 600477 | 10 |
| CES FWS-AD34.5 | 4x6.6 | 85.5x76 | 41.9x40 r=20 | 64.5x64.5 | 600478 | 10 |
| CES FWS-AD42.5 | 4x6.6 | 97x92 | 48.3x48.4 r=24.2 | 79.5x79.5 | 600479 | 5 |
| CES FWS-AD54.5 | 4x6.6 | 111.5x100.5 | 53x60.5 r=30.25 | 87.5x87.5 | 600480 | 5 |

CES ZD Strain relief plates

UL94-V0 -40 +140 °C

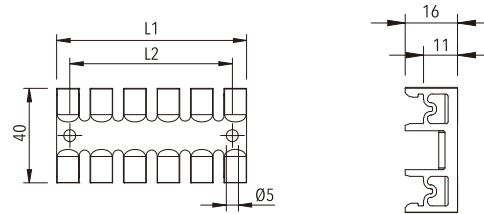
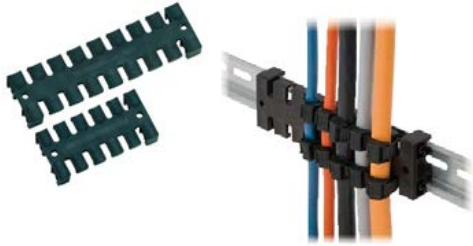

Material: Nylon 66, halogen free

| Type | No. of Teeth | Order No. | PU |
|------------------------------|--------------|-----------|----|
| CES ZD80 (L1: 79, L2: 68) | 6 | 600131 | 10 |
| CES ZD140 (L1: 139, L2: 128) | 9 | 600132 | 10 |

CES ZL Strain relief plates

UL94-V0 -40 +140 °C

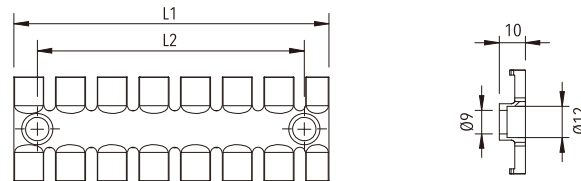

Material: Nylon 66, halogen free

| Type | No. of Teeth | Order No. | PU |
|--------------------------------|--------------|-----------|----|
| CES ZL87 (L1: 86.5, L2: 68) | 6 | 600481 | 10 |
| CES ZL140 (L1: 139.5, L2: 121) | 9 | 600482 | 10 |
| CES ZL180 (L1: 180, L2: 157) | 12 | 600483 | 10 |

CES DH Distance bushings

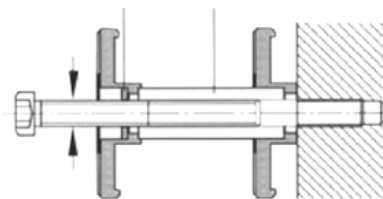
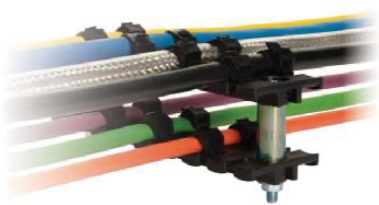

| Type | Length | Outside diameter | Order No. | PU |
|----------|--------|------------------|-----------|----|
| CES DH50 | 50mm | 8mm | 322511 | 10 |



Material: PA6, PE,PP
Color: Light Grey, Black, Dark Grey
Temperature: PA6: -40°C-115°C
 PE: -20°C-80°C PP: -40°C-110°C
Flame Class: UL94 V2/V0 Customized

SFN NRG Split corrugated conduit

| Type | Internal/External Diameter(mm) | Order No. | PU |
|---------------|--------------------------------|-----------|-----|
| SFN NRG-10.0 | 6.5x10.0 | 600499 | 100 |
| SFN NRG-13.0 | 10.0x13.0 | 600500 | 100 |
| SFN NRG-15.8 | 12.0x15.8 | 600501 | 100 |
| SFN NRG-18.5 | 14.3x18.5 | 600502 | 100 |
| SFN NRG-20.0 | 16.0x20.0 | 600503 | 100 |
| SFN NRG-21.2 | 17.0x21.2 | 600504 | 50 |
| SFN NRG-25.0 | 21.0x25.0 | 600505 | 50 |
| SFN NRG-28.5 | 23.0x28.5 | 600506 | 25 |
| SFN NRG-30.0 | 25.0x30.0 | 600507 | 25 |
| SFN NRG-34.5 | 29.0x34.5 | 600508 | 25 |
| SFN NRG-42.5 | 36.0x42.5 | 600509 | 10 |
| SFN NRG-54.5 | 48.0x54.5 | 600510 | 10 |
| SFN NRG-67.2 | 56.3x67.2 | 600511 | 25 |
| SFN NRG-80.0 | 66.5x80.0 | 600512 | 10 |
| SFN NRG-106.0 | 91.0x106.0 | 600513 | 10 |



Material: PA6, PE,PP
Color: Light Grey, Black, Dark Grey
Temperature: PA6: -40°C-115°C
 PE: -20°C-80°C PP: -40°C-110°C
Flame Class: UL94 V2/V0 Customized

SFN NRG Standard corrugated conduit

| Type | Internal/External Diameter(mm) | Order No. | PU |
|---------------|--------------------------------|-----------|-----|
| SFN NRG-10.0 | 6.5x10.0 | 600484 | 100 |
| SFN NRG-13.0 | 10.0x13.0 | 600485 | 100 |
| SFN NRG-15.8 | 12.0x15.8 | 600486 | 100 |
| SFN NRG-18.5 | 14.3x18.5 | 600487 | 100 |
| SFN NRG-20.0 | 16.0x20.0 | 600488 | 100 |
| SFN NRG-21.2 | 17.0x21.2 | 600489 | 50 |
| SFN NRG-25.0 | 21.0x25.0 | 600490 | 50 |
| SFN NRG-28.5 | 23.0x28.5 | 600491 | 25 |
| SFN NRG-30.0 | 25.0x30.0 | 600492 | 25 |
| SFN NRG-34.5 | 29.0x34.5 | 600493 | 25 |
| SFN NRG-42.5 | 36.0x42.5 | 600494 | 10 |
| SFN NRG-54.5 | 48.0x54.5 | 600495 | 10 |
| SFN NRG-67.2 | 56.3x67.2 | 600496 | 25 |
| SFN NRG-80.0 | 66.5x80.0 | 600497 | 10 |
| SFN NRG-106.0 | 91.0x106.0 | 600498 | 10 |



CES Cable ties with hook-and-loop fastener

| Type | Size (mm) | | | Order No. | PU |
|------------------|-----------|----|----|-----------|-----|
| | L | B1 | B2 | | |
| CES LKB 200x7bk | 200 | 13 | 7 | 600514 | 100 |
| CES LKB 200x13bk | 200 | 20 | 13 | 600515 | 100 |



CES Cable ties with hook-and-loop fastener

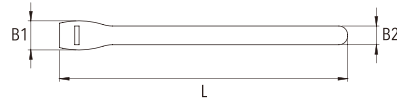

| Type | Size (mm) | | | Order No. | PU |
|------------------|-----------|----|----|-----------|-----|
| | L | B1 | B2 | | |
| CES LKB 230x13bk | 230 | 20 | 13 | 600516 | 100 |
| CES LKB 300x17bk | 300 | 25 | 17 | 600517 | 100 |



Material: Polypropylene + Velour PA
Flame Class: UL94 V0/V2

CES Cable ties with hook-and-loop fastener



| Type | Size (mm) | Order No. | PU |
|-------------|-----------|-----------|----|
| | B2 | | |
| CES LB 7bk | 7 | 600518 | 25 |
| CES LB 10bk | 10 | 600519 | 25 |
| CES LB 15bk | 15 | 600520 | 25 |
| CES LB 20bk | 20 | 600521 | 25 |
| CES LB 25bk | 25 | 600542 | 25 |

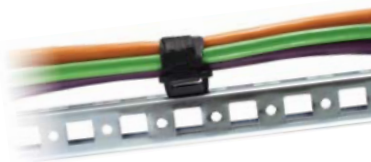

Material: Nylon 66, halogen free

CES Holder for hook-and-loop fastener, screwable

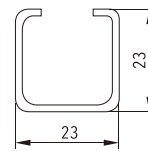
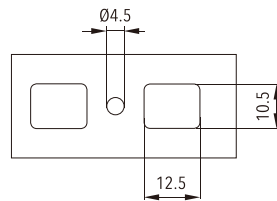

CES BH-R



CES BH-SB

23x23mm Installation Guide

| Type | Fit for LKB/LB | Order No. | PU |
|-----------|----------------------------------|-----------|-----|
| CES BH-R | LKB 200x7/LKB 200x13/LB 10/LB 15 | 600522 | 100 |
| CES BH-SB | LKB 200x7/LB 10 | 600523 | 100 |



CES BH-RBA



CES BH-RBB

CES Holder for hook-and-loop fastener, assemble and KD by turning 90°



Material: Nylon 66, halogen free
Color: Light Grey/Black
Cut-out dimension: RBA:Φ6mm, RBB:Φ6.5mm

| Type | Fit for LKB/LB | Order No. | PU |
|------------|-----------------|-----------|-----|
| CES BH-RBA | LKB 200x7/LB 10 | 600525 | 100 |
| CES BH-RBB | LKB 200x7/LB 10 | 600526 | 100 |



Material: TPE halogen free
Color: Light Grey, Black
Protection level: IP54

CES small



| Type | Clamping range mm | Order No. | | PU |
|-----------|-------------------|-----------|-----------|----|
| | | Grey | Black | |
| CES 2 | 2-3 | 600302 | 601302 | 5 |
| CES 3 | 3-4 | 600303 | 601303 | 5 |
| CES 4 | 4-5 | 600304 | 601304 | 5 |
| CES 5 | 5-6 | 600305 | 601305 | 5 |
| CES 6 | 6-7 | 600306 | 601306 | 5 |
| CES 7 | 7-8 | 600307 | 601307 | 5 |
| CES 8 | 8-9 | 600308 | 601308 | 5 |
| CES 9 | 9-10 | 600309 | 601309 | 5 |
| CES 10 | 10-11 | 600310 | 601310 | 5 |
| CES 11 | 11-12 | 600311 | 601311 | 5 |
| CES 12 | 12-13 | 600312 | 601312 | 5 |
| CES 13 | 13-14 | 600313 | 601313 | 5 |
| CES 14 | 14-15 | 600314 | 601314 | 5 |
| CES 15 | 15-16 | 600315 | 601315 | 5 |
| CES 16(S) | 16-17 | 600316(S) | 601316(S) | 5 |



Material: TPE halogen free
Color: Light Grey, Black
Protection level: IP54

CES medium



| Type | Clamping range mm | Order No. | | PU |
|-----------|-------------------|-----------|-----------|----|
| | | Grey | Black | |
| CES 16(M) | 16-17 | 600316(M) | 601316(M) | 5 |
| CES 17 | 17-18 | 600317 | 601317 | 5 |
| CES 18 | 18-19 | 600318 | 601318 | 5 |
| CES 19 | 19-20 | 600319 | 601319 | 5 |
| CES 20 | 20-21 | 600320 | 601320 | 5 |
| CES 21 | 21-22 | 600321 | 601321 | 5 |
| CES 22 | 22-23 | 600322 | 601322 | 5 |
| CES 23 | 23-24 | 600323 | 601323 | 5 |
| CES 24 | 24-25 | 600324 | 601324 | 5 |
| CES 25 | 25-26 | 600325 | 601325 | 5 |
| CES 26 | 26-27 | 600326 | 601326 | 5 |
| CES 27 | 27-28 | 600327 | 601327 | 5 |
| CES 28 | 28-29 | 600328 | 601328 | 5 |
| CES 29 | 29-30 | 600329 | 601329 | 5 |
| CES 30 | 30-31 | 600330 | 601330 | 5 |
| CES 31 | 31-32 | 600331 | 601331 | 5 |
| CES 32 | 32-33 | 600332 | 601332 | 5 |
| CES 33 | 33-34 | 600333 | 601333 | 5 |



Material: TPE halogen free
Color: Light Grey, Black
Protection level: IP54

CES adapter insert(small)



| Type | Clamping range mm | Order No. | | PU |
|---------|-------------------|-----------|--------|----|
| | | Grey | Black | |
| CES 2/3 | 2xΦ3 | 600334 | 601334 | 5 |
| CES 2/4 | 2xΦ4 | 600335 | 601335 | 5 |
| CES 2/5 | 2xΦ5 | 600336 | 601336 | 5 |
| CES 2/6 | 2xΦ6 | 600337 | 601337 | 5 |
| CES 2/7 | 2xΦ7 | 600338 | 601338 | 5 |
| CES 2/8 | 2xΦ8 | 600339 | 601339 | 5 |
| CES 4/3 | 4xΦ3 | 600340 | 601340 | 5 |
| CES 4/4 | 4xΦ4 | 600341 | 601341 | 5 |
| CES 4/5 | 4xΦ5 | 600342 | 601342 | 5 |
| CES 4/6 | 4xΦ6 | 600343 | 601343 | 5 |



Material: TPE halogen free
Color: Light Grey, Black
Protection level: IP54

Drilling, wide cable range



| Type | Clamping range mm | Size | Order No. | PU |
|----------|-------------------|-----------|-----------|----|
| KTMB 6.5 | 2.5-6.5 | CES small | 600527 | 5 |
| KTMB 7.5 | 4-7.5 | CES small | 600528 | 5 |
| KTMB 10 | 6.5-10 | CES small | 600529 | 5 |
| KTMB 13 | 9.5-13 | CES small | 600530 | 5 |
| KTMB 16 | 13-16 | CES small | 600531 | 5 |



Material: TPE halogen free
Color: Light Grey, Black
Protection level: IP54

Drilling, wide cable range



| Type | Clamping range mm | Size | Order No. | PU |
|-----------|-------------------|-----------|-----------|----|
| CES DPF-A | 3-12 | CES small | 600532 | 5 |



Material: TPE halogen free
Color: Light Grey, Black
Protection level: IP54

CES DT Cable entry inserts



| Type | Clamping range mm | Size | Order No. | PU |
|---------|-------------------|------------|-----------|----|
| KTMB 18 | 13-18 | CES medium | 600533 | 5 |
| KTMB 23 | 18-23 | CES medium | 600534 | 5 |
| KTMB 28 | 23-28 | CES medium | 600535 | 5 |
| KTMB 33 | 28-33 | CES medium | 600536 | 5 |



Material: TPE halogen free
Color: Light Grey, Black
Protection level: IP54

Cable Entry Inserts, multi range



| Type | Clamping range mm | Size | Order No. | PU |
|----------|-------------------|------------|-----------|----|
| KTMB2x18 | 2x13-18 | CES medium | 600537 | 5 |



Material: TPE halogen free
Color: Light Grey, Black
Protection level: IP54

Cable Entry Inserts, multi range



| Type | Clamping range mm | Size | Order No. | PU |
|-----------|-------------------|------------|-----------|----|
| CES DPF-B | 4-18 | CES medium | 600538 | 5 |
| CES DPF-C | 11-23 | CES medium | 600539 | 5 |
| CES DPF-D | 14-26 | CES medium | 600540 | 5 |



Material: TPE halogen free
Color: Light Grey, Black
Protection level: IP54

DT cable entry inserts are designed for routing standard cables (wireless connector)

Cable Entry Inserts, multi range

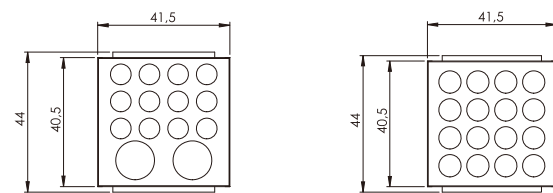

CES DT1

CES DT2

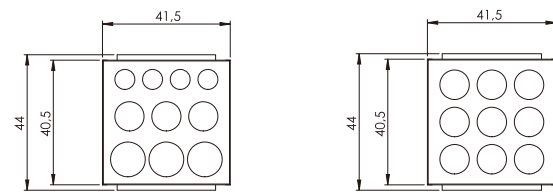

CES DT3

CES DT4

| Type | Cable number | Order No. | PU |
|---------|-------------------------------------|-----------|----|
| CES DT1 | 12x max.6.5mm/2x max.12.2mm | 600460 | 10 |
| CES DT2 | 16x max.7.1mm | 600461 | 10 |
| CES DT3 | 4x max.6.5/3x max.9.5/3x max.11.3mm | 600462 | 10 |
| CES DT4 | 9x max.9.5mm | 600463 | 10 |

CES Conversion template



Material: TPE halogen free
Color: Light Grey, Black
Protection level: IP54

| Type | Size | Order No. | | PU |
|---------|--|-----------|--------|----|
| | | Grey | Black | |
| CES BSA | conversion template from large to small | 600344 | 601344 | 5 |
| CES BSG | solid template small | 600345 | 601345 | 5 |
| CES BBG | solid template medium | 600346 | 601346 | 5 |

CES plugs for sealing



Material: Nylon 66 halogen free
Color: white

| Type | Diameter mm | length mm | Order No. | PU |
|----------|-------------|-----------|-----------|----|
| CES PT2 | 2 | 25 | 600402 | 5 |
| CES PT3 | 3 | 25 | 600403 | 5 |
| CES PT4 | 4 | 25 | 600404 | 5 |
| CES PT5 | 5 | 25 | 600405 | 5 |
| CES PT6 | 6 | 25 | 600406 | 5 |
| CES PT7 | 7 | 25 | 600407 | 5 |
| CES PT8 | 8 | 20 | 600408 | 5 |
| CES PT9 | 9 | 20 | 600409 | 5 |
| CES PT10 | 10 | 20 | 600410 | 5 |
| CES PT11 | 11 | 20 | 600411 | 5 |
| CES PT12 | 12 | 20 | 600412 | 5 |
| CES PT13 | 13 | 20 | 600413 | 5 |
| CES PT14 | 14 | 20 | 600414 | 5 |
| CES PT15 | 15 | 20 | 600415 | 5 |
| CES PT16 | 16 | 20 | 600416 | 5 |
| CES PT17 | 17 | 20 | 600417 | 5 |

Thread Type



ST1



ST3



ST8

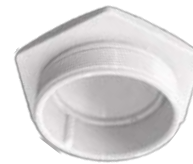

Thread style - bottom

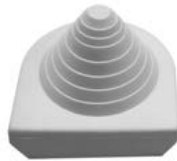

US1



US3



US8

| Model | ST1 | ST3 | ST8 | US1 | US3 | US8 |
|------------------|-----|-----|-----|-----|-----|-----|
| Maximum diameter | 44 | 21 | 13 | 47 | 21 | 13 |
| Number of cables | 1 | 3 | 8 | 1 | 3 | 8 |

DIMENSION (mm)

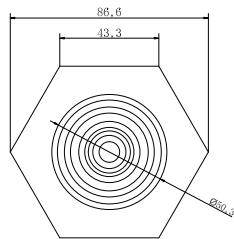

ST1

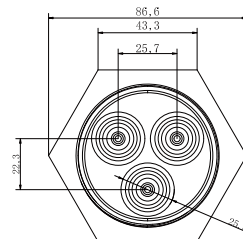

ST3

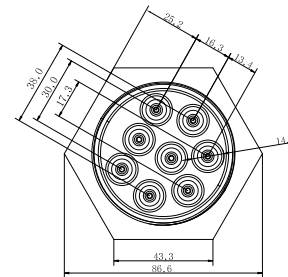

ST8

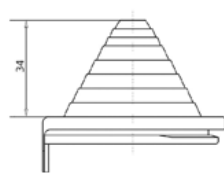
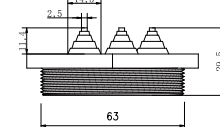
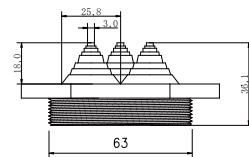
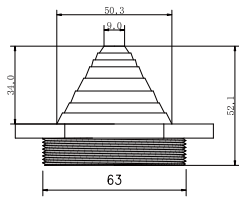

US1

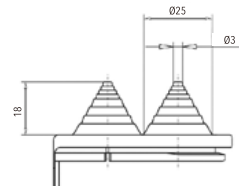

US3

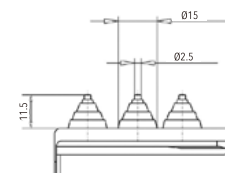

US8

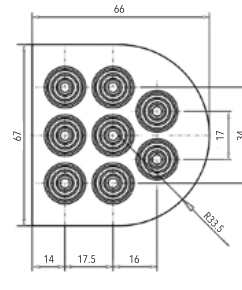
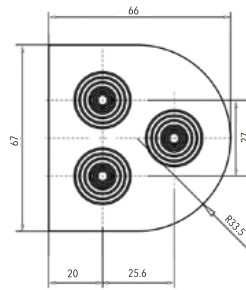
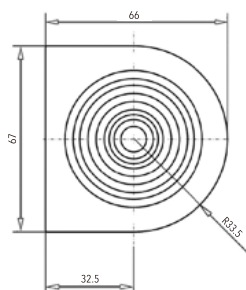

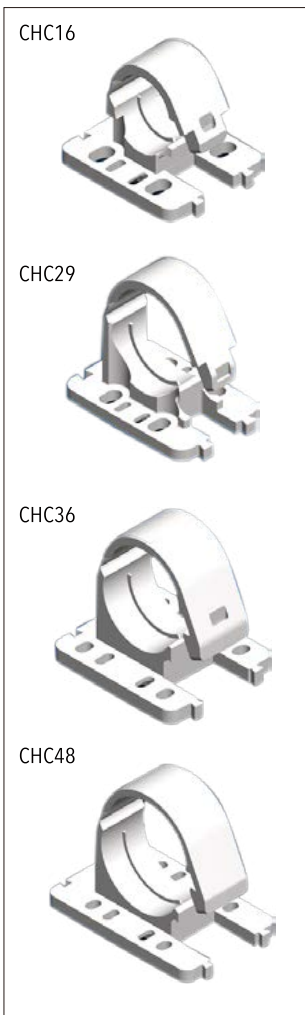

Cable hose clamp

Used for safe and reliable cable laying, such as from control cabinets or from installation boards to doors. The cable hose clamp can be fixed with commercial standard cable hole straps and supports multiple splicing uses. Therefore, the cable can be fixed when entering and exiting the cable hose.

Material:

Cable hose clamp: Polyamide

DIMENSION (mm)

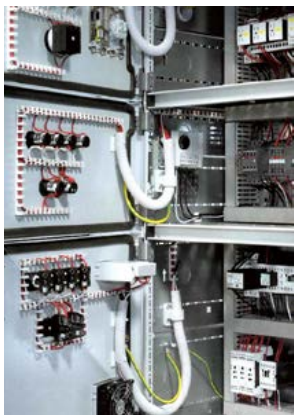
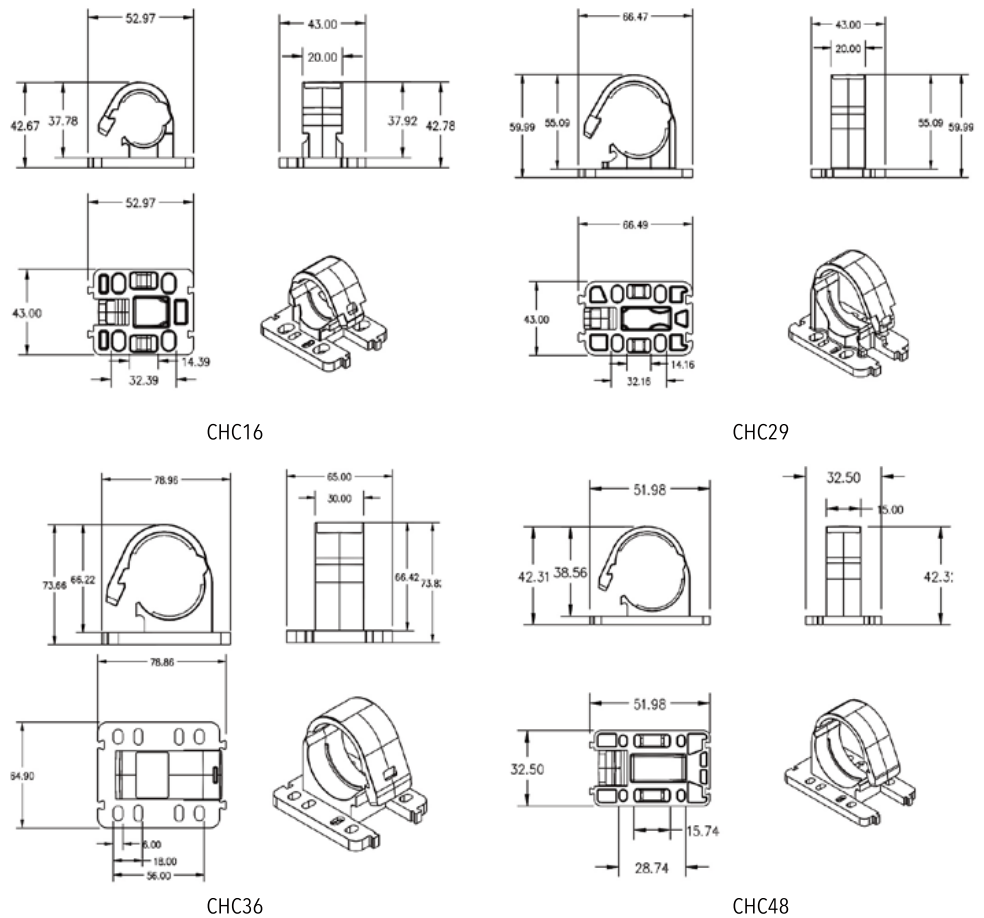

| Model | Used for cable hoses Φ mm |
|-------|--------------------------------|
| CHC16 | 16 |
| CHC29 | 29 |
| CHC36 | 36 |
| CHC48 | 48 |

PVW500.270 SYSTEM WINDOW



For covering display and operating instruments or openings to protect against dirt and liquid intrusion and unauthorized use

Sketch map

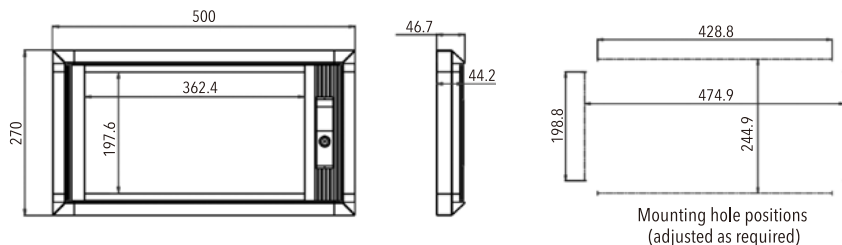

| Cabinet width | Dimension | | Model no |
|---------------|-----------|--------|------------|
| | Width | Length | |
| 600 | 500 | 270 | PVW500.270 |
| | | 370 | PVW500.370 |
| | | 470 | PVW500.470 |
| | | 570 | PVW500.570 |
| | | 670 | PVW500.670 |

| Cabinet width | Dimension | | Model no |
|---------------|-----------|--------|------------|
| | Width | Length | |
| 800 | 700 | 270 | PVW700.270 |
| | | 370 | PVW700.370 |
| | | 470 | PVW700.470 |
| | | 570 | PVW700.570 |
| | | 670 | PVW700.670 |

PTOP500 CABLE ENTRY GLAND

IP65

Protection category IP to IEC 60 529:1P 65 if installed correctly



Sketch map

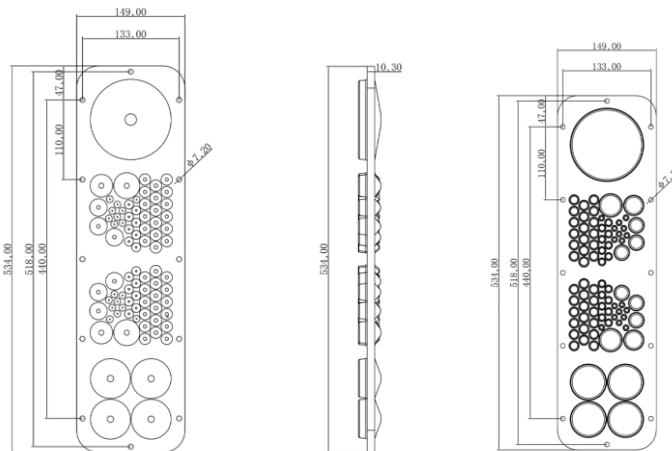

Effect pictures



| Model | PTOP500 | | |
|---|------------------|---------|----------|
| Weight | 0.96kg | | |
| Applicable to | Cabinet type: AE | | |
| IP code | IP 65 | | |
| Number of cable entries and min/max direct (mm) | 18×5-9 | 6-15-24 | 4×26-54 |
| | 16×7-12 | 2×23-30 | 1×50-110 |
| | 36×10-15 | 2×26-35 | |

PTOP750 CABLE ENTRY GLAND

IP65

Protection category IP to IEC 60 529:1P 65 if installed correctly

Sketch map

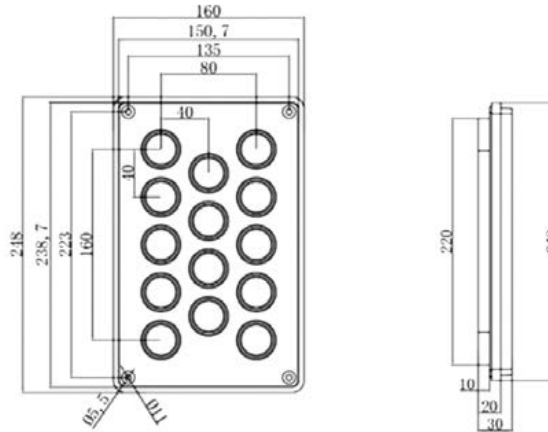

Effect pictures



| | |
|----------------------------|----------------------------|
| Model | PTOP750 |
| Material | Insulating material |
| Insulating material | RAL 7035 |
| Version | 14xM25/32 |
| Packs of | 1 pc(s) |

PTOP760 CABLE ENTRY GLAND

IP65

Protection category IP to IEC 60 529:1P 65 if installed correctly

Sketch map

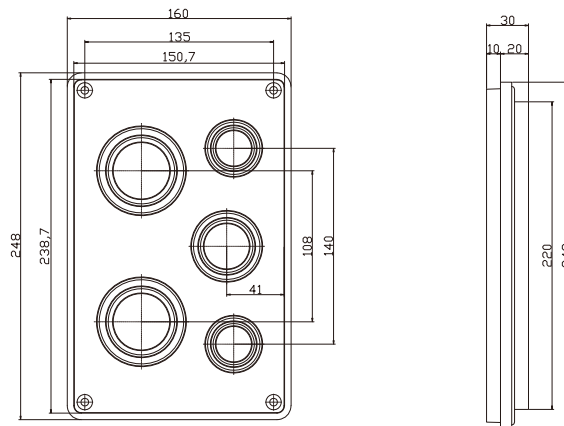

Effect pictures



| | |
|----------------------------|--|
| Model | PTOP760 |
| Material | Insulating material |
| Insulating material | RAL 7035 |
| Version | 2xM25/32/40, 1xM32/40/50, 2xM40/50/63 |
| Packs of | 1 pc(s) |

PTOP760 CABLE ENTRY GLAND

IP65

Protection category IP to IEC 60 529:1P 65 if installed correctly

Sketch map

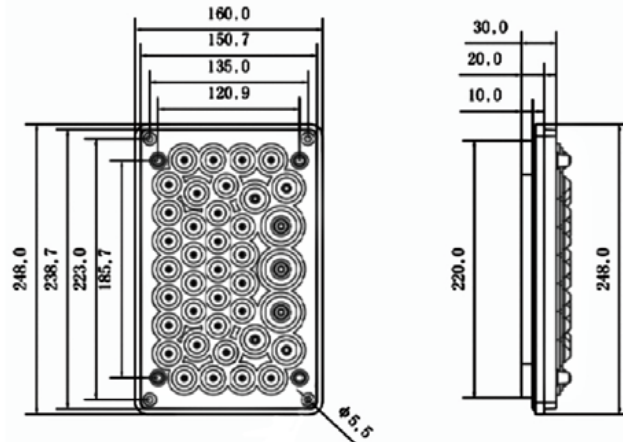

Effect pictures



| | |
|---------------------|------------------------------------|
| Model | PTOP770 |
| Material | Insulating material |
| Insulating material | RAL 7035 |
| Version | 32×Ø7-16mm,4x0 10-20mm,3x0 14-26mm |
| Packs of | 1 pc(s) |

PTOP500 CABLE ENTRY GLAND

IP65

Protection category IP to IEC 60 529:1P 65 if installed correctly

Sketch map

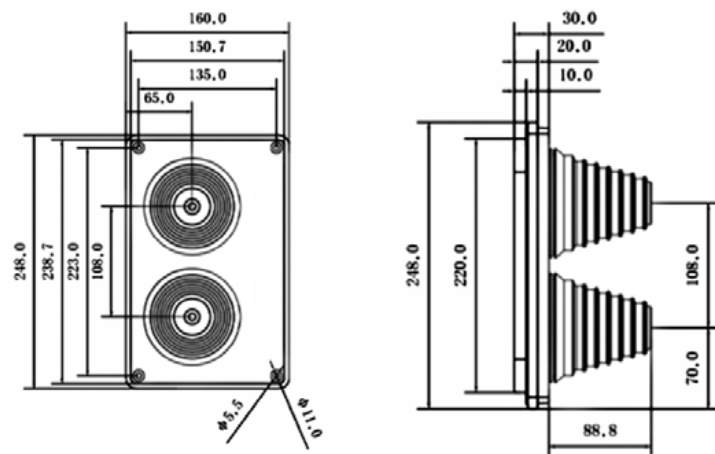

Effect pictures



| | |
|---------------------|---------------------------------|
| Model | PTOP780 |
| Material | Insulating material |
| Insulating material | RAL 7035 |
| Version | With entry fittings up to Ø66mm |
| Packs of | 1 pc(s) |

PTOP785 CABLE ENTRY GLAND

IP65

Protection category IP to IEC 60 529:1P 65 if installed correctly

Sketch map

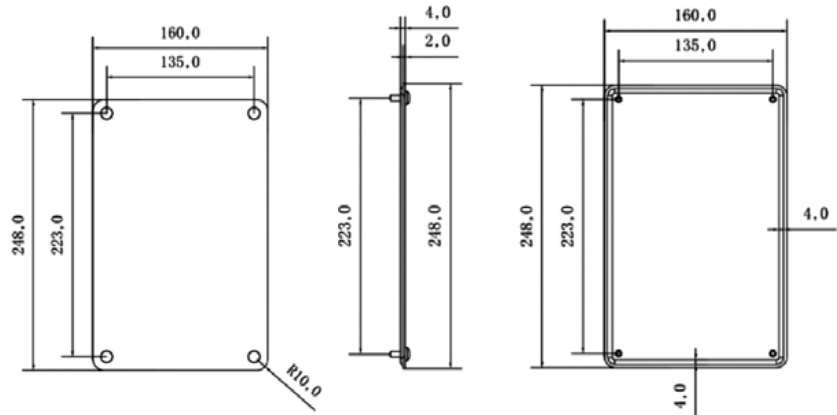

Effect pictures



| Model | PTOP785 |
|---------------------|-----------------------------|
| Material | Sheet steel, spray-finished |
| Insulating material | RAL 7035 |
| Version | Solid |
| Packs of | 1 pc(s) |

EMC
CLAMP SERIES

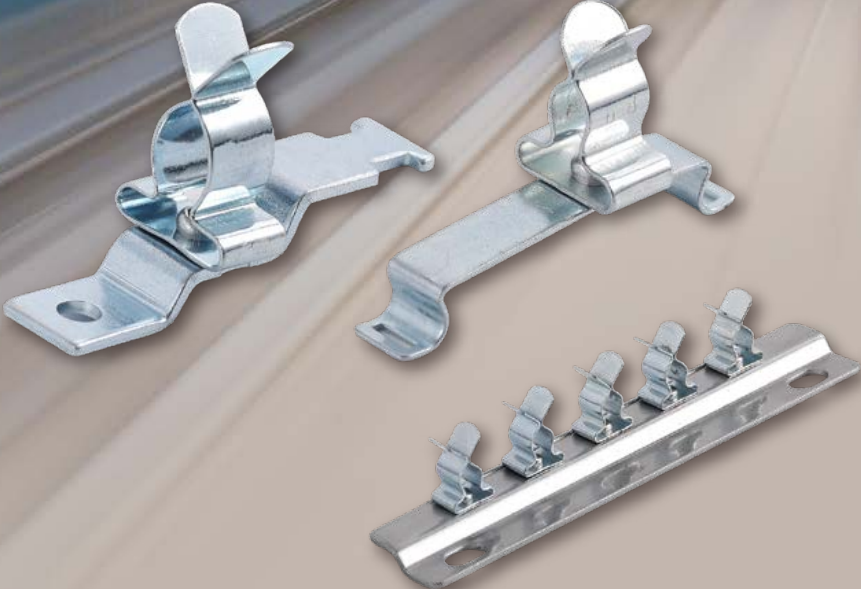

SFZ/SKL EMC
MATERIAL

Spring steel zinc-plated

SF/SFZ-foot Spring steel

The shield clamps SFZ/SKL range are used for shielding single cables in combination with strain relief. Simple to use and effective shielding of cables.

Cables are secured with a cable tie. Strain relief in accordance with VDE standards is achieved.

For assembly on 35 mm DIN rails.

PERFORMANCE

- Simple and tool-free assembly cost effective solution
- Strain relief of the cable with shielding in a single device.
- Optimum contact permanent spring pressure and continuous spring pressure for cable shield layer.
- Cable shielding, no need to adjust the spring load.

| Model No. | Protective diameter |
|--------------|---------------------|
| SFZ/SKL 3-5 | 3.0-5.0mm |
| SFZ/SKL 6-8 | 6.0-8.0mm |
| SFZ/SKL 9-11 | 9.0-11.0mm |

SF/SKL EMC
MATERIAL

Spring steel zinc-plated

SF foot Spring steel

SKL range of protection clip is used to shield single cable.

Easy to use and effective shielding cable.

For assembly on 35 mm DIN rails.

PERFORMANCE

- Optimal contact of the cable shield simple and tool-free assembly.
- Permanent and continuous spring pressure on the cable shield - adjustment of the pressure is not necessary.
- Space saving by an optimized arrangement.
- Cost effective solution.

| Model No. | Protective diameter |
|-------------|---------------------|
| SF/SKL 3-5 | 3.0-5.0mm |
| SF/SKL 6-8 | 6.0-8.0mm |
| SF/SKL 9-11 | 9.0-11.0mm |



LFZ/SKL EMC

MATERIAL

Spring steel zinc-plated

SKL shield clamps can be used for shielding single cables. The shield clamps enable an easy to use and reliable shielding of cables. Cables are secured with a cable tie. Strain relief in accordance with VDE standards is achieved.

Shield clamps are easily attached to mounting plates via screw.

PERFORMANCE

- Comprehensive strain elimination.
- Optimum contact for cable shielding.
- Simple and tool-free assembly.
- Permanent and continuous pressure on the cable shield - no adjustment of the spring load required.
- Higher cost performance.

| Model No. | Protective diameter | Applicable hole |
|--------------|---------------------|-----------------|
| LFZ/SKL 3-5 | 3.0-5.0mm | 4.1mm |
| LFZ/SKL 6-8 | 6.0-8.0mm | 4.1mm |
| LFZ/SKL 9-11 | 9.0-11.0mm | 4.1mm |



LF/SKL EMC

MATERIAL

SKL-clamp: spring steel, zinc-plated.

LF-foot: Steel, zinc-plated zinc-plated.

Fixing hole 4.2 mm for screw M4.

SKL shield clamps can be used for shielding single cables .

The shield clamps enable an easy to use and a reliable shielding of cables.



PERFORMANCE

- Optimum contact for cable shielding.
- Simple and tool-free assembly.
- Permanent and continuous spring load on the cable shield - no adjustment of the spring load required.
- Vibration-proof, maintenance free.
- High packing density because of an optimized arrangement.

| Model No. | Protective diameter | Applicable hole |
|--------------|---------------------|-----------------|
| LF/SKL 1.5-3 | 1.5 - 3.0 mm | 4.2 mm |
| LF/SKL 3-6 | 3.0 - 6.0 mm | 4.2 mm |
| LF/SKL 6-8 | 6.0 - 8.0 mm | 4.2 mm |
| LF/SKL 8-11 | 8.0 - 11 mm | 4.2 mm |
| LF/SKL 12-16 | 12 - 16 mm | 4.2 mm |
| LF/SKL 17-22 | 17 - 22 mm | 4.2 mm |
| LF/SKL 23-29 | 23 - 29 mm | 4.2 mm |

SPS/SKL EMC
MATERIAL

SKL-clamp spring steel, zinc-plated

SPS-foot: spring steel.

PERFORMANCE

- Easy to install to DIN rail 35 mm.
- Simple and no alcohol assembly high density packaging.
- Anti-vibration, maintenance-free cable shielding layer of the best contact.

| Model No. | Protective diameter |
|---------------|---------------------|
| SPS/SKL 1.5-3 | 1.5-3.0mm |
| SPS/SKL 3-6 | 3.0-6.0mm |
| SPS/SKL 6-8 | 6.0-8.0mm |

PF/SKL EMC
MATERIAL

SKL-clamp spring steel, zinc-plated.

PFS-foot: Spring steel.

Bus: copper, tin plated, current load 140A.

Specification: installed on 10x3mm bus.

PERFORMANCE

- Easy installation to bus 10x3mm simple and tool-free assembly.
- High packing density, anti-vibration, maintenance-free cable protective layer of the best contact point.

| Model No. | Protective diameter |
|--------------|---------------------|
| PF/SKL 1.5-3 | 1.5 - 3.0 mm |
| PF/SKL 3-6 | 3.0 - 6.0 mm |
| PF/SKL 6-8 | 6.0 - 8.0 mm |
| PF/SKL 8-11 | 8.0 - 11 mm |
| PF/SKL 12-16 | 12 - 16 mm |
| PF/SKL 17-22 | 17 - 22 mm |
| PF/SKL 23-29 | 23 - 29 mm |



PFZ/SKL EMC

MATERIAL

SKL-clamp spring steel, zinc-plated.

PFS-foot: Spring steel.

Bus: copper, tin plated, current load 140A.

Specification: to fix the cable by tightening 10x3mm busbar mounting cable strap.

PERFORMANCE

- Comprehensive strain elimination.
- Easy installation to busbar 10x3mm simple and tool-free assembly, shockproof, maintenance-free cable shielding for optimal contact.

| Model No. | Protective diameter |
|---------------|---------------------|
| PFZ/SKL 1.5-3 | 1.5-3.0mm |
| PFZ/SKL 3-6 | 3.0-6.0mm |
| PFZ/SKL 6-8 | 6.0-8.0mm |
| PFZ/SKL 8-11 | 8.0-11.0mm |



PFSZ/SKL EMC

MATERIAL

SKL-clamp spring steel, zinc-plated.

PF- foot: spring steel.

Bus: copper, tin plated, current load 140A.

Specification: installed on 10x3mm bus.

PERFORMANCE

- Easy to install to bus 10x3mm simple and toolless assembly with high packing density.
- Shock-proof, maintenance-free cable shielding layer for optimal contact.

| Model No. | Protective diameter |
|----------------|---------------------|
| PFSZ/SKL 1.5-3 | 1.5-3.0mm |
| PFSZ/SKL 3-6 | 3.0-6.0mm |
| PFSZ/SKL 6-8 | 6.0-8.0mm |
| PFSZ/SKL 8-11 | 8.0-11.0mm |



LFZ/SKL EMC

MATERIAL

SKL-clamp Spring steel, zinc-plated.

PF-foot: spring steel.

Specifications: Screw mounting, 4.2mm hole fixing.

PERFORMANCE

- Simple and tool-free assembly with high packing density.
- Shockproof, maintenance-free.
- Optimum contact for cable shielding.

| Model No. | Protective diameter |
|---------------|---------------------|
| LFZ/SKL 1.5-3 | 1.5 - 3.0 mm |
| LFZ/SKL 3-6 | 3.0 - 6.0 mm |
| LFZ/SKL 6-8 | 6.0 - 8.0 mm |
| LFZ/SKL 8-11 | 8.0 - 11 mm |
| LFZ/SKL 12-16 | 12 - 16 mm |
| LFZ/SKL 17-22 | 17 - 22 mm |
| LFZ/SKL 23-29 | 23 - 29 mm |

TW/RL EMC



MATERIAL

SKL-clamp Spring steel, zinc-plated

PF-foot: spring steel.

Busbar: copper, tinned, current load to 140A.

Specifications: install by capturing 10x3mm busbars.

PERFORMANCE

- Easy to install to busbar 10x3mm simplification and tool assembly.
- High packing density.
- The best contact for shockproof, maintenance-free cable shielding.

| Model No. | Protective diameter |
|-------------|---------------------|
| TW/RL 1.5-3 | 1.5-3.0mm |
| TW/RL 3-6 | 3.0-6.0mm |
| TW/RL 6-8 | 6.0-8.0mm |



KLF EMC

MATERIAL

clamp Spring steel, zinc-plated.
Bottom: stainless steel.

PERFORMANCE

- Optimized design for higher mounting density.
- Customization: can be customized according to customer's required size.

DIMENSION (mm)

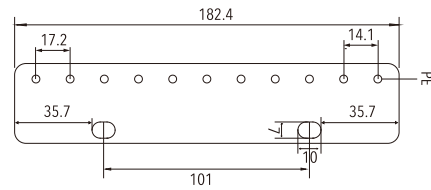

| Model No. | Number of earthing terminals |
|--------------------|------------------------------|
| KLF 10/182.4(3-6) | 10 |
| KLF 10/182.4(6-8) | 10 |
| KLF 10/182.4(8-11) | 10 |



LF/SKL EMC

MATERIAL

Clamp Spring steel, zinc-plated. Bottom: spring steel.
Fixed hole: 4.2mm

PERFORMANCE

- combined stress release.
- The optimal contact area of the cable shield, no need for easy assembly of the tool, permanent and continuous elastic pressure on the cable shield, no need to adjust the pressure, shockproof, maintenance-free for 10x3mm busbar.
- Customization: can be customized according to customer's required size.

| Model No. | Protective diameter |
|--------------|---------------------|
| LF/SKL 1.5-3 | 1.5 - 3.0 mm |
| LF/SKL 3-6 | 3.0 - 6.0 mm |
| LF/SKL 6-8 | 6.0 - 8.0 mm |
| LF/SKL 8-11 | 8.0 - 11 mm |
| LF/SKL 12-16 | 12 - 16 mm |
| LF/SKL 17-22 | 17 - 22 mm |
| LF/SKL 23-29 | 23 - 29 mm |

TW2/RL EMC

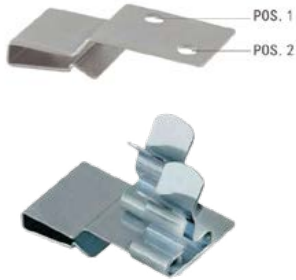

MATERIAL

Clamp Spring steel, zinc-plated. Bottom: spring steel.

PERFORMANCE

- combined stress release.
- The optimal contact area of the cable shield, no need for easy assembly of the tool, permanent and continuous elastic pressure on the cable shield, no need to adjust the pressure, shockproof, maintenance-free for 10x3mm busbar. Customization: can be customized according to customer's required size.

| Model No. | Wire diameter POS.1 | Wire diameter POS.2 |
|---------------|---------------------|---------------------|
| TW2/RL 1.5-3 | 1.5 - 3.0 mm | 1.5 - 3.0 mm |
| TW2/RL 3-6 | 3.0 - 6.0 mm | 3.0 - 6.0 mm |
| TW2/RL 6-8 | 6.0 - 8.0 mm | 6.0 - 8.0 mm |
| TSC2/RL 0306 | 1.5 - 3.0 mm | 3.0 - 6.0 mm |
| TSC2/SKL 0308 | 1.5 - 3.0 mm | 6.0 - 8.0 mm |
| TSC2/SKL 0603 | 3.0 - 6.0 mm | 1.5 - 3.0 mm |
| TSC2/SKL 0608 | 3.0 - 6.0 mm | 6.0 - 8.0 mm |
| TSC2/SKL 0803 | 6.0 - 8.0 mm | 1.5 - 3.0 mm |
| TSC2/SKL 0806 | 6.0 - 8.0 mm | 3.0 - 6.0 mm |

KLF EMC



MATERIAL

clamp Spring steel, zinc-plated. Bottom: stainless steel.

PERFORMANCE

- Advantages: optimized design for higher mounting density.
- Customization: can be customized according to customer's required size.

DIMENSION (mm)

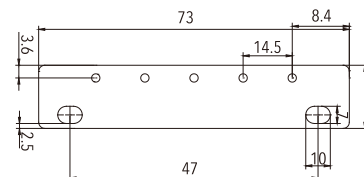
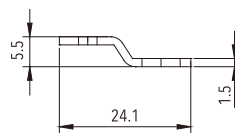

| Model No. | Number of earthing terminals |
|----------------|------------------------------|
| KLF 5/73(3-6) | 5 |
| KLF 5/73(6-8) | 5 |
| KLF 5/73(8-11) | 5 |

KLF EMC



MATERIAL

clamp Spring steel, zinc-plated. Bottom: stainless steel.

ADVANTAGES

- Optimized design for higher mounting density.
- Customization: can be customized according to customer's required size.

DIMENSION (mm)

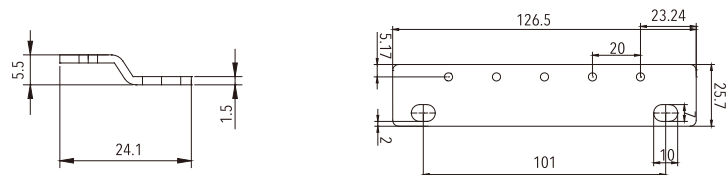

| Model No. | Number of earthing terminals |
|-------------------|------------------------------|
| KLF 5/126.5(3-6) | 5 |
| KLF 5/126.5(6-8) | 5 |
| KLF 5/126.5(8-11) | 5 |



KLF EMC

MATERIAL

clamp Spring steel, zinc-plated. Bottom: stainless steel.

PERFORMANCE

- Optimized design for higher mounting density.
- Customization: can be customized according to customer's required size.

DIMENSION (mm)

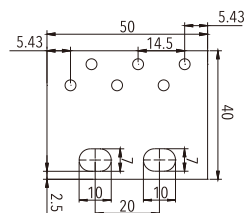

| Model No. | Number of earthing terminals |
|----------------|------------------------------|
| KLF 5/50(3-6) | 6 |
| KLF 5/50(6-8) | 6 |
| KLF 5/50(8-11) | 6 |

LK 2X2-6

| | |
|------------------------|-------|
| Length | 24 mm |
| Width | 15 mm |
| Height | 18 mm |
| Net weight | 9.9 g |
| Minimum cable diameter | 2 mm |
| Maximum cable diameter | 6 mm |

LK 3-8

| | |
|------------------------|-------|
| Length | 26 mm |
| Width | 13 mm |
| Height | 18 mm |
| Net weight | 9 g |
| Minimum cable diameter | 3 mm |
| Maximum cable diameter | 8 mm |

LK 3-8 FM4

| | |
|------------------------|---------|
| Length | 50 mm |
| Width | 14.5 mm |
| Height | 26 mm |
| Net weight | 17.5 g |
| Minimum cable diameter | 3 mm |
| Maximum cable diameter | 8 mm |

LK 4-13.5

| | |
|------------------------|---------|
| Length | 24 mm |
| Width | 15 mm |
| Height | 18 mm |
| Net weight | 15.5 g |
| Minimum cable diameter | 4 mm |
| Maximum cable diameter | 13.5 mm |

LK 4-13.5 FM4

| | |
|------------------------|----------|
| Length | 50.5 mm |
| Width | 20.5 mm |
| Height | 31.5 mm |
| Net weight | 21.941 g |
| Minimum cable diameter | 4 mm |
| Maximum cable diameter | 13.5 mm |



LK 10-20

| | |
|------------------------|----------|
| Length | 40 mm |
| Width | 25 mm |
| Height | 26 mm |
| Net weight | 29.848 g |
| Minimum cable diameter | 10 mm |
| Maximum cable diameter | 20 mm |



LK 10-20 FM4

| | |
|------------------------|---------|
| Length | 50.5 mm |
| Width | 25 mm |
| Height | 40 mm |
| Minimum cable diameter | 10 mm |
| Maximum cable diameter | 20 mm |

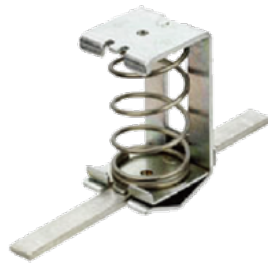

LK 15-32

| | |
|------------------------|--------|
| Length | 64 mm |
| Width | 36 mm |
| Height | 32 mm |
| Net weight | 80.8 g |
| Minimum cable diameter | 15 mm |
| Maximum cable diameter | 32 mm |



LK 15-32 FM4

| | |
|------------------------|---------|
| Length | 50.5 mm |
| Width | 34.5 mm |
| Height | 64 mm |
| Minimum cable diameter | 15 mm |
| Maximum cable diameter | 32 mm |

CABLE GLANDS SERIES

Thread: PG, Metric, G, and NPT thread

Materials: UL approved Nylon PA66 (Flammability UL 94V-2) for A. C. E parts, (Accept to make flammability UL 94V-0); EPDM rubber for B. D parts, (Also accept to make super rubber: resist high temperature rubber, resist strong acid/al-kali, etc).

Protection degree: IP68

Working temperature: -40°C ~ +100°C

Features: The claws and seals of excellent design, sealing nut have a "click" sound and re-open, can hold cable firmly and have a wider cable range. Resistant to salt water, weak acid, alcohol, oil, grease and common solvency.

Colours: Black(RAL9005), gray(RAL7035), other color available upon request.



IP68

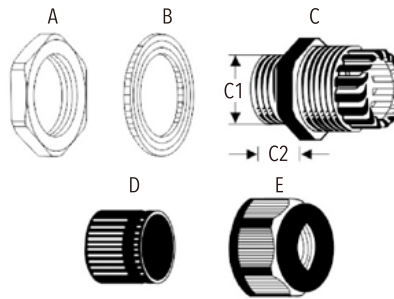

Nylon Cable Glands (Standard type)

| PG Type | PG Thicken Type | Applicable to cable | Thread diameter C1 | Thread length C2 | Wrench diameter |
|---------|-----------------|---------------------|--------------------|------------------|-----------------|
| PG7 | PG7-T | 3~6.5 | 12.5 | 8 | 16 |
| PG9 | PG9-T | 4~8 | 15.2 | 8 | 19 |
| PG11 | PG11-T | 5~10 | 18.6 | 8 | 22 |
| PG13.5 | PG13.5-T | 6~12 | 20.4 | 10 | 24 |
| PG16 | PG16-T | 10~14 | 22.5 | 10 | 27 |
| PG19 | PG19-T | 12~16 | 24 | 10 | 27 |
| PG21 | PG21-T | 13~18 | 28.3 | 10 | 33 |
| PG25 | PG25-T | 16~21 | 30 | 11 | 35 |
| PG29 | PG29-T | 18~25 | 37 | 12 | 42 |
| PG36 | PG36-T | 22~32 | 47 | 14 | 52 |
| PG42 | PG42-T | 32~38 | 54 | 14 | 60 |
| PG48 | PG48-T | 37~44 | 59.3 | 15 | 64 |
| PG63 | PG63-T | 42~50 | 71 | 28 | 77 |

Nylon Cable Glands (Standard type)

| PG Type | PG Thicken Type | Applicable to cable | Thread diameter C1 | Thread length C2 | Wrench diameter |
|---------|-----------------|---------------------|--------------------|------------------|-----------------|
| M12x1.5 | M12x1.5-T | 3~6.5 | 12 | 8 | 16 |
| M16x1.5 | M16x1.5-T | 4~8 | 16 | 8 | 19 |
| M18x1.5 | M18x1.5-T | 5~10 | 18 | 8 | 22 |
| M20x1.5 | M20x1.5-T | 6~12 | 20 | 10 | 24 |
| M22x1.5 | M22x1.5-T | 10~14 | 22 | 10 | 27 |
| M24x1.5 | M24x1.5-T | 12~16 | 24 | 10 | 27 |
| M25x1.5 | M25x1.5-T | 13~18 | 25 | 10 | 33 |
| M27x1.5 | M27x1.5-T | 13~18 | 27 | 10 | 33 |
| M30x1.5 | M30x1.5-T | 16~21 | 30 | 11 | 35 |
| M32x1.5 | M32x1.5-T | 16~21 | 32 | 11 | 35 |
| M36x1.5 | M36x1.5-T | 18~25 | 36 | 12 | 42 |
| M40x1.5 | M40x1.5-T | 22~32 | 40 | 14 | 52 |
| M50x1.5 | M50x1.5-T | 32~38 | 50 | 14 | 60 |
| M63x1.5 | M63x1.5-T | 37~44 | 63 | 15 | 64 |
| M71x1.5 | M71x1.5-T | 42~50 | 71 | 28 | 77 |



Product Overview

Material: Nylon PA66

Protection degree: IP68

Working temperature: -40°C~+100°C

Application: Dust-proof for spare holes

Colours: Black and gray

IP68

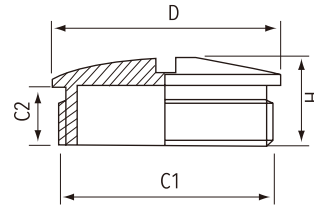

Nylon Screw Plugs PG Type

| PG Type | Thread diameter C1 | Thread length C2 | Main Dimensions H | Cover Dimensions D |
|---------|--------------------|------------------|-------------------|--------------------|
| PG7 | 12.5 | 8.5 | 12.5 | 15 |
| PG9 | 15.2 | 8.5 | 13 | 19 |
| PG11 | 18.6 | 9 | 13 | 22 |
| PG13.5 | 20.4 | 9 | 13 | 25 |
| PG16 | 22.5 | 10.5 | 15 | 27 |
| PG21 | 28.3 | 10.5 | 15.5 | 33 |
| PG29 | 37 | 11.5 | 16 | 44 |
| PG36 | 47 | 13.5 | 18 | 55 |
| PG42 | 54 | 13.5 | 18.5 | 62 |
| PG48 | 59.3 | 14.5 | 19.5 | 68 |

Nylon Screw Plugs M Type

| M Type | Thread diameter C1 | Thread length C2 | Main Dimensions H | Cover Dimensions D |
|---------|--------------------|------------------|-------------------|--------------------|
| M12x1.5 | 12 | 8.5 | 12.5 | 15 |
| M16x1.5 | 16 | 8.5 | 13 | 19 |
| M18x1.5 | 18 | 9 | 13 | 22 |
| M20x1.5 | 20 | 9 | 13 | 25 |
| M22x1.5 | 22 | 10.5 | 15 | 27 |
| M25x1.5 | 25 | 10.5 | 15.5 | 30 |
| M27x1.5 | 27 | 10.5 | 15.5 | 33 |
| M32x1.5 | 32 | 10.5 | 16 | 38 |
| M40x1.5 | 40 | 11.5 | 16 | 46 |
| M50x1.5 | 50 | 13.5 | 18 | 56 |
| M63x1.5 | 63 | 14.5 | 19 | 68 |

IP68



Product Overview

Thread: PG, Metric, G, and NPT thread

Materials: UL approved Nylon PA66 (Flammability) UL 94V-2) for A. C. E parts, (Accept to make flammability UL 94V-0); EPDM rubber for B. D parts, (Also accept to make super rubber: resist high temperature rubber, resist strong acid/alkali, etc).

Protection degree: IP68

Working temperature: -40°C to 100°C

Features: The claws and seals of excellent design, sealing nut have a "click" sound and re-open, can hold cable firmly and have a wider cable range. Resistant to salt water, weak acid, alcohol, oil, grease and common solvency.

Colours: Black(RAL9005), gray(RAL7035), other color available upon request.

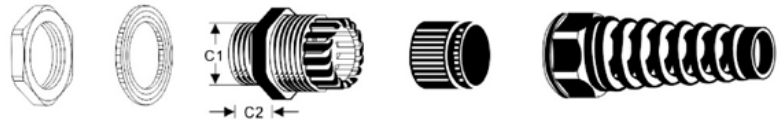

Spiral Cable Glands PG type

| PG Type | Cable Range | Thread diameter C1 | Thread length C2 | Wrench diameter |
|---------|-------------|--------------------|------------------|-----------------|
| PG7 | 3~6.5 | 12.5 | 8 | 16 |
| PG7 | 2~5 | 12.5 | 8 | 16 |
| PG9 | 4~8 | 15.2 | 8 | 19 |
| PG9 | 2~6 | 15.2 | 8 | 19 |
| PG11 | 5~10 | 18.6 | 8 | 22 |
| PG11 | 3~7 | 18.6 | 8 | 22 |
| PG13.5 | 6~12 | 20.4 | 9 | 24 |
| PG13.5 | 5~9 | 20.4 | 9 | 24 |
| PG16 | 10~14 | 22.5 | 10 | 27 |
| PG16 | 7~12 | 22.5 | 10 | 27 |
| PG21 | 13~18 | 28.3 | 10 | 33 |
| PG21 | 9~16 | 28.3 | 10 | 33 |

Spiral Cable Glands M type

| M Type | Cable Range | Thread diameter C1 | Thread length C2 | Wrench diameter |
|---------|-------------|--------------------|------------------|-----------------|
| M12x1.5 | 3~6.5 | 12 | 8 | 16 |
| M12x1.5 | 2~5 | 12 | 8 | 16 |
| M16x1.5 | 4~8 | 16 | 8 | 19 |
| M16x1.5 | 2~6 | 16 | 8 | 19 |
| M18x1.5 | 5~10 | 18 | 8 | 22 |
| M18x1.5 | 3~7 | 18 | 8 | 22 |
| M20x1.5 | 6~12 | 20 | 9 | 24 |
| M20x1.5 | 5~9 | 20 | 9 | 24 |
| M22x1.5 | 10~14 | 22 | 10 | 27 |
| M22x1.5 | 7~12 | 22 | 10 | 27 |
| M25x1.5 | 13~18 | 25 | 10 | 33 |
| M25x1.5 | 9~16 | 25 | 10 | 33 |
| M27x1.5 | 13~18 | 27 | 10 | 33 |
| M27x1.5 | 9~16 | 27 | 10 | 33 |



Product Overview

IP68



Material: Parts A, C, F are made of brass plated with nickel, part D is made of UL approved nylon PA66, parts B and E are made of nitrile butadiene rubber (NBR).

Thread spec.: Metric, PG, G, NPT.

Working temperature: -40°C ~ +100°C, instantaneous heat resistance up to 120°C.

Characteristics: Special design of clamping die and rubber part, large range in clamping the cable, ultrastrong stretching resistance, waterproof, dustproof, and high ability to resist salt, acid, alkali, alcohol, grease and general solvent.

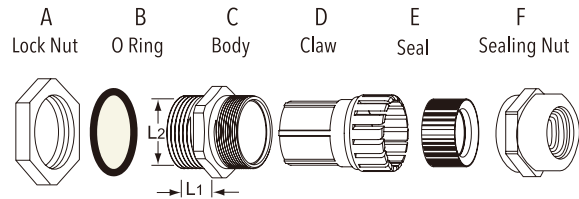

| Model | Thread Size | Cable Range (mm) | Thread O. D. L2 (mm) | Thread Length L1 (mm) | Spanner Size (mm) |
|----------|-------------|------------------|----------------------|-----------------------|-------------------|
| PG7-M | PG7 | 3~6.5 | 12.5 | 5 | 14 |
| PG7-M | PG7 | 2~5 | 12.5 | 5 | 14 |
| PG9-M | PG9 | 5~9 | 15.2 | 6 | 17 |
| PG9-M | PG9 | 2~6 | 15.2 | 6 | 17 |
| PG11-M | PG11 | 6.5~11 | 18.6 | 6 | 20 |
| PG11-M | PG11 | 3~7 | 18.6 | 6 | 20 |
| PG13.5-M | PG13.5 | 7~13 | 20.4 | 6.5 | 22 |
| PG13.5-M | PG13.5 | 5~9 | 20.4 | 6.5 | 22 |
| PG16-M | PG16 | 9~14 | 22.5 | 6.5 | 24 |
| PG16-M | PG16 | 6~12 | 22.5 | 6.5 | 24 |
| PG21-M | PG21 | 11~18 | 28.3 | 7 | 30 |
| PG21-M | PG21 | 9~16 | 28.3 | 7 | 30 |
| PG29-M | PG29 | 18~26 | 37 | 8 | 40 |
| PG29-M | PG29 | 13~20 | 37 | 8 | 40 |
| PG36-M | PG36 | 24~33 | 47 | 9 | 50 |
| PG36-M | PG36 | 20~26 | 47 | 9 | 50 |
| PG42-M | PG42 | 30~39 | 54 | 10 | 58 |
| PG42-M | PG42 | 25~31 | 54 | 10 | 58 |
| PG48-M | PG48 | 34~45 | 59.3 | 10 | 64 |
| PG48-M | PG48 | 29~35 | 59.3 | 10 | 64 |

IP68



Metallic cable gland PG-LM type



| Model | Thread Size | Cable Range (mm) | Thread O. D. L2 (mm) | Thread Length L1 (mm) | Spanner Size (mm) |
|-----------|-------------|------------------|----------------------|-----------------------|-------------------|
| PG7-LM | PG7 | 3~6.5 | 12.5 | 6 | 14 |
| PG7-LM | PG7 | 2~5 | 12.5 | 6 | 14 |
| PG9-LM | PG9 | 4~8 | 15.2 | 7 | 17 |
| PG9-LM | PG9 | 6~10 | 15.2 | 7 | 17 |
| PG11-LM | PG11 | 6.5~11 | 18.6 | 7 | 20 |
| PG11-LM | PG11 | 3~7 | 18.6 | 7 | 20 |
| PG13.5-LM | PG13.5 | 6~12 | 20.4 | 8 | 22 |
| PG13.5-LM | PG13.5 | 5~9 | 20.4 | 8 | 22 |
| PG16-LM | PG16 | 10~14 | 22.5 | 8 | 24 |
| PG16-LM | PG16 | 6~12 | 22.5 | 8 | 24 |
| PG21-LM | PG21 | 11~18 | 28.3 | 8 | 30 |
| PG21-LM | PG21 | 9~16 | 28.3 | 8 | 30 |
| PG29-LM | PG29 | 18~26 | 37 | 9 | 40 |
| PG29-LM | PG29 | 13~20 | 37 | 9 | 40 |
| PG36-LM | PG36 | 25~32 | 47 | 10 | 50 |
| PG36-LM | PG36 | 20~26 | 47 | 10 | 50 |
| PG42-LM | PG42 | 32~38 | 54 | 10 | 58 |
| PG42-LM | PG42 | 25~31 | 54 | 10 | 58 |
| PG48-LM | PG48 | 34~45 | 59.3 | 12 | 64 |
| PG48-LM | PG48 | 37~44 | 59.3 | 12 | 64 |

Metallic cable gland M-M type

| Model | Thread Size | Cable Range (mm) | Thread O. D. L2 (mm) | Thread Length L1 (mm) | Spanner Size (mm) |
|-------|-------------|------------------|----------------------|-----------------------|-------------------|
| M12-M | M12x1.5 | 3~6.5 | 12 | 5 | 14 |
| M14-M | M14x1.5 | 3~6.5 | 14 | 6 | 17 |
| M16-M | M16x1.5 | 4~8 | 16 | 6 | 17 |
| M18-M | M18x1.5 | 6~10 | 18 | 6 | 20 |
| M20-M | M20x1.5 | 8~12 | 20 | 6 | 22 |
| M22-M | M22x1.5 | 10~14 | 22 | 6 | 24 |
| M24-M | M24x1.5 | 9~14 | 24 | 7 | 30 |
| M25-M | M25x1.5 | 9~14 | 25 | 7 | 30 |
| M27-M | M27x1.5(2) | 11~18 | 27 | 7 | 30 |
| M30-M | M30x1.5(2) | 11~18 | 30 | 7 | 37 |
| M32-M | M32x1.5(2) | 15~22 | 32 | 8 | 37 |
| M33-M | M33x1.5(2) | 15~22 | 33 | 8 | 37 |
| M36-M | M36x1.5(2) | 18~25 | 36 | 8 | 42 |
| M40-M | M40x1.5(2) | 18~25 | 40 | 8 | 46 |
| M42-M | M42x1.5(2) | 18~25 | 42 | 9 | 46 |
| M48-M | M48x1.5(2) | 25~32 | 48 | 9 | 52 |
| M50-M | M50x1.5(2) | 33~38 | 50 | 9 | 55 |
| M54-M | M54x1.5(2) | 30~38 | 54 | 12 | 58 |
| M60-M | M60x1.5(2) | 37~44 | 60 | 12 | 68 |
| M63-M | M63x1.5(2) | 37~44 | 63 | 12 | 68 |
| M64-M | M64x1.5(2) | 37~44 | 64 | 12 | 68 |

IP68



Product Overview

Material: Parts A, C, F are made of brass plated with nickel, part D is made of UL approved nylon PA66, parts B and E are made of nitrile butadiene rubber (NBR).

Thread spec.: Metric, PG, G, NPT.

Working temperature: -40°C~ +100°C, instantaneous heat resistance up to 120°C.

Characteristics: Special design of clamping die and rubber part, large range in clamping the cable, ultrastrong stretching resistance, waterproof, dustproof, and high ability to resist salt, acid, alkali, alcohol, grease and general solvent.

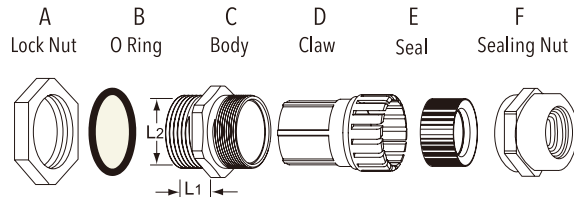

| Model | Thread Size | Cable Range (mm) | Thread O. D. L2 (mm) | Thread Length L1 (mm) | Spanner Size (mm) |
|--------|-------------|------------------|----------------------|-----------------------|-------------------|
| M12-LM | M12x1.5 | 3~6.5 | 12 | 6 | 14 |
| M14-LM | M14x1.5 | 3~6.5 | 14 | 6 | 17 |
| M16-LM | M16x1.5 | 4~8 | 16 | 7 | 17 |
| M18-LM | M18x1.5 | 6~10 | 18 | 7 | 20 |
| M20-LM | M20x1.5 | 8~12 | 20 | 8 | 22 |
| M22-LM | M22x1.5 | 10~14 | 22 | 8 | 24 |
| M24-LM | M24x1.5 | 10~14 | 24 | 8 | 27 |
| M25-LM | M25x1.5 | 10~14 | 25 | 8 | 27 |
| M27-LM | M27x1.5(2) | 13~18 | 27 | 8 | 30 |
| M30-LM | M30x1.5(2) | 13~18 | 30 | 8 | 34 |
| M32-LM | M32x1.5(2) | 15~22 | 32 | 9 | 34 |
| M33-LM | M33x1.5(2) | 15~22 | 33 | 9 | 36 |
| M36-LM | M36x1.5(2) | 18~25 | 36 | 9 | 40 |
| M40-LM | M40x1.5(2) | 22~28 | 40 | 10 | 43 |
| M42-LM | M42x1.5(2) | 22~28 | 42 | 10 | 45 |
| M48-LM | M48x1.5(2) | 25~32 | 48 | 10 | 52 |
| M50-LM | M50x1.5(2) | 25~32 | 50 | 10 | 55 |
| M54-LM | M54x1.5(2) | 30~38 | 54 | 12 | 58 |
| M60-LM | M60x1.5(2) | 37~44 | 60 | 12 | 68 |
| M63-LM | M63x1.5(2) | 37~44 | 63 | 12 | 68 |
| M64-LM | M64x1.5(2) | 37~44 | 64 | 12 | 68 |

IP68



Metallic cable gland NPT-M type



| Model | Thread Size | Cable Range (mm) | Thread O. D. L2 (mm) | Thread Length L1 (mm) | Spanner Size (mm) |
|------------|-------------|------------------|----------------------|-----------------------|-------------------|
| NPT3/8" -M | NPT3/8" | 4~8 | 17.1 | 13 | 18 |
| NPT3/8" -M | NPT3/8" | 2~6 | 17.1 | 13 | 18 |
| NPT1/2" -M | NPT1/2" | 6~12 | 21.3 | 13 | 22 |
| NPT1/2" -M | NPT1/2" | 5~9 | 21.3 | 13 | 22 |
| NPT3/4" -M | NPT3/4" | 13~18 | 26.6 | 15 | 30 |
| NPT3/4" -M | NPT3/4" | 9~16 | 26.6 | 15 | 30 |
| NPT1" -M | NPT1" | 15~22 | 33.5 | 16 | 36 |
| NPT1" -M | NPT1" | 13~20 | 33.5 | 16 | 36 |
| NPT1" -M | NPT1 1/4" | 22~28 | 42 | 18 | 45 |
| NPT1" -M | NPT1 1/4" | 18~25 | 42 | 18 | 45 |
| NPT1" -M | NPT1 1/2" | 25~32 | 48 | 18 | 50 |
| NPT1" -M | NPT1 1/2" | 20~26 | 48 | 18 | 50 |

Metallic cable gland PG-MA type



| Model | Thread Size | Cable Range (mm) | Thread O. D. L2 (mm) | Thread Length L1 (mm) | Spanner Size (mm) |
|-----------|-------------|------------------|----------------------|-----------------------|-------------------|
| PG7-MA | PG7 | 3~6.5 | 12.5 | 6 | 14 |
| PG7-MA | PG7 | 2~5 | 12.5 | 6 | 14 |
| PG9-MA | PG9 | 4~8 | 15.2 | 7 | 17 |
| PG9-MA | PG9 | 2~6 | 15.2 | 7 | 17 |
| PG11-MA | PG11 | 5~10 | 18.6 | 7 | 20 |
| PG11-MA | PG11 | 3~7 | 18.6 | 7 | 20 |
| PG13.5-MA | PG13.5 | 6~12 | 20.4 | 7.5 | 22 |
| PG13.5-MA | PG13.5 | 5~9 | 20.4 | 7.5 | 22 |
| PG16-MA | PG16 | 10~14 | 22.5 | 7.5 | 24 |
| PG16-MA | PG16 | 6~12 | 22.5 | 7.5 | 24 |
| PG21-MA | PG21 | 13~18 | 28.3 | 8 | 30 |
| PG21-MA | PG21 | 9~16 | 28.3 | 8 | 30 |
| PG29-MA | PG29 | 18~25 | 37 | 9 | 40 |
| PG29-MA | PG29 | 13~20 | 37 | 9 | 40 |
| PG36-MA | PG36 | 25~32 | 47 | 9 | 50 |
| PG36-MA | PG36 | 20~26 | 47 | 9 | 50 |
| PG42-MA | PG42 | 32~38 | 54 | 10 | 58 |
| PG42-MA | PG42 | 25~31 | 54 | 10 | 58 |
| PG48-MA | PG48 | 37~44 | 59.3 | 11 | 64 |
| PG48-MA | PG48 | 29~35 | 59.3 | 11 | 64 |



Material: Made of brass plated with nickel.
O-sealing element: Made of nitrile butadiene rubber (NBR).
Working temperature: -40°C~+100°C.

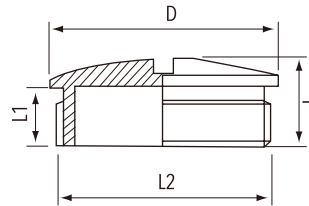

Metallic threaded plug PG-TM type

| Model | Thread Size | Thread O. D. L2 (mm) | Thread Length L1 (mm) | Main body Dimensions L (mm) | Cover Dimensions D (mm) |
|-----------|-------------|----------------------|-----------------------|-----------------------------|-------------------------|
| PG7-TM | PG7 | 12.5 | 5 | 8 | 14 |
| PG9-TM | PG9 | 15.2 | 6 | 9 | 17 |
| PG11-TM | PG11 | 18.6 | 6 | 9 | 20 |
| PG13.5-TM | PG13.5 | 20.4 | 6.5 | 9.5 | 22 |
| PG16-TM | PG16 | 22.5 | 6.5 | 9.5 | 24 |
| PG21-TM | PG21 | 28.3 | 7 | 11 | 30 |
| PG29-TM | PG29 | 37 | 8 | 12 | 40 |
| PG36-TM | PG36 | 47 | 9 | 15 | 50 |
| PG42-TM | PG42 | 54 | 10 | 16 | 60 |
| PG48-TM | PG48 | 59.3 | 10 | 16 | 65 |

Metallic threaded plug M-TM type

| Model | Thread Size | Thread O. D. L2 (mm) | Thread Length L1 (mm) | Main body Dimensions L (mm) | Cover Dimensions D (mm) |
|--------|-------------|----------------------|-----------------------|-----------------------------|-------------------------|
| M12-TM | M12x1.5 | 12 | 5 | 8 | 114 |
| M16-TM | M16x1.5 | 16 | 6 | 9 | 18 |
| M18-TM | M18x1.5 | 18 | 6 | 9 | 20 |
| M20-TM | M20x1.5 | 20 | 6.5 | 9.5 | 22 |
| M22-TM | M22x1.5 | 22 | 6.5 | 9.5 | 25 |
| M25-TM | M25x1.5 | 25 | 7 | 11 | 28 |
| M32-TM | M32x1.5 | 32 | 8 | 12 | 35 |
| M40-TM | M40x1.5 | 40 | 9 | 15 | 44 |
| M50-TM | M50x1.5 | 50 | 10 | 16 | 54 |
| M63-TM | M63x1.5 | 63 | 10 | 16 | 67 |

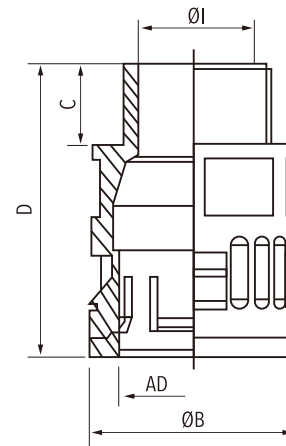

Product Overview

Material: plastic(Pa6).

Temperature: -40°C~+115°C

Colour: Black and grey.

Properties: Rational tubing assembly due to one-piece screw connector with push-in lock. Simple dismounting by displacing the snap-in sleeve. Smallest outer dimensions to be used under confined conditions. Resistant against oil and acids and solvents. Free of silicon, cadmium, halogen. Black connectors are UV-resistant.

Application: For protectively insulated electrical installations.

| Thread | Applicable tubing Outer Ø ADmm | Length of thread Cmm | Smallest inner Ø Imm | Largest outer Ø Bmm | Total length Dmm |
|---------|-----------------------------------|-------------------------|-------------------------|------------------------|---------------------|
| M10x1.5 | 10.0 | 12.0 | 6.0 | 17.0 | 35.0 |
| M12x1.5 | 10.0 | 12.0 | 7.0 | 17.0 | 35.0 |
| M16x1.5 | 13.0 | 12.0 | 7.0 | 20.0 | 37.0 |
| M16x1.5 | 13.0 | 12.0 | 10.0 | 20.0 | 37.0 |
| M16x1.5 | 15.8 | 12.0 | 11.5 | 23.0 | 39.5 |
| M18x1.5 | 15.8 | 12.0 | 12.0 | 23.0 | 39.5 |
| M20x1.5 | 18.5 | 13.0 | 14.5 | 26.0 | 42.0 |
| M20x1.5 | 21.2 | 13.0 | 15.5 | 29.5 | 45.0 |
| M22x1.5 | 21.2 | 13.0 | 17.0 | 29.5 | 45.0 |
| M24x1.5 | 21.2 | 13.0 | 17.0 | 29.5 | 45.0 |
| M25x1.5 | 21.2 | 13.0 | 17.0 | 29.5 | 45.0 |
| M25x1.5 | 25.5 | 13.0 | 20.5 | 34.0 | 46.5 |
| M25x1.5 | 28.5 | 13.0 | 20.5 | 37.0 | 47.0 |
| M27x2.0 | 28.5 | 13.0 | 22.5 | 37.0 | 47.0 |
| M30x1.5 | 28.5 | 13.0 | 23.5 | 37.0 | 47.0 |
| M32x1.5 | 28.5 | 13.0 | 23.5 | 37.0 | 47.0 |

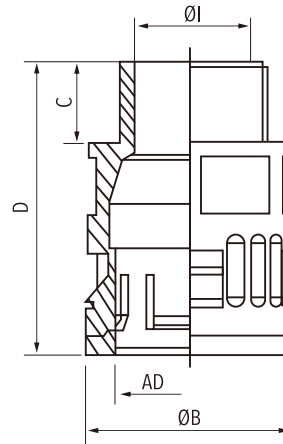

| Thread | Applicable tubing Outer Ø ADmm | Length of thread Cmm | Smallest inner Ø Imm | Largest outer Ø Bmm | Total length Dmm |
|---------|-----------------------------------|-------------------------|-------------------------|------------------------|---------------------|
| M32x1.5 | 34.5 | 15.0 | 26.0 | 44.0 | 51.0 |
| M33x2.0 | 34.5 | 15.0 | 26.0 | 44.0 | 51.0 |
| M36x2.0 | 34.5 | 15.0 | 30.0 | 44.0 | 51.0 |
| M40x1.5 | 34.5 | 15.0 | 30.0 | 44.0 | 51.0 |
| M40x1.5 | 42.5 | 15.0 | 33.0 | 52.0 | 54.0 |
| M42x2.0 | 42.5 | 15.0 | 35.0 | 52.0 | 54.0 |
| M48x2.0 | 42.5 | 15.0 | 36.5 | 52.0 | 54.0 |
| M50x1.5 | 42.5 | 15.0 | 36.5 | 52.0 | 54.0 |
| M50x1.5 | 54.5 | 16.0 | 43.0 | 64.0 | 55.0 |
| M56x2.0 | 54.5 | 16.0 | 48.0 | 64.0 | 55.0 |
| M60x2.0 | 54.5 | 16.0 | 48.0 | 64.0 | 55.0 |
| M63x1.5 | 54.5 | 16.0 | 48.0 | 64.0 | 55.0 |
| PG7 | 10.0 | 12.0 | 7.0 | 17.0 | 35.0 |
| PG9 | 13.0 | 12.0 | 10.0 | 20.0 | 37.0 |
| PG11 | 15.8 | 12.0 | 12.0 | 23.0 | 39.0 |
| PG13.5 | 18.5 | 13.0 | 14.5 | 26.0 | 42.0 |
| PG16 | 21.2 | 13.0 | 17.0 | 29.5 | 45.0 |
| PG21 | 25.5 | 13.0 | 21.0 | 34.0 | 46.5 |
| PG21 | 28.5 | 13.0 | 23.5 | 37.0 | 47.0 |
| PG29 | 34.5 | 15.0 | 30.0 | 44.0 | 51.0 |
| PG36 | 42.5 | 15.0 | 36.5 | 52.0 | 54.0 |
| PG48 | 54.5 | 16.0 | 48.0 | 64.0 | 55.0 |

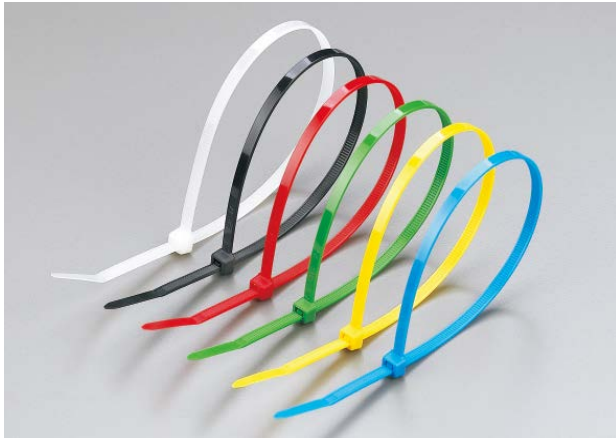

Colours:

- W=White & Natural
- BR=Brown
- OR=Orange
- GN=Green
- PP=Purple
- B=Black
- RD=Red
- YL=Yellow
- BL=Blue
- GY=Gray

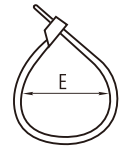
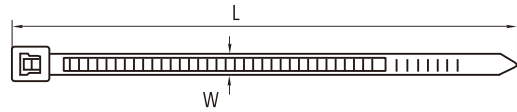

Product Overview

Material: Nylon 66,94V-2 certificated by UL. Acid & erosion control, insulate welland notaptpto age.Heat-resistant,weather- resistant are available.

Operating temperature: -35°C~+85°C.

Colours: Natural(or white, standard color),UV black and other colors are available as requested.

| Item NO. | L | | W (mm) | Max.Bundle Dia.E (mm) | Min.loop Tensile Strength | |
|----------|---------|-----|--------|-----------------------|---------------------------|-----|
| | Inch | mm | | | LBS | KGS |
| LK-3x60 | 2 3/8" | 60 | 2.5 | 11 | 18 | 8 |
| LK-3x80 | 3 3/16" | 80 | 2.5 | 16 | 18 | 8 |
| LK-3x90 | 3 5/8" | 90 | 2.5 | 18 | 18 | 8 |
| LK-3x100 | 4" | 100 | 2.5 | 22 | 18 | 8 |
| LK-3x120 | 4 3/4" | 120 | 2.5 | 28 | 18 | 8 |
| LK-3x140 | 5 1/2" | 140 | 2.5 | 33 | 18 | 8 |
| LK-3x150 | 6" | 150 | 2.5 | 35 | 18 | 8 |
| LK-3x160 | 6 1/4" | 160 | 2.5 | 40 | 18 | 8 |
| LK-3x200 | 8" | 200 | 2.5 | 53 | 18 | 8 |
| LK-3x250 | 10" | 250 | 2.5 | 65 | 18 | 8 |
| LK-4x100 | 4" | 100 | 3.6 | 22 | 40 | 18 |
| LK-4x120 | 4 3/4" | 120 | 3.6 | 30 | 40 | 18 |
| LK-4x140 | 5 1/2" | 140 | 3.6 | 33 | 40 | 18 |
| LK-4x150 | 6" | 150 | 3.6 | 35 | 40 | 18 |
| LK-4x180 | 7" | 180 | 3.6 | 44 | 40 | 18 |
| LK-4x200 | 8" | 200 | 3.6 | 53 | 40 | 18 |
| LK-4x220 | 8 5/8" | 220 | 3.6 | 58 | 40 | 18 |
| LK-4x250 | 10" | 250 | 3.6 | 65 | 40 | 18 |
| LK-4x280 | 11" | 280 | 3.6 | 70 | 40 | 18 |
| LK-4x300 | 11 5/8" | 300 | 3.6 | 80 | 40 | 18 |
| LK-4x370 | 14 1/2" | 370 | 3.6 | 102 | 40 | 18 |
| LK-5x120 | 4 3/4" | 120 | 4.6 | 26 | 50 | 22 |
| LK-5x160 | 6 1/4" | 160 | 4.8 | 39 | 50 | 22 |
| LK-5x180 | 7" | 180 | 4.6 | 46 | 50 | 22 |
| LK-5x190 | 7 1/2" | 190 | 4.6 | 48 | 50 | 22 |

| Item NO. | L | | W (mm) | Max.Bundle Dia.E (mm) | Min.loop Tensile Strength | |
|------------|-----------|------|--------|-----------------------|---------------------------|-----|
| | Inch | mm | | | LBS | KGS |
| LK-5x200 | 8" | 200 | 4.8 | 53 | 50 | 22 |
| LK-5x250 | 10" | 250 | 4.8 | 65 | 50 | 22 |
| LK-5x280 | 11" | 280 | 4.8 | 70 | 50 | 22 |
| LK-5x300 | 11 8/5" | 300 | 4.8 | 82 | 50 | 22 |
| LK-5x350 | 13 3/4" | 350 | 4.8 | 90 | 50 | 22 |
| LK-5x380 | 15" | 380 | 4.8 | 105 | 50 | 22 |
| LK-5x400 | 15 3/4" | 400 | 4.8 | 108 | 50 | 22 |
| LK-5x430 | 17" | 430 | 4.8 | 115 | 50 | 22 |
| LK-5x450 | 17 3/4" | 450 | 4.8 | 130 | 50 | 22 |
| LK-5x500 | 19 11/16" | 500 | 4.8 | 150 | 50 | 22 |
| LK-7x150 | 6" | 150 | 6.8 | 33 | 85 | 38 |
| LK-7x180 | 7" | 180 | 6.8 | 42 | 85 | 38 |
| LK-7x200 | 8" | 200 | 6.8 | 50 | 85 | 38 |
| LK-7x250 | 10" | 250 | 6.8 | 65 | 85 | 38 |
| LK-8x200 | 8" | 200 | 7.6 | 50 | 120 | 55 |
| LK-8x250 | 10" | 250 | 7.6 | 63 | 120 | 55 |
| LK-8x300 | 11 5/8" | 300 | 7.6 | 80 | 120 | 55 |
| LK-8x350 | 13 3/4" | 350 | 7.6 | 90 | 120 | 55 |
| LK-8x370 | 14 1/4" | 370 | 7.6 | 98 | 120 | 55 |
| LK-8x400 | 15 3/4" | 400 | 7.6 | 105 | 120 | 55 |
| LK-8x450 | 17 3/4" | 450 | 7.6 | 125 | 120 | 55 |
| LK-8x500 | 19 11/16" | 500 | 7.6 | 145 | 120 | 55 |
| LK-8x550 | 21 1/16" | 550 | 7.6 | 160 | 120 | 55 |
| LK-8x600 | 23 5/8" | 600 | 7.6 | 170 | 120 | 55 |
| LK-8x650 | 25 9/16" | 650 | 7.6 | 190 | 120 | 55 |
| LK-8x750 | 29 9/16" | 750 | 7.6 | 220 | 120 | 55 |
| LK-9x450 | 17 3/4" | 450 | 9.0 | 120 | 175 | 80 |
| LK-9x530 | 20 3/4" | 530 | 9.0 | 150 | 175 | 80 |
| LK-9x550 | 21 1/16" | 550 | 9.0 | 160 | 175 | 80 |
| LK-9x600 | 23 5/8" | 600 | 9.0 | 170 | 175 | 80 |
| LK-9x650 | 25 9/16" | 650 | 9.0 | 190 | 175 | 80 |
| LK-9x700 | 27 1/2" | 700 | 9.0 | 205 | 175 | 80 |
| LK-9x760 | 30" | 760 | 9.0 | 225 | 175 | 80 |
| LK-9x920 | 36 1/4" | 920 | 9.0 | 265 | 175 | 80 |
| LK-9x1020 | 40 1/6" | 1020 | 9.0 | 295 | 175 | 80 |
| LK-9x1150 | 45 1/4" | 1150 | 9.0 | 310 | 175 | 80 |
| LK-9x1220 | 48" | 1210 | 9.0 | 340 | 175 | 80 |
| LK-9x1350 | 53" | 1350 | 9.0 | 380 | 175 | 80 |
| LK-9x1550 | 61" | 1550 | 9.0 | 470 | 175 | 80 |
| LK-10x450 | 17 3/4" | 450 | 10.0 | 125 | 200 | 91 |
| LK-10x500 | 19 11/16" | 500 | 10.0 | 145 | 200 | 91 |
| LK-12x300 | 11 5/8" | 300 | 12.7 | 80 | 250 | 114 |
| LK-12x400 | 15 3/4" | 400 | 12.7 | 105 | 250 | 114 |
| LK-12x540 | 21 1/4" | 540 | 12.7 | 155 | 250 | 114 |
| LK-12x650 | 25 9/16" | 650 | 12.0 | 190 | 250 | 114 |
| LK-12x750 | 29 9/16" | 750 | 12.0 | 220 | 250 | 114 |
| LK-12x780 | 30 3/4" | 780 | 12.7 | 230 | 250 | 114 |
| LK-13x 540 | 21 1/4" | 540 | 13.0 | 155 | 250 | 114 |

| Item NO. | L | | W (mm) | Max.Bundle Dia.E (mm) | Min.loop Tensile Strength | |
|------------|-----------|-----|--------|-----------------------|---------------------------|-----|
| | Inch | mm | | | LBS | KGS |
| LK-1.8x100 | 4" | 100 | 1.8 | 22 | 14 | 6.5 |
| LK-1.9x120 | 4 3/4" | 120 | 1.9 | 28 | 14 | 6.5 |
| LK-1.9x150 | 6" | 150 | 1.9 | 35 | 14 | 6.5 |
| LK-2.0x200 | 8" | 200 | 2.0 | 50 | 14 | 6.5 |
| LK-2.2x60 | 2 3/8" | 60 | 2.2 | 11 | 18 | 8 |
| LK-2.2x80 | 3 3/16" | 80 | 2.2 | 18 | 18 | 8 |
| LK-2.2x100 | 4" | 100 | 2.2 | 22 | 18 | 8 |
| LK-2.2x120 | 4 3/4" | 120 | 2.2 | 28 | 18 | 8 |
| LK-2.2x150 | 6" | 150 | 2.2 | 35 | 18 | 8 |
| LK-2.2x200 | 8" | 200 | 2.2 | 50 | 18 | 8 |
| LK-2.9x150 | 6" | 150 | 2.9 | 35 | 33 | 15 |
| LK-2.9x200 | 8" | 200 | 2.9 | 50 | 33 | 15 |
| LK-2.7x250 | 10" | 250 | 2.7 | 65 | 33 | 15 |
| LK-2.9x300 | 11 5/8" | 300 | 2.9 | 80 | 33 | 15 |
| LK-3.2x150 | 6" | 150 | 3.2 | 35 | 40 | 18 |
| LK-3.2x180 | 7" | 180 | 3.2 | 42 | 40 | 18 |
| LK-3.2x200 | 8" | 200 | 3.2 | 50 | 40 | 18 |
| LK-3.2x250 | 10" | 250 | 3.2 | 65 | 40 | 18 |
| LK-3.2x300 | 11 5/8" | 300 | 3.2 | 80 | 40 | 18 |
| LK-3.7x350 | 13 3/4" | 350 | 3.7 | 90 | 40 | 18 |
| LK-3.7x400 | 15 3/4" | 400 | 3.7 | 108 | 40 | 18 |
| LK-4.2x180 | 7" | 180 | 4.2 | 42 | 50 | 22 |
| LK-4.2x200 | 8" | 200 | 4.2 | 50 | 50 | 22 |
| LK-4.2x250 | 10" | 250 | 4.2 | 65 | 50 | 22 |
| LK-4.2x300 | 11 5/8" | 300 | 4.2 | 80 | 50 | 22 |
| LK-4.2x350 | 13 3/4" | 350 | 4.2 | 90 | 50 | 22 |
| LK-4.2x380 | 15" | 380 | 4.2 | 102 | 50 | 22 |
| LK-4.2x400 | 15 3/4" | 400 | 4.2 | 105 | 50 | 22 |
| LK-5.2x180 | 7" | 180 | 5.2 | 42 | 65 | 30 |
| LK-5.2x200 | 8" | 200 | 5.2 | 50 | 65 | 30 |
| LK-5.2x250 | 10" | 250 | 5.2 | 65 | 65 | 30 |
| LK-5.2x300 | 11 5/8" | 300 | 5.2 | 80 | 65 | 30 |
| LK-5.5x350 | 13 3/4" | 350 | 5.5 | 90 | 65 | 30 |
| LK-5.5x400 | 15 3/4" | 400 | 5.5 | 105 | 65 | 30 |
| LK-5.5x500 | 19 11/16" | 500 | 5.5 | 150 | 65 | 30 |
| LK-6.0x270 | 10 5/8" | 270 | 6.0 | 65 | 65 | 30 |
| LK-6.5x250 | 10" | 250 | 6.5 | 65 | 85 | 38 |
| LK-6.5x300 | 11 5/8" | 300 | 6.5 | 80 | 85 | 38 |
| LK-6.5x350 | 13 3/4" | 350 | 6.5 | 90 | 85 | 38 |
| LK-6.5x400 | 15 3/4" | 400 | 6.5 | 105 | 85 | 38 |
| LK-6.5x450 | 17 3/4" | 450 | 6.5 | 125 | 85 | 38 |
| LK-6.5x500 | 19 11/16" | 500 | 6.5 | 145 | 85 | 38 |

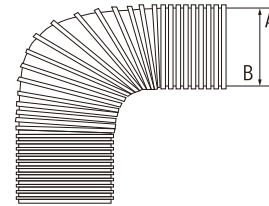
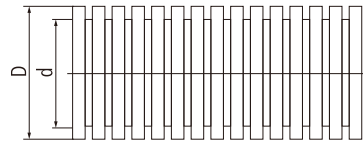

Product Overview

Material: polyamide (PA6)/ polyethylene (PE)/ polypropylene (PP)/ HB according to UL 94.

Temperature: polyamide (PA6)-40°C~+115°C+150°C; polyethylene (PE)-50°C~+80°C+100°C; polypropylene (PP)-40°C~+110°C+130°C

Colours: Black and grey.

Properties: Liquid and Dust proof; Highly resistant to oil, acid and solvents; Free of silicon, cadmium, halogen; Flexible, luster On Surface, abrasion resistant; Racking resistant high mechanical strength; Black tubings are UV-resistant.

Application: For protectively insulated electrical installations.

PA Polyamide corrugated pipe

| Thread | int.x ext.(mm) | Dimensions mm±10% | | Lengths in rings m/roll |
|--------|----------------|-------------------|-------|-------------------------|
| | | Stat | Dyn | |
| AD10.0 | 6.5x10.0 | 14.0 | 35.0 | 100 |
| AD11.6 | 8.00x11.6 | 17.0 | 40.0 | 100 |
| AD13.0 | 9.50x13.0 | 20.0 | 45.0 | 100 |
| AD15.8 | 12.0x15.8 | 27.0 | 55.0 | 100 |
| AD18.5 | 14.3x18.5 | 35.0 | 65.0 | 100 |
| AD21.2 | 17.0x21.2 | 40.0 | 75.0 | 100 |
| AD25.5 | 21.0x25.5 | 43.0 | 85.5 | 100 |
| AD28.5 | 23.0x28.5 | 47.0 | 100.0 | 50 |
| AD34.5 | 29.0x34.5 | 58.0 | 120.0 | 50 |
| AD42.5 | 36.0x42.5 | 69.0 | 150.0 | 50 |
| AD54.5 | 48.0x54.5 | 83.0 | 190.0 | 25 |

PE Polyethylene corrugated pipe

| Thread | int.x ext.(mm) | Dimensions mm±10% | | Lengths in rings m/roll |
|--------|----------------|-------------------|-------|-------------------------|
| | | Stat | Dyn | |
| AD10.0 | 6.5x10.0 | 13.0 | 33.0 | 100 |
| AD11.6 | 8.00x11.6 | 15.0 | 37.0 | 100 |
| AD13.0 | 9.50x13.0 | 18.0 | 41.0 | 100 |
| AD15.8 | 12.0x15.8 | 22.0 | 50.0 | 100 |
| AD18.5 | 14.3x18.5 | 33.0 | 61.0 | 100 |
| AD21.2 | 17.0x21.2 | 38.0 | 72.0 | 100 |
| AD25.5 | 21.0x25.5 | 40.0 | 80.0 | 100 |
| AD28.5 | 23.0x28.5 | 44.0 | 92.0 | 50 |
| AD34.5 | 29.0x34.5 | 53.0 | 113.0 | 50 |
| AD42.5 | 36.0x42.5 | 61.0 | 140.0 | 50 |
| AD54.5 | 48.0x54.5 | 78.0 | 180.0 | 25 |

PP Polypropylene corrugated pipe

| Thread | int.x ext.(mm) | Dimensions mm±10% | | Lengths in rings m/roll |
|--------|----------------|-------------------|-------|-------------------------|
| | | Stat | Dyn | |
| AD10.0 | 6.5x10.0 | 16.0 | 37.0 | 100 |
| AD11.6 | 8.00x11.6 | 18.0 | 43.0 | 100 |
| AD13.0 | 9.50x13.0 | 21.0 | 48.0 | 100 |
| AD15.8 | 12.0x15.8 | 26.0 | 56.0 | 100 |
| AD18.5 | 14.3x18.5 | 37.0 | 70.0 | 100 |
| AD21.2 | 17.0x21.2 | 44.0 | 79.0 | 100 |
| AD25.5 | 21.0x25.5 | 49.0 | 88.0 | 100 |
| AD28.5 | 23.0x28.5 | 52.0 | 104.0 | 50 |
| AD34.5 | 29.0x34.5 | 58.0 | 123.0 | 50 |
| AD42.5 | 36.0x42.5 | 68.0 | 152.0 | 50 |
| AD54.5 | 48.0x54.5 | 84.0 | 193.0 | 25 |

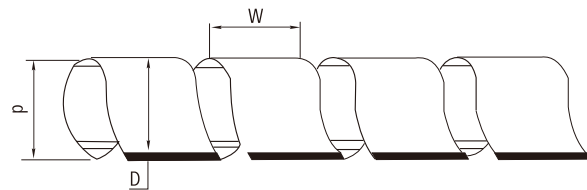

Product Overview

Material: made from PE.

Usage: fix one end with safety belt first, then circle the wires clockwise to make them tighen.

Application: a protection wear for electric wires, and make them insulation and look nice.

| Thread | Inside diameter D(mm) | Outside diameter D(mm) | W.(mm) | Wrapping Range (mm) | Packing |
|--------|-----------------------|------------------------|--------|---------------------|----------|
| SWB-03 | 1.5 | 3.0 | 4.0 | 1.5-10 | 10M/ROLL |
| SWB-06 | 4 | 6 | 7.0 | 4-50 | |
| SWB-08 | 6 | 8 | 10.8 | 6-60 | |
| SWB-10 | 7.5 | 10 | 11.4 | 7.5-60 | |
| SWB-12 | 9 | 12 | 13.9 | 9-65 | |
| SWB-15 | 12 | 15 | 15.0 | 12-75 | |
| SWB-19 | 15 | 19 | 18.2 | 15-100 | |
| SWB-24 | 20 | 24 | 19.6 | 20-130 | |
| SWB-30 | 26 | 30 | 43.0 | 26-150 | |

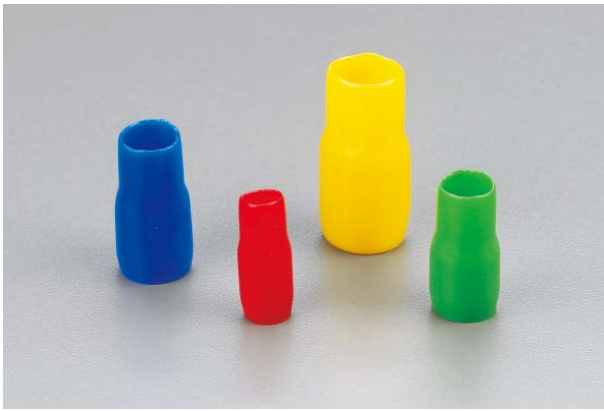

Product Overview

Material: Made from PVC.

Usage: device the colorful cable in machine, used to various terminals as soft feature, easy to take off.

Character: clearly color, shine, soft, insulated.

Color: red white blue yellow,black green, brown available upon special request.

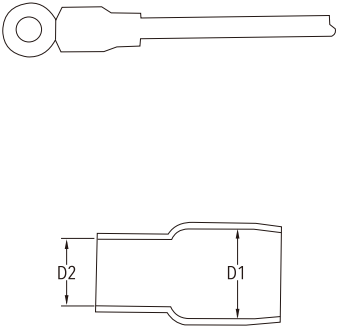
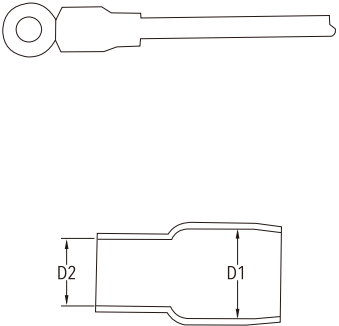
| Item NO. | SQ(mm ²) | Dimension | | Packing | Dimension |
|----------|----------------------|-----------|--------|---------|---|
| | | D1(mm) | D2(mm) | | |
| V-1.25 | 1.25 | 3.3 | 3.1 | 100PCS |  |
| V-2 | 2 | 4.5 | 3.7 | | |
| V-3.5 | 3.5 | 5.7 | 4.1 | | |
| V-5.5 | 5.5 | 5.7 | 5.2 | | |
| V-8 | 8 | 7.2 | 6.2 | | |
| V-14 | 14 | 10.0 | 8.0 | | |
| V-22 | 22 | 12.0 | 9.5 | | |
| V-38 | 38 | 14.0 | 11.8 | | |
| V-60 | 60 | 16.8 | 13.5 | | |
| V-80 | 80 | 19.0 | 16.0 | | |
| V-100 | 100 | 22.0 | 18.0 | 50PCS |  |
| V-125 | 125 | 24.0 | 20.0 | | |
| V-150 | 150 | 24.4 | 22.0 | | |
| V-200 | 200 | 32.0 | 24.0 | 25PCS | |
| V-250 | 250 | 38.0 | 26.5 | | |
| V-325 | 325 | 38.0 | 29.0 | | |
| V-400 | 400 | 44.0 | 37.0 | | |
| V-500 | 500 | 45.0 | 40.4 | | |
| V-630 | 630 | 52.0 | 45.0 | | |



Product Overview

- Function:**
1. wire coat and insulation.
 2. make the joint of terminal block and wire insulated.
 3. divide the colors.
 4. water-proof.
 5. protection and insulation of insistors and electrical capacitors.

Standard color: black, white, red, blue, yellow, green, brown, grey, orange and purple.

| Item NO. | As Supplied | | After Shrinkang | | Packing (m/roll) |
|----------|-------------|---------------|-----------------|---------------|------------------|
| | I.D (mm) | Thickness(mm) | I.D (mm) | Thickness(mm) | |
| DRS-1 | 1.0 | 0.2±0.05 | 0.5 | 0.4±0.05 | 200m/roll |
| DRS-1.5 | 1.5 | 0.2±0.05 | 0.75 | 0.4±0.05 | |
| DRS-2 | 2.0 | 0.25±0.05 | 1.0 | 0.45±0.1 | |
| DRS-2.5 | 2.5 | 0.25±0.05 | 1.25 | 0.45±0.1 | |
| DRS-3 | 3.0 | 0.25±0.05 | 1.5 | 0.45±0.1 | |
| DRS-3.5 | 3.5 | 0.25±0.05 | 1.75 | 0.45±0.1 | |
| DRS-4 | 4.0 | 0.25±0.05 | 2.0 | 0.45±0.1 | |
| DRS-5 | 5.0 | 0.35±0.05 | 2.5 | 0.55±0.1 | |
| DRS-6 | 6.0 | 0.35±0.05 | 3.0 | 0.55±0.1 | |
| DRS-7 | 7.0 | 0.35±0.05 | 3.5 | 0.55±0.1 | |
| DRS-8 | 8.0 | 0.35±0.05 | 4.0 | 0.55±0.1 | |
| DRS-9 | 9.0 | 0.35±0.05 | 4.5 | 0.55±0.1 | |
| DRS-10 | 10.0 | 0.35±0.05 | 5.0 | 0.60±0.1 | |
| DRS-11 | 11.0 | 0.35±0.05 | 5.5 | 0.60±0.1 | |
| DRS-12 | 12.0 | 0.35±0.1 | 6.0 | 0.70±0.1 | |
| DRS-13 | 13.0 | 0.35±0.1 | 6.5 | 0.70±0.1 | |
| DRS-14 | 14.0 | 0.35±0.1 | 7.0 | 0.70±0.1 | |
| DRS-15 | 15.0 | 0.35±0.1 | 7.5 | 0.70±0.1 | |
| DRS-16 | 16.0 | 0.35±0.1 | 8.0 | 0.70±0.1 | |
| DRS-18 | 18.0 | 0.4±0.1 | 9.0 | 0.80±0.1 | |
| DRS-20 | 20.0 | 0.5±0.1 | 10.0 | 0.90±0.1 | |
| DRS-22 | 22.0 | 0.5 ± 0.1 | 11.0 | 0.90±0.1 | |
| DRS-25 | 25.0 | 0.5 ± 0.1 | 12.5 | 0.90±0.1 | |
| DRS-28 | 28.0 | 0.5±0.1 | 14.0 | 0.90±0.1 | |
| DRS-30 | 30.0 | 0.5±0.1 | 15.0 | 1.00±0.2 | |
| DRS-35 | 35.0 | 0.5±0.1 | 17.5 | 1.00±0.2 | |
| DRS-40 | 40.0 | 0.5 ± 0.1 | 20.0 | 1.00 ± 0.2 | |
| DRS-50 | 50.0 | 0.5±0.1 | 25.0 | 1.00±0.2 | |
| DRS-60 | 60.0 | 0.6±0.1 | 30.0 | 1.20±0.2 | |
| DRS-70 | 70.0 | 0.6±0.1 | 35.0 | 1.20±0.2 | |
| DRS-80 | 80.0 | 0.6±0.1 | 40.0 | 1.20±0.2 | |
| DRS-90 | 90.0 | 0.6±0.1 | 45.0 | 1.30±0.2 | |
| DRS-100 | 100.0 | 0.7±0.1 | 50.0 | 1.30±0.2 | |
| DRS-120 | 120 | 0.7±0.1 | 60.0 | 1.30±0.2 | |
| DRS-150 | 150 | 0.8±0.1 | 75.0 | 1.60±0.2 | |

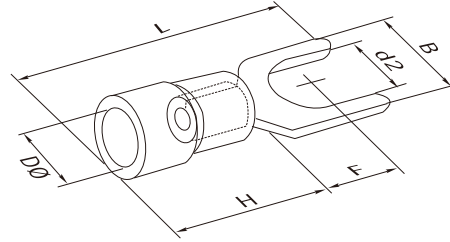

| | Item NO. | USA screw | screw dia. d2(mm) | Dimension | | | | | Color |
|---|-------------|-----------|-------------------|-----------|-------|-------|-------|---------|--------|
| | | | | B(mm) | L(mm) | F(mm) | H(mm) | D Ø(mm) | |
| 0.5~1.5mm ² (22-16) I _{max} =19A | SV1.25-3 | #4 | 3.2 | 5.7 | 21.2 | 6.5 | 10.0 | 4.3 | Red |
| | SVS1.25-3.5 | #6 | 3.7 | 5.7 | 21.2 | 6.5 | | | |
| | SVL1.25-3.5 | #6 | 3.7 | 6.4 | 21.2 | 6.5 | | | |
| | SVS1.25-4 | #8 | 4.3 | 6.4 | 21.2 | 6.5 | | | |
| | SVM1.25-4 | #8 | 4.3 | 7.2 | 21.2 | 6.5 | | | |
| | SVL1.25-4 | #8 | 4.3 | 8.1 | 21.2 | 6.5 | | | |
| | SVS1.25-5 | #10 | 5.3 | 8.1 | 21.2 | 6.5 | | | |
| | SVL1.25-5 | #10 | 5.3 | 9.5 | 21.2 | 6.5 | | | |
| | SVS1.25-6 | 1/4 | 6.5 | 9.5 | 21.2 | 6.5 | | | |
| SVL1.25-6 | 1/4 | 6.5 | 12.0 | 21.2 | 11.0 | | | | |
| 1.5~2.5mm ² (16-14) I _{max} =27A | SV2-3 | #4 | 3.2 | 5.7 | 21.2 | 6.5 | 10.0 | 4.9 | blue |
| | SVS2-3.5 | #6 | 3.7 | 5.7 | 21.2 | 6.5 | | | |
| | SVL2-3.5 | #6 | 3.7 | 6.4 | 21.2 | 6.5 | | | |
| | SVS2-4 | #8 | 4.3 | 6.0 | 21.2 | 6.5 | | | |
| | SVM2-4 | #8 | 4.3 | 7.2 | 21.2 | 6.5 | | | |
| | SVL2-4 | #8 | 4.3 | 8.1 | 21.2 | 6.5 | | | |
| | SVS2-5 | #10 | 5.3 | 8.1 | 21.2 | 6.5 | | | |
| | SVL2-5 | #10 | 5.3 | 9.5 | 21.2 | 6.5 | | | |
| | SVS2-6 | 1/4 | 6.5 | 9.5 | 21.2 | 6.5 | | | |
| SVL2-6 | 1/4 | 6.5 | 12.0 | 21.2 | 11.0 | | | | |
| 2.5~4mm ² (14-12) I _{max} =37A | SV3.5-4 | #8 | 4.3 | 8.0 | 24.8 | 7.0 | 12.5 | 6.2 | black |
| | SV3.5-5 | #10 | 5.3 | 8.0 | 24.8 | 7.0 | | | |
| | SV3.5-6 | 1/4 | 6.5 | 12.0 | 28.0 | 12.1 | | | |
| 4~6mm ² (12-10) I _{max} =48A | SV5.5-3.5 | #6 | 3.7 | 8.3 | 25.2 | 7.5 | 12.5 | 6.7 | yellow |
| | SVS5.5-4 | #8 | 4.3 | 8.3 | 25.2 | 7.5 | | | |
| | SVL5.5-4 | #8 | 4.3 | 9.0 | 23.9 | 7.5 | | | |
| | SV5.5-5 | #10 | 5.3 | 9.0 | 23.9 | 7.5 | | | |
| | SVS5.5-6 | 1/4 | 6.5 | 9.0 | 23.9 | 7.5 | | | |
| | SVL5.5-6 | 1/4 | 6.5 | 12.0 | 31.2 | 12.0 | | | |
| SV5.5-8 | 5/16 | 8.4 | 14.0 | 30.0 | 11.5 | | | | |

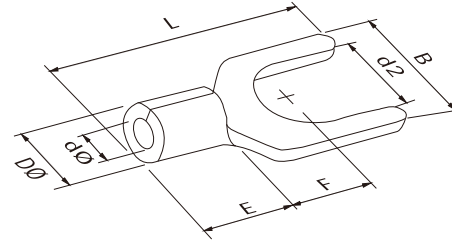

| | Item NO. | USA screw | screw dia. d2(mm) | Dimension | | | | | |
|---|--------------|-----------|----------------------|-----------|-------|-------|---------|---------|---------|
| | | | | B(mm) | L(mm) | F(mm) | E Ø(mm) | D Ø(mm) | d Ø(mm) |
| 0.5~1.5mm ² (22-16) I _{max} =19A | SNB 1.25-3 | #4 | 3.2 | 5.7 | 16.0 | 6.5 | 4.8 | 3.4 | 1.7 |
| | SNBS1.25-3.5 | #6 | 3.7 | 5.7 | 16.0 | 6.5 | | | |
| | SNBL1.25-3.5 | #6 | 3.7 | 6.4 | 16.0 | 6.5 | | | |
| | SNBS1.25-4 | #8 | 4.3 | 6.4 | 16.0 | 6.5 | | | |
| | SNBM1.25-4 | #8 | 4.3 | 7.2 | 16.0 | 6.5 | | | |
| | SNBL1.25-4 | #8 | 4.3 | 8.1 | 16.0 | 6.5 | | | |
| | SNBS1.25-5 | #10 | 5.3 | 8.1 | 16.0 | 6.5 | | | |
| | SNBL1.25-5 | #10 | 5.3 | 9.5 | 16.0 | 6.5 | | | |
| | SNBS1.25-6 | 1/4 | 6.4 | 9.5 | 16.0 | 6.5 | | | |
| SNBL1.25-6 | 1/4 | 6.4 | 12.0 | 22.0 | 11.0 | | | | |
| 1.5~2.5mm ² (16-14) I _{max} =27A | SNB 2-3 | #4 | 3.2 | 5.7 | 16.0 | 6.5 | 4.8 | 4.1 | 2.3 |
| | SNBS 2-3.5 | #6 | 3.7 | 5.7 | 16.0 | 6.5 | | | |
| | SNBL2-3.5 | #6 | 3.7 | 6.4 | 16.0 | 6.5 | | | |
| | SNBS 2-4 | #8 | 4.3 | 6.4 | 16.0 | 6.5 | | | |
| | SNBM2-4 | #8 | 4.3 | 7.2 | 16.0 | 6.5 | | | |
| | SNBL 2-4 | #8 | 4.3 | 8.1 | 16.0 | 6.5 | | | |
| | SNBS 2-5 | #10 | 5.3 | 8.1 | 16.0 | 6.5 | | | |
| | SNBL 2-5 | #10 | 5.3 | 9.5 | 16.0 | 6.5 | | | |
| | SNBS 2-6 | 1/4 | 6.4 | 9.5 | 16.0 | 6.5 | | | |
| SNBL 2-6 | 1/4 | 6.4 | 12.0 | 22.0 | 11.0 | | | | |
| 2.5~4mm ² (14-12) I _{max} =37A | SNB 3.5-3 | #4 | 3.2 | 5.7 | 18.3 | 7.0 | 6.0 | 5.0 | 3.0 |
| | SNB 3.5-4 | #8 | 4.3 | 8.0 | 18.3 | 7.0 | | | |
| | SNB 3.5-5 | #10 | 5.3 | 8.0 | 18.3 | 7.0 | | | |
| | SNB 3.5-6 | 1/4 | 6.4 | 12.0 | 21.5 | 12.1 | | | |
| 4~6mm ² (12-10) I _{max} =48A | SNB 5.5-3.5 | #8 | 3.7 | 8.3 | 19.5 | 7.5 | 6.8 | 5.6 | 3.4 |
| | SNBS 5.5-4 | #10 | 4.3 | 8.3 | 19.5 | 7.5 | | | |
| | SNBL 5.5-4 | #8 | 4.3 | 9.0 | 19.5 | 7.5 | | | |
| | SNB 5.5-5 | #10 | 5.3 | 9.0 | 19.5 | 7.5 | | | |
| | SNBS 5.5-6 | 1/4 | 6.4 | 9.0 | 19.5 | 7.5 | | | |
| | SNBL5.5-6 | 1/4 | 6.4 | 12.0 | 25.5 | 12.0 | | | |
| 6~10mm ² (8) I _{max} =62A | SNB 8-4 | #8 | 4.3 | 8.7 | 23.0 | 6.0 | 8.5 | 7.2 | 4.5 |
| | SNB8-5 | #10 | 5.3 | 12.0 | 24.5 | 5.7 | 8.5 | 7.2 | 4.5 |
| | SNB8-6 | 1/4 | 6.4 | 12.0 | 24.5 | 5.7 | 8.5 | 7.2 | 4.5 |
| | SNB8-8 | 5/16 | 8.4 | 14.5 | 28.0 | 8.3 | 8.5 | 7.2 | 4.5 |
| | SNB14-6 | 1/4 | 6.4 | 12.0 | 28.0 | 7.5 | 10.5 | 9.0 | 5.8 |
| | SNB14-8 | 5/16 | 8.4 | 14.0 | 28.0 | 7.5 | 10.5 | 9.0 | 5.8 |
| | SNB22-8 | 5/16 | 8.4 | 14.0 | 34.5 | 9.0 | 12.0 | 11.5 | 7.7 |

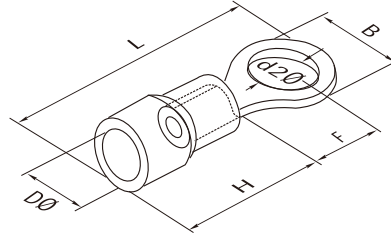

| | Item NO. | USA screw | screw dia. d2 (mm) | Dimension | | | | | Color |
|---|-------------|-----------|-----------------------|-----------|--------|--------|--------|---------|--------|
| | | | | B (mm) | L (mm) | F (mm) | H (mm) | DØ (mm) | |
| 0.5~1.5mm ² (22-16) I _{max} =19A | RV1.25-3 | #4 | 3.2 | 5.7 | 17.8 | 4.95 | 10.0 | 4.3 | Red |
| | RVS1.25-3.5 | #6 | 3.7 | 5.7 | 17.8 | 4.95 | | | |
| | RVM1.25-3.5 | #6 | 3.7 | 6.6 | 20.1 | 6.3 | | | |
| | RVL1.25-3.5 | #6 | 3.7 | 8.0 | 21.5 | 7.0 | | | |
| | RVS1.25-4 | #8 | 4.3 | 6.6 | 20.1 | 6.3 | | | |
| | RVL1.25-4 | #8 | 4.3 | 8.0 | 21.5 | 7.0 | | | |
| | RV1.25-5 | #10 | 5.3 | 8.0 | 21.5 | 7.0 | | | |
| | RV1.25-6 | 1/4 | 6.5 | 11.6 | 27.5 | 11.1 | | | |
| | RV1.25-8 | 5/16 | 8.4 | 11.6 | 27.5 | 11.1 | | | |
| | RV1.25-10 | 3/8 | 10.5 | 13.6 | 31.6 | 13.9 | | | |
| 1.5~2.5mm ² (16-14) I _{max} =27A | RV2-3 | #4 | 3.2 | 6.6 | 17.8 | 4.3 | 10.0 | 4.9 | blue |
| | RVS2-3.5 | #6 | 3.7 | 6.6 | 17.8 | 4.3 | | | |
| | RVM2-3.5 | #6 | 3.7 | 6.6 | 21.0 | 7.0 | | | |
| | RVL2-3.5 | #6 | 3.7 | 8.5 | 22.5 | 7.75 | | | |
| | RVS2-4 | #8 | 4.3 | 6.6 | 21.0 | 7.0 | | | |
| | RVL2-4 | #8 | 4.3 | 8.5 | 22.5 | 7.75 | | | |
| | RVS2-5 | #10 | 5.3 | 8.5 | 22.5 | 7.75 | | | |
| | RVL2-5 | #10 | 5.3 | 9.5 | 22.5 | 7.25 | | | |
| | RV2-6 | 1/4 | 6.5 | 12.0 | 27.6 | 11.0 | | | |
| | RV2-8 | 5/16 | 8.4 | 12.0 | 27.6 | 11.0 | | | |
| RV2-10 | 3/8 | 10.5 | 13.6 | 30.2 | 13.9 | | | | |
| 2.5~4mm ² (14-12) I _{max} =37A | RV3.5-4 | #8 | 4.3 | 8.0 | 24.5 | 7.7 | 12.5 | 6.2 | black |
| | RVS3.5-5 | #10 | 5.3 | 8.0 | 24.5 | 7.7 | | | |
| | RVL3.5-5 | #10 | 5.3 | 12.0 | 27.9 | 7.7 | | | |
| | RV3.5-6 | 1/4 | 6.5 | 12.0 | 27.9 | 7.7 | | | |
| 4~6mm ² (12-10) I _{max} =48A | RV5.5-3.5 | #6 | 3.7 | 7.2 | 21.4 | 5.9 | 12.5 | 6.7 | yellow |
| | RVS5.5-4 | #8 | 4.3 | 7.2 | 21.5 | 5.9 | | | |
| | RVL5.5-4 | #8 | 4.3 | 9.5 | 25.5 | 8.3 | | | |
| | RV5.5-5 | #10 | 5.3 | 9.5 | 25.5 | 8.3 | | | |
| | RV5.5-6 | 1/4 | 6.5 | 12.0 | 31.5 | 13.0 | | | |
| | RV5.5-8 | 5/16 | 8.4 | 15.0 | 33.7 | 13.7 | | | |
| | RV5.5-10 | 3/8 | 10.5 | 15.0 | 33.7 | 13.7 | | | |
| RV5.5-12 | 1/2 | 13.0 | 19.2 | 38.1 | 16.0 | | | | |

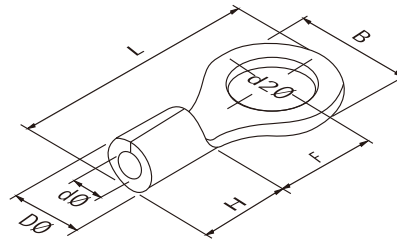

| | Item NO. | USA screw | screw dia. d2 (mm) | Dimension | | | | | |
|---|---------------|-----------|-----------------------|-----------|--------|--------|---------|---------|---------|
| | | | | B (mm) | L (mm) | F (mm) | EØ (mm) | DØ (mm) | dØ (mm) |
| 0.5~1.5mm ² (22-16) I _{max} =19A | RNB 1.25-3 | #4 | 3.2 | 5.7 | 12.6 | 4.95 | 4.8 | 3.4 | 1.7 |
| | RNBS 1.25-3.5 | #6 | 3.7 | 5.7 | 12.6 | 4.95 | | | |
| | RNBM 1.25-3.5 | #6 | 3.7 | 6.6 | 14.4 | 6.3 | | | |
| | RNBL 1.25-3.5 | #6 | 3.7 | 8.0 | 15.8 | 7.0 | | | |
| | RNBS1.25-4 | #8 | 4.3 | 6.6 | 14.4 | 6.3 | | | |
| | RNBL 1.25-4 | #8 | 4.3 | 8.0 | 15.8 | 7.0 | | | |
| | RNB1.25-5 | #10 | 5.3 | 8.0 | 15.8 | 7.0 | | | |
| | RNB1.25-6 | 1/4 | 6.4 | 11.6 | 21.8 | 11.1 | | | |
| | RNB1.25-8 | 5/16 | 8.4 | 11.6 | 21.8 | 11.1 | | | |
| | RNB1.25-10 | 3/8 | 10.5 | 13.6 | 25.5 | 13.6 | | | |
| 1.5~2.5mm ² (16-14) I _{max} =27A | RNB2-3 | #4 | 3.2 | 6.6 | 12.3 | 4.3 | 4.8 | 4.1 | 2.3 |
| | RNBS 2-3.5 | #6 | 3.7 | 6.6 | 12.3 | 4.3 | | | |
| | RNBM2-3.5 | #6 | 3.7 | 6.6 | 16.0 | 7.0 | | | |
| | RNBL 2-3.5 | #6 | 3.7 | 8.5 | 16.8 | 7.75 | | | |
| | RNBS2-4 | #8 | 4.3 | 6.6 | 16.0 | 7.0 | | | |
| | RNBL 2-4 | #8 | 4.3 | 8.5 | 16.8 | 7.75 | | | |
| | RNBS 2-5 | #10 | 5.3 | 8.5 | 16.8 | 7.75 | | | |
| | RNBL2-5 | #10 | 5.3 | 9.5 | 16.8 | 7.25 | | | |
| | RNB 2-6 | 1/4 | 6.4 | 12.0 | 21.8 | 11.0 | | | |
| | RNB 2-8 | 5/16 | 8.4 | 12.0 | 21.8 | 11.0 | | | |
| | RNB 2-10 | 3/8 | 10.5 | 13.6 | 25.5 | 13.9 | | | |
| | RNB 2-12 | 1/2 | 13.0 | 19.2 | 31.1 | 16.5 | | | |
| 2.5~4mm ² (14-12) I _{max} =37A | RNB 3.5-4 | #8 | 4.3 | 8.0 | 18.0 | 7.7 | 6.0 | 5.0 | 3.0 |
| | RNBS 3.5-5 | #10 | 5.3 | 8.0 | 18.0 | 7.7 | | | |
| | RNBL3.5-5 | #10 | 5.3 | 12.0 | 21.4 | 7.7 | | | |
| | RNB 3.5-6 | 1/4 | 6.4 | 12.0 | 21.4 | 7.7 | | | |
| 4~6mm ² (12-10) I _{max} =48A | RNB 5.5-3.5 | #6 | 3.7 | 7.2 | 15.7 | 5.9 | 6.8 | 5.6 | 3.4 |
| | RNBS 5.5-4 | #8 | 4.3 | 7.2 | 15.7 | 5.9 | | | |
| | RNBL 5.5-4 | #8 | 4.3 | 9.5 | 19.8 | 8.3 | | | |
| | RNB 5.5-5 | #10 | 5.3 | 9.5 | 19.8 | 8.3 | | | |
| | RNB 5.5-6 | 1/4 | 6.4 | 12.0 | 25.8 | 13.0 | | | |
| | RNB 5.5-8 | 5/16 | 8.4 | 15.0 | 28.0 | 13.7 | | | |
| | RNB 5.5-10 | 3/8 | 10.5 | 15.0 | 28.0 | 13.7 | | | |
| RNB 5.5-12 | 1/2 | 13.0 | 19.2 | 32.4 | 16.0 | | | | |

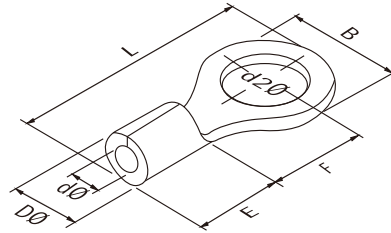

| | Item NO. | USA screw | screw dia. d2 (mm) | Dimension | | | | | |
|--|------------|-----------|-----------------------|-----------|--------|--------|---------|---------|---------|
| | | | | B (mm) | L (mm) | F (mm) | EØ (mm) | DØ (mm) | dØ (mm) |
| 6~10mm ² (8) I _{max} =62A | RNB 8-4 | #8 | 4.3 | 8.8 | 23.8 | 9.3 | 8.5 | 7.2 | 4.5 |
| | RNBS 8-5 | #10 | 5.3 | 8.8 | 23.8 | 11.1 | | | |
| | RNBM 8-5 | #10 | 5.3 | 12.0 | 23.8 | 9.3 | | | |
| | RNBL 8-5 | #10 | 5.3 | 15.0 | 29.8 | 13.8 | | | |
| | RNBS 8-6 | 1/4 | 6.4 | 12.0 | 23.8 | 9.3 | | | |
| | RNBL 8-6 | 1/4 | 6.4 | 15.0 | 29.8 | 13.8 | | | |
| | RNB 8-8 | 5/16 | 8.4 | 15.0 | 29.8 | 13.8 | | | |
| | RNB 8-10 | 3/8 | 10.5 | 15.0 | 29.38 | 13.8 | | | |
| | RNB 8-12 | 1/2 | 13.0 | 20.0 | 33.5 | 15.0 | | | |
| | RNB 14-4 | #8 | 4.3 | 12.0 | 29.8 | 13.3 | | | |
| 10~16mm ² (6) I _{max} =88A | RNB 14-5 | #10 | 5.3 | 12.0 | 29.8 | 13.3 | 10.5 | 9.0 | 5.8 |
| | RNBS 14-6 | 1/4 | 6.4 | 12.0 | 29.8 | 13.3 | | | |
| | RNBL 14-6 | 1/4 | 6.4 | 16.0 | 32.8 | 13.3 | | | |
| | RNB 14-8 | 5/16 | 8.4 | 16.0 | 32.8 | 14.5 | | | |
| | RNB 14-10 | 3/8 | 10.5 | 16.0 | 32.8 | 14.5 | | | |
| | RNB 14-12 | 1/2 | 13.0 | 22.0 | 41.0 | 19.5 | | | |
| | RNBS 22-5 | #10 | 5.3 | 12.2 | 33.2 | 14.5 | | | |
| | RNBL 22-5 | #10 | 5.3 | 16.5 | 33.7 | 13.5 | | | |
| | RNBS 22-6 | 1/4 | 6.4 | 12.2 | 33.2 | 14.5 | | | |
| | RNBL 22-6 | 1/4 | 6.4 | 6.5 | 33.7 | 13.5 | | | |
| | RNB 22-8 | 5/16 | 8.4 | 16.5 | 33.7 | 13.5 | | | |
| | RNB 22-10 | 3/8 | 10.5 | 16.5 | 33.7 | 13.5 | | | |
| 16~25mm ² (4) I _{max} =115A | RNB 22-11 | 7/16 | 11.5 | 22.0 | 42.5 | 19.5 | 12.0 | 11.5 | 7.7 |
| | RNB 22-12 | 1/2 | 13.0 | 22.0 | 42.5 | 19.5 | | | |
| | RNB 38-5 | #10 | 5.3 | 15.3 | 39.0 | 18.3 | | | |
| | RNB 38-5 | 1/4 | 6.4 | 15.3 | 39.0 | 18.3 | | | |
| 35~50mm ² (2) I _{max} =160A | RNBS 38-8 | 5/16 | 8.4 | 15.3 | 39.0 | 18.3 | 14.0 | 13.3 | 9.4 |
| | RNBL 38-8 | 5/16 | 8.4 | 22.0 | 42.7 | 17.7 | | | |
| | RNBS 38-10 | 3/8 | 10.5 | 15.3 | 39.0 | 18.3 | | | |
| | RNBL 38-10 | 3/8 | 10.5 | 22.0 | 42.7 | 17.7 | | | |
| | RNB 38-11 | 7/16 | 11.5 | 22.0 | 42.7 | 17.7 | | | |
| | RNB 38-12 | 1/2 | 13.0 | 22.0 | 42.7 | 17.7 | | | |

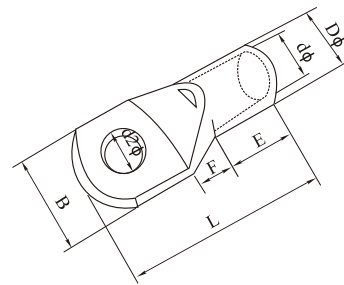

| Item NO. | screw dia. d2(mm) | Dimension | | | | | CInle Sq |
|-----------|----------------------|-----------|---------|--------|--------|--------|----------|
| | | dØ (mm) | DØ (mm) | B (mm) | E (mm) | L (mm) | |
| SC1.5-5 | 5.2 | 1.8 | 3.7 | 8.0 | 6.5 | 16 | 1.5 |
| SC2.5-4 | 4.2 | 2.4 | 4.0 | 8.0 | 7.0 | 18 | 2.5 |
| SC2.5-5 | 5.2 | 2.4 | 4.0 | 10.0 | 7.0 | 20 | 2.5 |
| SC4-5 | 5.2 | 3.1 | 4.8 | 10 | 7.5 | 20 | 4 |
| SC4-6 | 6.5 | 3.1 | 4.8 | 10 | 7.5 | 20 | 4 |
| SC6-5 | 5.2 | 3.8 | 5.5 | 10 | 8.0 | 23 | 6 |
| SC6-6 | 6.5 | 3.8 | 5.5 | 12 | 8.0 | 23 | 6 |
| SC10-6 | 6.5 | 4.5 | 6.2 | 12 | 9.0 | 25 | 10 |
| SC10-8 | 8.4 | 4.5 | 6.2 | 12 | 9.0 | 25 | 10 |
| SC16-6 | 6.5 | 5.4 | 7.1 | 12 | 11.0 | 30 | 16 |
| SC16-8 | 8.4 | 5.4 | 7.1 | 12 | 11.0 | 30 | 16 |
| SC25-6 | 6.5 | 6.8 | 8.8 | 13 | 13.5 | 33 | 25 |
| SC25-8 | 8.4 | 6.8 | 8.8 | 18 | 13.5 | 33 | 25 |
| SC35-8 | 8.4 | 8.2 | 10.6 | 15.3 | 14.5 | 38 | 35 |
| SC35-10 | 10.5 | 8.2 | 10.6 | 18 | 14.5 | 38 | 35 |
| SC50-8 | 8.4 | 9.5 | 12.4 | 17.8 | 17 | 45 | 50 |
| SC50-10 | 10.5 | 9.5 | 12.4 | 17.8 | 17 | 45 | 50 |
| SC70-10 | 10.5 | 11.2 | 14.7 | 21.0 | 19.5 | 50 | 70 |
| SC70-12 | 13.0 | 11.2 | 14.7 | 21.0 | 19.5 | 50 | 70 |
| SC95-10 | 10.5 | 13.5 | 17.4 | 25 | 23.5 | 55 | 95 |
| SC-95-12 | 13 | 13.5 | 17.4 | 25 | 23.5 | 55 | 95 |
| SC120-12 | 13 | 15 | 19.4 | 28 | 26 | 63 | 120 |
| SC120-16 | 17 | 15 | 19.4 | 28 | 26 | 63 | 120 |
| SC150-12 | 13 | 16.5 | 21.2 | 30 | 29 | 70 | 150 |
| SC150-16 | 17 | 16.5 | 21.2 | 30 | 29 | 70 | 150 |
| SC185-16 | 17 | 18.5 | 23.5 | 34 | 33 | 75 | 185 |
| SC240-16 | 17 | 21 | 26.5 | 38 | 40 | 90 | 240 |
| SC240-20 | 21 | 21 | 26.5 | 38 | 40 | 90 | 240 |
| SC300-16 | 17 | 23.5 | 30 | 43 | 44 | 98 | 300 |
| SC300-20 | 21 | 23.5 | 30 | 43 | 44 | 98 | 300 |
| SC400-16 | 17 | 28.5 | 36.5 | 50.1 | 46 | 110 | 400 |
| SC400-20 | 21 | 28.5 | 36.5 | 50.1 | 46 | 110 | 400 |
| SC500-16 | 17 | 30 | 39 | 56 | 50 | 120 | 500 |
| SC500-20 | 21 | 30 | 39 | 56 | 50 | 120 | 500 |
| SC630-20 | 21 | 35 | 45 | 65 | 56 | 140 | 630 |
| SC800-BL | - | 39 | 50.6 | 73.5 | 60 | 170 | 800 |
| SC1000-BL | - | 43 | 56.2 | 81 | 87 | 200 | 1000 |

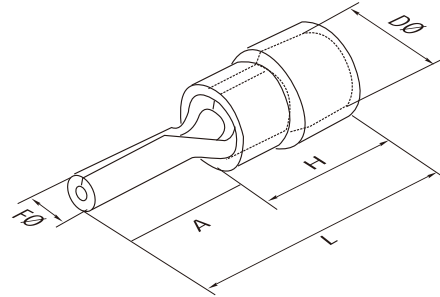

Cross section: 0.5~1.5mm² (22-16) Max current: I_{max}=19A

| Item NO. | Dimension | | | | Color |
|------------|-----------|--------|--------|---------|-------|
| | F Ø(mm) | L (mm) | H (mm) | D Ø(mm) | |
| PTV1.25-9 | 1.9 | 19.0 | 10.0 | 4.3 | Red |
| PTV1.25-10 | 1.9 | 20.0 | | | |
| PTV1.25-12 | 1.9 | 22.0 | | | |
| PTV1.25-13 | 1.9 | 23.0 | | | |
| PTV1.25-18 | 1.9 | 28.0 | | | |

Cross section: 1.5-2.5mm² (16-14) Max current: I_{max}=27A

| Item NO. | Dimension | | | | Color |
|----------|-----------|--------|--------|---------|-------|
| | F Ø(mm) | L (mm) | H (mm) | D Ø(mm) | |
| PTV2-9 | 1.9 | 19.0 | 10.0 | 4.3 | Blue |
| PTV2-10 | 1.9 | 20.0 | | | |
| PTV2-12 | 1.9 | 22.0 | | | |
| PTV2-13 | 1.9 | 23.0 | | | |
| PTV2-18 | 1.9 | 28.0 | | | |

Cross section: 4~6mm² (12-10) Max current: I_{max}=48A

| Item NO. | Dimension | | | | Color |
|-----------|-----------|--------|--------|---------|--------|
| | F Ø(mm) | L (mm) | H (mm) | D Ø(mm) | |
| PTV5.5-13 | 2.8 | 25.5 | 12.5 | 6.7 | yellow |

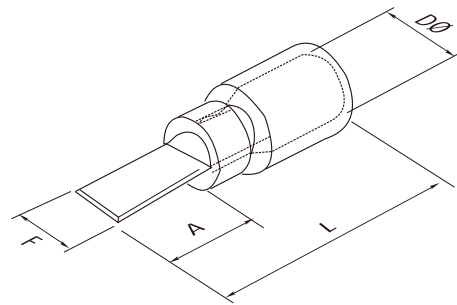

Cross section: 0.5~1.5mm² (22-16) Max current: I_{max}=19A

| Item NO. | Dimension | | | |
|------------|-----------|--------|--------|--------|
| | F (mm) | L (mm) | A (mm) | D (mm) |
| DBV1.25-10 | 2.3 | 20.0 | 10.0 | 4.3 |
| DBV1.25-11 | 3.0 | 21.0 | 11.0 | |
| DBV1.25-14 | 3.0 | 24.0 | 14.0 | |
| DBV1.25-18 | 2.3 | 28.0 | 18.0 | |

Cross section: 1.5~2.5mm² (16-14) Max current: I_{max}=19A

| Item NO. | Dimension | | | |
|----------|-----------|--------|--------|--------|
| | F (mm) | L (mm) | A (mm) | D (mm) |
| DBV2-9 | 2.8 | 19.0 | 9.0 | 4.9 |
| DBV2-15 | 2.3 | 25.0 | 15.0 | |
| DBV2-18 | 2.3 | 28.0 | 18.0 | |

Cross section: 4-6mm² (12-10) Max current: I_{max}=48A

| Item NO. | Dimension | | | |
|-----------|-----------|--------|--------|--------|
| | F (mm) | L (mm) | A (mm) | D (mm) |
| DBV5.5-10 | 2.8 | 22.5 | 10.0 | 5.6 |

KE10.1
Al 4×10-35mm² / Cu 1.5-25mm²

Description: KE10.1 connector can be used for aluminum and copper conductors. Tightening torque is 10Nm. The connectors are used either inside metal poles or in separate boxes.

KE10.504
Al 4×10-50mm² / Cu 2.5-35mm²

Description: KE 10.504 connector can be used for aluminum and copper conductors. Tightening torque is 10Nm. The connectors are used either inside metal poles or in separate boxes.

| Item No. | KE10.1 | KE10.504 |
|-----------------------|-----------------------------------|-----------------------------------|
| Ratings | ETIM class, low current connector | ETIM class, low current connector |
| Length | 55.7mm | 62mm |
| Height | 29.4mm | 29.55mm |
| Weight | 0.048kg | 0.053kg |
| Colour | Transparent | Transparent |
| Model | Branch | Branch |
| Tightening torque | 10 Nm | 10 Nm |
| Conductor size Al | 10...35 mm ² | 10...50 mm ² |
| Conductor size Cu | 1.5...25 mm ² | 2.5...35 mm ² |
| Conductor diameter | 1.7...9 mm ² | 2...10.2 mm ² |
| Material insulation | PC | PC |
| Nominal cross section | 1.5...35 mm ² | 2.5...50 mm ² |
| Core diameter | 1.7...9 mm | 2...10.2 mm |



KE10.3
Al 6×10-35mm² / Cu 1.5-25mm²

Description: KE10.3 connector can be used for aluminum and copper conductors. Tightening torque is 10Nm. The connectors are used either inside metal poles or in separate boxes.

KE10.506
Al 6×10-50mm² / Cu 2.5-35mm²

Description: KE 10.506 connector can be used for aluminum and copper conductors. Tightening torque is 10Nm. The connectors are used either inside metal poles or in separate boxes.

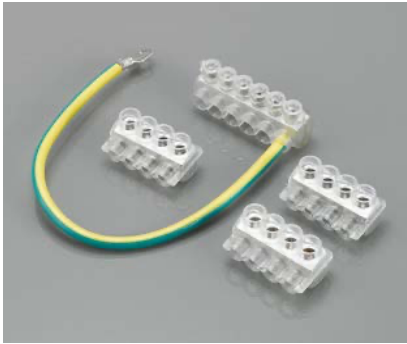
| Item No. | KE10.3 | KE10.506 |
|-----------------------|-----------------------------------|-----------------------------------|
| Ratings | ETIM class, low current connector | ETIM class, low current connector |
| Length | 80.5mm | 90.05mm |
| Height | 29mm | 29.55mm |
| Weight | 0.070kg | 0.077kg |
| Colour | Transparent | Transparent |
| Model | Branch | Branch |
| Tightening torque | 10 Nm | 10 Nm |
| Conductor size Al | 10...35 mm ² | 10...50 mm ² |
| Conductor size Cu | 1.5...25 mm ² | 2.5...35 mm ² |
| Conductor diameter | 1.7...9mm ² | 2...10.2 mm ² |
| Material insulation | PC | PC |
| Nominal cross section | 1.5...35 mm ² | 2.5...50 mm ² |
| Core diameter | 1.7...9 mm | 2...10.2 mm |

**SV15****Al 10-35mm² / Cu 1.5-25mm²**

Description: SV15 includes three phase connectors of KE10.1 and one connector of KE10.3, plus an 16mm² earth wire of 35mm with a cable lug.

| Item No. | SV15 |
|-----------------------|-----------------------------------|
| Ratings | ETIM class, low current connector |
| Weight | 0.28kg |
| Colour | Transparent |
| Model | Branch |
| Tightening torque | 10 Nm |
| Conductor size Al | 10...35 mm ² |
| Conductor size Cu | 1.5...25 mm ² |
| Conductor diameter | 1.7...9 mm |
| Material insulation | PC |
| Nominal cross section | 1.5...35 mm ² |
| Core diameter | 1.7...9 mm |
| Max. number of cores | 4 |

**SV15.5****Al 10-35mm² / Cu 1.5-25mm²**

Description: SV15.5 includes four phase connectors of KE10.1 and one connector of KE10.3, plus an 16mm² earth wire of 35mm with a cable lug.

| Item No. | SV15.5 |
|-----------------------|-----------------------------------|
| Ratings | ETIM class, low current connector |
| Weight | 0.33kg |
| Colour | Transparent |
| Model | Branch |
| Tightening torque | 10 Nm |
| Conductor size Al | 10...35 mm ² |
| Conductor size Cu | 1.5...25 mm ² |
| Conductor diameter | 1.7...9 mm |
| Material insulation | PC |
| Nominal cross section | 1.5...35mm ² |
| Core diameter | 1.7...9mm |
| Max. number of cores | 5 |

**SV50****Al 10-50mm² / Cu 2.5-35mm²**

Description: SV50 includes three phase connectors of KE10.504 and one connector of KE10.506, plus an 16mm² earth wire of 35mm with a cable lug.

| Item No. | SV50 |
|-----------------------|-----------------------------------|
| Ratings | ETIM class, low current connector |
| Weight | 0.3kg |
| Colour | Transparent |
| Model | Branch |
| Tightening torque | 10 Nm |
| Conductor size Al | 10...50 mm ² |
| Conductor size Cu | 2.5...35mm ² |
| Conductor diameter | 2...10.2 mm |
| Material insulation | PC |
| Nominal cross section | 2.5...50 mm ² |
| Core diameter | 2...10.2 mm |
| Max. number of cores | 4 |

WIRING DUCT SERIES

Multiple models and sizes, equipped with complete cable tray covers, support special color customization. Standard length of 2 meters, manufacturer provides customized length.



L-UD/R,L-VD/R SERIES LOW SMOKE HALOGEN FREE WIRING DUCT

Polycarbonate [PC] + Engineering Plastics [ABS]
The new low-smoke halogen-free reinforced trunking

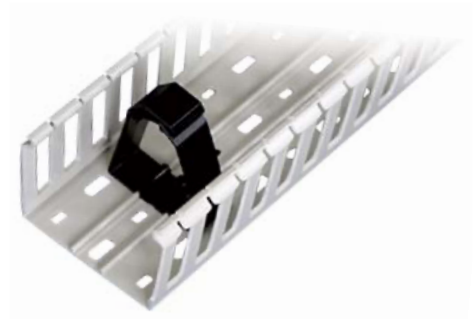

Material

- Polycarbonate (PC)+engineering plastics (ABS), halogen-free, low smoke and environmentally friendly insulation material, with electrical and fire safety.
- Fire rating:UL94 V-0 Non Flame Spread Product

Structure

1. Both sides gradually thicken from top to bottom, making them more sturdy and durable;
2. The combination of reverse buckle groove body and groove cover design makes it easy to disassemble and safer;
3. The bottom right angle is concave and easy to fold. Simply cut both ends to connect with the vertical trunking, forming a flat surfaceDirect channel, all-round protection of cables;
4. The bottom track is convenient for attaching coils to fix cables, ensuring proper and tidy wiring, and saving space.



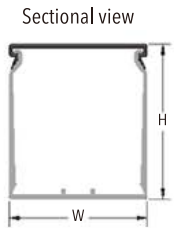

Bottom with single holes for width less than 75mm

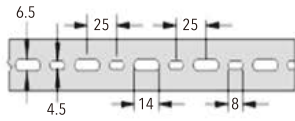

L-UD/R series

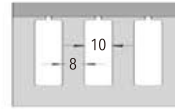

Bottom with triple holes for width over 75mm

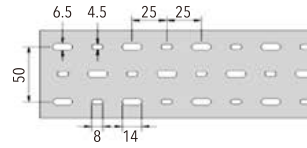

L-VD/R series



L-UD/R series low-smoke halogen-free insulated wiring trough (reinforced type)

| Model | Specification | | Slot width mm | Sliver width mm | Wires to be Contained | Package meter |
|------------------|---------------|-----------|---------------|-----------------|-----------------------|---------------|
| | Height(mm) | Width(mm) | | | | |
| L-UD/R 25/25 | 25 | 25 | 10 | 10 | 10-25pcs | 100 |
| L-UD/R 37.5/37.5 | 37.5 | 37.5 | 10 | 10 | 60-70pcs | 100 |
| L-UD/R 50/25 | 50 | 25 | 10 | 10 | 20-30pcs | 100 |
| L-UD/R 50/37.5 | 50 | 37.5 | 10 | 10 | 20-35pcs | 80 |
| L-UD/R 50/50 | 50 | 50 | 10 | 10 | 80-90pcs | 80 |
| L-UD/R 50/75 | 50 | 75 | 10 | 10 | 180-200pcs | 48 |
| L-UD/R 50/100 | 50 | 100 | 10 | 10 | 220-250pcs | 48 |
| L-UD/R 75/25 | 75 | 25 | 10 | 10 | 50-55pcs | 60 |
| L-UD/R 75/37.5 | 75 | 37.5 | 10 | 10 | 110-115pcs | 60 |
| L-UD/R 75/50 | 75 | 50 | 10 | 10 | 180-200pcs | 48 |
| L-UD/R 75/75 | 75 | 75 | 10 | 10 | 200-240pcs | 36 |
| L-UD/R 75/100 | 75 | 100 | 10 | 10 | 260-320pcs | 24 |

L-VD/R series low-smoke halogen-free insulated wiring trough (reinforced type)

| Model | Specification | | Slot width mm | Sliver width mm | Wires to be Contained | Package meter |
|------------------|---------------|-----------|---------------|-----------------|-----------------------|---------------|
| | Height(mm) | Width(mm) | | | | |
| L-VD/R 25/25 | 25 | 25 | 6 | 6.5 | 10-25pcs | 100 |
| L-VD/R 37.5/37.5 | 37.5 | 37.5 | 6 | 6.5 | 60-70pcs | 100 |
| L-VD/R 50/25 | 50 | 25 | 6 | 6.5 | 20-30pcs | 100 |
| L-VD/R 50/37.5 | 50 | 37.5 | 6 | 6.5 | 20-35pcs | 80 |
| L-VD/R 50/50 | 50 | 50 | 6 | 6.5 | 80-90pcs | 80 |
| L-VD/R 50/75 | 50 | 75 | 6 | 6.5 | 180-200pcs | 48 |
| L-VD/R 50/100 | 50 | 100 | 6 | 6.5 | 220-250PCS | 48 |
| L-VD/R 75/25 | 75 | 25 | 6 | 6.5 | 50-55pcs | 60 |
| L-VD/R 75/37.5 | 75 | 37.5 | 6 | 6.5 | 110-115pcs | 60 |
| L-VD/R 75/50 | 75 | 50 | 6 | 6.5 | 180-200pcs | 48 |
| L-VD/R 75/75 | 75 | 75 | 6 | 6.5 | 200-240pcs | 36 |
| L-VD/R 75/100 | 75 | 100 | 6 | 6.5 | 260-320pcs | 24 |

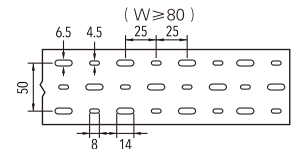
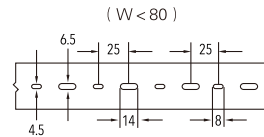
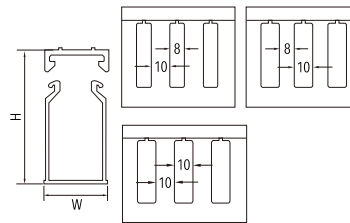

| Model | Specification | | Slot width mm | Sliver width mm | Wires to be Contained | Package meter |
|--------------|---------------|-----------|---------------|-----------------|-----------------------|---------------|
| | Height(mm) | Width(mm) | | | | |
| L-UD 35 35 | 35 | 35 | 10 | 8 | 20-25pcs | 100 |
| L-UD 40 25 | 40 | 25 | 8 | 10 | 20-30pcs | 100 |
| L-UD 40.30 | | 30 | 8 | 10 | 35-40pcs | 100 |
| L-UD 40 40 | | 40 | 8 | 10 | 60-70pcs | 100 |
| L-UD 40 50 | | 50 | 8 | 10 | 50-70pcs | 80 |
| L-UD 40 60 | | 60 | 8 | 10 | 100-115pcs | 64 |
| L-UD 40 80 | | 80 | 8 | 10 | 120-135pcs | 48 |
| L-UD 50 25 | | 50 | 25 | 8 | 10 | 20-35pcs |
| L-UD 50 35 | 35 | | 8 | 10 | 40-60pcs | 100 |
| L-UD 50 50 | 50 | | 8 | 10 | 80-90pcs | 80 |
| L-UD 50 80 | 80 | | 8 | 10 | 160-180pcs | 48 |
| L-UD 60 25 | 60 | 25 | 8 | 10 | 40-55pcs | 80 |
| L-UD 60 30 | | 30 | 8 | 10 | 40-65pcs | 80 |
| L-UD 60 40 | | 40 | 8 | 10 | 100-115pcs | 46 |
| L-UD 60 60 | | 60 | 8 | 10 | 120-135pcs | 48 |
| L-UD 60 80 | | 80 | 8 | 10 | 180-210pcs | 36 |
| L-UD 60 100 | | 100 | 8 | 10 | 230-250pcs | 32 |
| L-UD 60 120 | | 120 | 8 | 10 | 260-350pcs | 24 |
| L-UD 80 25 | 80 | 25 | 8 | 10 | 100-120pcs | 60 |
| L-UD 80 30 | | 30 | 8 | 10 | 105-125pcs | 60 |
| L-UD 80 35 | | 35 | 8 | 10 | 110-130pcs | 60 |
| L-UD 80 40 | | 40 | 8 | 10 | 140-160pcs | 48 |
| L-UD 80 45 | | 45 | 8 | 10 | 140-165pcs | 48 |
| L-UD 80 50 | | 50 | 8 | 10 | 160-180pcs | 48 |
| L-UD 80 60 | | 60 | 8 | 10 | 180-210pcs | 36 |
| L-UD 80 80 | | 80 | 8 | 10 | 240-290pcs | 36 |
| L-UD 80 100 | | 100 | 8 | 10 | 260-350pcs | 24 |
| L-UD 80 120 | | 120 | 8 | 10 | 280-380pcs | 24 |
| LUD 100 30 | 100 | 30 | 10 | 10 | 130-160pcs | 48 |
| L-UD 100 33 | | 33 | 10 | 10 | 130-165pes | 48 |
| L-UD 100 40 | | 40 | 10 | 10 | 130-175pcs | 48 |
| L-UD 100 50 | | 50 | 10 | 10 | 220-250pcs | 48 |
| L-UD 100 60 | | 60 | 10 | 10 | 240-290pcs | 32 |
| L-UD 100 75 | | 75 | 10 | 10 | 260-350pcs | 24 |
| L-UD 100 80 | | 80 | 10 | 10 | 260-360pcs | 24 |
| L-UD 100 100 | | 100 | 10 | 10 | 300-400pcs | 24 |

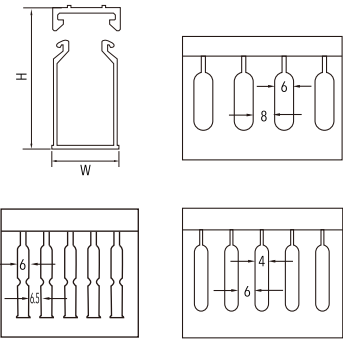
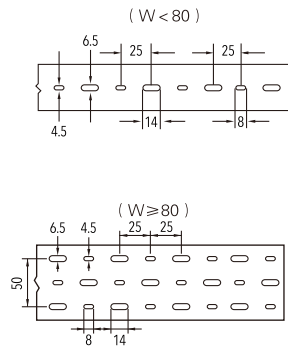

(H ≥ 60)

| Model | Specification | | Slot width mm | Sliver width mm | Wires to be Contained | Package meter |
|--------------|---------------|-----------|---------------|-----------------|-----------------------|---------------|
| | Height(mm) | Width(mm) | | | | |
| L-VD 25 25 | 25 | 25 | 6 | 6.5 | 10-25pcs | 100 |
| L-VD 35 35 | 35 | 35 | 4 | 6 | 20-25pcs | 100 |
| L-VD 40 25 | 40 | 25 | 4 | 6 | 20-25pcs | 100 |
| L-VD 40 30 | | 30 | 4 | 6 | 35-40pcs | 100 |
| L-VD 40 40 | | 40 | 4 | 6 | 60-70pcs | 100 |
| L-VD 40 50 | | 50 | 4 | 6 | 50-70pcs | 80 |
| L-VD 40 60 | | 60 | 4 | 6 | 100-115pcs | 64 |
| L-VD 40 80 | | 80 | 4 | 6 | 120-135pcs | 48 |
| L-VD 50 25 | | 50 | 25 | 4 | 6 | 20-35pcs |
| L-VD 50 35 | 35 | | 4 | 6 | 40-60pcs | 100 |
| L-VD 50 50 | 50 | | 4 | 6 | 80-90pcs | 80 |
| L-VD 50 80 | 80 | | 4 | 6 | 160-180pcs | 48 |
| L-VD 60 25 | 60 | 25 | 4 | 6 | 40-55pcs | 80 |
| L-VD 60 30 | | 30 | 4 | 6 | 40-65pcs | 80 |
| L-VD 60 40 | | 40 | 4 | 6 | 100-115pcs | 64 |
| L-VD 60 60 | | 60 | 4 | 6 | 120-135pcs | 48 |
| L-VD 60 80 | | 80 | 4 | 6 | 180-210pcs | 36 |
| L-VD 60 100 | | 100 | 4 | 6 | 230-250pcs | 32 |
| L-VD 60 120 | | 120 | 4 | 6 | 260-350pcs | 24 |
| L-VD 80 25 | | 80 | 25 | 4 | 6 | 100-120pcs |
| L-VD 80 30 | 30 | | 4 | 6 | 105-125pcs | 60 |
| L-VD 80 35 | 35 | | 4 | 6 | 110-130pcs | 60 |
| L-VD 80 40 | 40 | | 4 | 6 | 140-160pcs | 48 |
| L-VD 80 45 | 45 | | 4 | 6 | 140-165pcs | 48 |
| L-VD 80 50 | 50 | | 4 | 6 | 160-180pcs | 48 |
| L-VD 80 60 | 60 | | 4 | 6 | 180-210pcs | 36 |
| L-VD 80 80 | 80 | | 4 | 6 | 240-290pcs | 36 |
| L-VD 80 100 | 100 | | 4 | 6 | 260-350pcs | 24 |
| L-VD 80 120 | 120 | | 4 | 6 | 280-380pcs | 24 |
| L-VD 100 30 | 100 | 30 | 6 | 8 | 130-160pcs | 48 |
| L-VD 100 33 | | 33 | 6 | 8 | 130-165pcs | 48 |
| L-VD 100 40 | | 40 | 6 | 8 | 130-175pcs | 48 |
| L-VD 100 50 | | 50 | 6 | 8 | 220-250pcs | 48 |
| L-VD 100 60 | | 60 | 6 | 8 | 240-290pcs | 32 |
| L-VD 100 75 | | 75 | 6 | 8 | 260-350pcs | 24 |
| L-VD 100 80 | | 80 | 6 | 8 | 260-360pcs | 24 |
| L-VD 100 100 | | 100 | 6 | 8 | 300-400pcs | 24 |

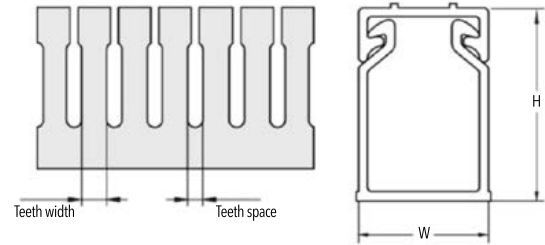

| Wide slot /finger Model No. | Dimemision | | Teeth space-Teeth with[mm] | | | Package [m] |
|--------------------------------|------------|--------|----------------------------|-----|-----|----------------|
| | H [mm] | W [mm] | 4-6 | 6-6 | 6-8 | |
| KD 25 25 | 25 | 25 | • | | | 100 |
| KD 30 20 | 30 | 20 | • | | | 100 |
| KD 30 35 | 30 | 35 | • | | | 100 |
| KD 30 30 | 30 | 30 | • | | | 100 |
| KD 30 35 | 30 | 35 | • | | | 100 |
| KD 35 35 | 35 | 35 | • | | | 100 |
| KD 40 25 | 40 | 25 | • | | | 100 |
| KD 40 40 | 40 | 40 | • | | | 100 |
| KD 40 60 | 40 | 60 | • | | | 64 |
| KD 40 80 | 40 | 80 | • | | | 48 |
| KD 45 33 | 45 | 33 | • | | | 100 |
| KD 45 45 | 45 | 45 | • | | | 80 |
| KD 50 25 | 50 | 25 | • | | | 100 |
| KD 50 35 | 50 | 35 | • | | | 100 |
| KD 50 45 | 50 | 45 | • | | | 80 |
| KD 50 50 | 50 | 50 | • | | | 80 |
| KD 50 60 | 50 | 60 | • | | | 48 |
| KD 50 80 | 50 | 80 | • | | | 48 |
| KD 60 40 | 60 | 40 | • | | | 64 |
| KD 60 60 | 60 | 60 | • | | | 48 |
| KD 60 80 | 60 | 80 | • | | | 36 |
| KD 65 33 | 65 | 33 | • | | | 80 |
| KD 65 45 | 65 | 45 | • | | | 80 |
| KD 65 65 | 65 | 65 | • | | | 48 |
| KD 80 25 | 80 | 25 | • | | • | 60 |
| KD 80 35 | 80 | 35 | • | | • | 60 |
| KD 80 40 | 80 | 40 | • | | • | 48 |
| KD 80 45 | 80 | 45 | • | | • | 48 |
| KD 80 50 | 80 | 50 | • | | • | 48 |
| KD 80 60 | 80 | 60 | • | | • | 36 |
| KD 80 80 | 80 | 80 | • | | • | 36 |
| KD 80 100 | 80 | 100 | • | | • | 24 |
| KD 80 120 | 80 | 120 | • | | • | 24 |
| KD 100 35 | 100 | 35 | | • | | 48 |
| KD 100 40 | 100 | 40 | | • | | 48 |
| KD 100 50 | 100 | 50 | | • | | 48 |
| KD 100 60 | 100 | 60 | | • | | 32 |
| KD 100 80 | 100 | 80 | | • | | 24 |
| KD 100 100 | 100 | 100 | | • | | 24 |
| KD 100 120 | 100 | 120 | | • | | 24 |

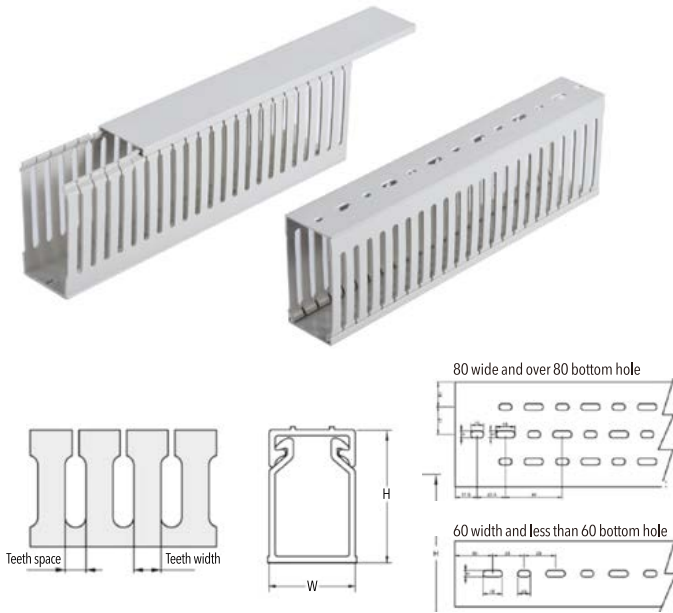

Material



- Made of hard PVC, certified by ROHS, free from harmful substances such as lead, low smoke, and environmentally friendly.
- Fire resistance rating: UL94V-0 flame retardant rating, good self extinguishing performance, and excellent insulation characteristics.

Structure

1. The groove body is formed by matching with the groove cover, which is easy to assemble and does not fall off, and the joint surface is smooth and does not harm hands;
2. The outlet holes on both sides of the slot body are symmetrical, ensuring a smooth and neat cross-section without damaging the wires.
3. Complete sizes and diverse side and installation hole designs for easy selection and wiring;
4. The unique marking line design on the slot cover can make the wiring identification clear, fast and beautiful. Color category: gray, (white, blue, black, etc. can be customized)
5. Working temperature: -20~+85 °C

| Wide slot /finger Model No. | Dimension | | Teeth space-Teeth with[mm] | | | Package [m] |
|--------------------------------|-----------|--------|----------------------------|------|-------|----------------|
| | H [mm] | W [mm] | 6-8 | 8-10 | 10-10 | |
| LD 50 25 | 50 | 25 | • | | | 100 |
| LD 50 35 | 50 | 35 | • | | | 100 |
| LD 50 45 | 50 | 45 | • | | | 80 |
| LD 50 50 | 50 | 50 | • | | | 80 |
| LD 50 60 | 50 | 60 | • | | | 48 |
| LD 50 80 | 50 | 80 | • | | | 48 |
| LD 60 40 | 60 | 40 | | • | | 64 |
| LD 60 60 | 60 | 60 | | • | | 48 |
| LD 60 80 | 60 | 80 | | • | | 36 |
| LD 65 33 | 65 | 33 | | • | | 80 |
| LD 65 45 | 65 | 45 | | • | | 80 |
| LD 65 65 | 65 | 65 | | • | | 48 |
| LD 80 25 | 80 | 25 | | • | | 60 |
| LD 80 35 | 80 | 35 | | • | | 60 |
| LD 80 40 | 80 | 40 | | • | | 48 |
| LD 80 45 | 80 | 45 | | • | | 48 |
| LD 80 50 | 80 | 50 | | • | | 48 |
| LD 80 60 | 80 | 60 | | • | | 36 |
| LD 80 80 | 80 | 80 | | • | | 36 |
| LD 80 100 | 80 | 100 | | • | | 24 |
| LD 80 120 | 80 | 120 | | • | | 24 |
| LD 100 35 | 100 | 35 | | | • | 48 |
| LD 100 40 | 100 | 40 | | | • | 48 |
| LD 100 50 | 100 | 50 | | | • | 48 |
| LD 100 60 | 100 | 60 | | | • | 32 |
| LD 100 80 | 100 | 80 | | | • | 24 |
| LD 100 100 | 100 | 100 | | | • | 24 |
| LD 100 120 | 100 | 120 | | | • | 24 |
| LD 100 140 | 100 | 140 | | | • | 16 |
| LD 130 100 | 130 | 100 | | | • | 16 |

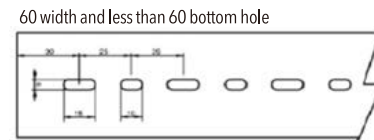
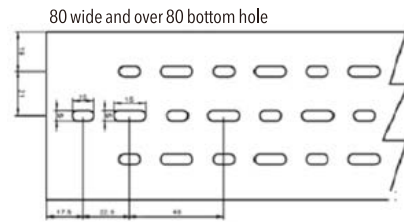
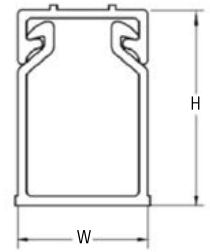
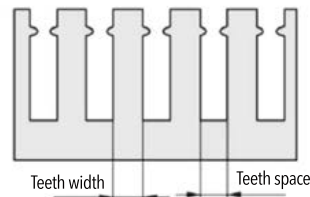

| Wide slot /finger Model No. | Dimension | | Teeth space-Teeth with[mm] | | | Package [m] |
|--------------------------------|-----------|--------|----------------------------|-----|------|----------------|
| | H [mm] | W [mm] | 4-6 | 6-8 | 8-10 | |
| LFD 80 25 | 80 | 25 | | | • | 60 |
| LFD 80 35 | 80 | 35 | | | • | 60 |
| LFD 80 40 | 80 | 40 | | | • | 48 |
| LFD 80 45 | 80 | 45 | | | • | 48 |
| LFD 80 50 | 80 | 50 | | | • | 48 |
| LFD 80 60 | 80 | 60 | | | • | 36 |
| LFD 80 80 | 80 | 80 | | | • | 36 |
| LFD 80 100 | 80 | 100 | | | • | 24 |
| LFD 80 120 | 80 | 120 | | | • | 24 |
| LFD 100 33 | 100 | 33 | | | • | 48 |
| LFD 100 35 | 100 | 35 | | | • | 48 |
| LFD 100 40 | 100 | 40 | | | • | 48 |
| LFD 100 50 | 100 | 50 | | | • | 48 |
| LFD 100 60 | 100 | 60 | | | • | 32 |
| LFD 100 80 | 100 | 80 | | | • | 24 |
| LFD 100 100 | 100 | 100 | | | • | 24 |
| LFD 100 120 | 100 | 120 | | | • | 24 |

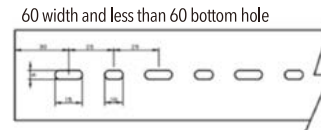
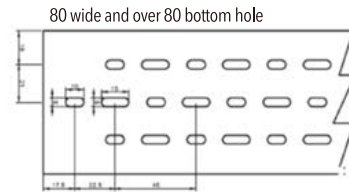
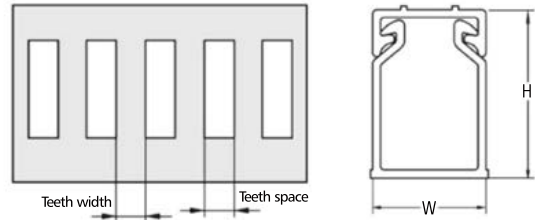

| Wide slot /finger | Dimension | | Teeth space-Teeth with[mm] | | | Package [m] |
|-------------------|-----------|--------|----------------------------|-----|-----|-------------|
| | Model No. | H [mm] | W [mm] | 6-6 | 6-8 | |
| KFD 60 40 | 60 | 40 | • | | | 64 |
| KFD 60 60 | 60 | 60 | • | | | 48 |
| KFD 60 80 | 60 | 80 | • | | | 36 |
| KFD 100 30 | 100 | 35 | | | • | 48 |
| KFD 100 40 | 100 | 40 | | | • | 48 |
| KFD 100 50 | 100 | 50 | | | • | 48 |
| KFD 100 60 | 100 | 60 | | | • | 36 |
| KFD 100 80 | 100 | 80 | | | • | 24 |
| KFD 100 100 | 100 | 100 | | | • | 24 |
| KFD 100 120 | 100 | 120 | | | • | 24 |
| KFD 100 140 | 100 | 140 | | | • | 24 |
| KFD 150 100 | 150 | 100 | | | • | 16 |

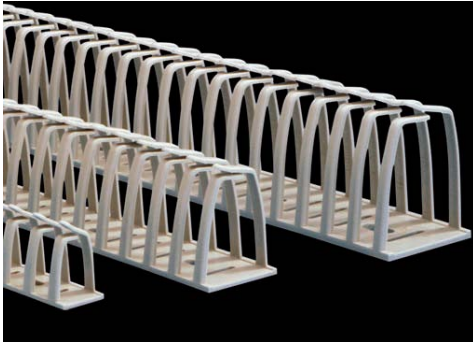

Overview

LK-FLEX Duct is a unique product offering from LINKWELL, that is a flexible, resilient and efficient harnessing solution to your wiring needs. For wiring to cabinet doors, from control panels and for electronic equipment. For that part of the cable run that leans against the side of the control cabinet.

Performance

- Due to the flexibility of the trunking material, it is easy to add or remove individual cables.
- Keel trunking without slotted cover facilitates routing in tight spaces without the need for lashing straps.
- It can be used under extreme conditions (high temperature resistance up to 176 °C), and can also resist radiation in a nuclear environment in time.
- LF-FLEX has high mechanical strength and can withstand earthquakes, equipment falls, etc. When burning, it does not emit harmful and toxic gases, and only produces a small amount of smoke.
- The length of the trunking can be cut with scissors or props as required. When securing LK-FLEX with self-adhesive, make sure the surface is clean and tidy.

LK series

Flexible ducts self-adhesive

Material: polypropylene

Color: gray RAL 7030



Flexible trunking

Material: polypropylene RAL 7030 (gray)

| Model | Dimension | | |
|-------|------------|-------------|-------------|
| | Width (mm) | Height (mm) | Length (mm) |
| LK-20 | 17 | 25 | 50 |
| LK-30 | 30 | 40 | 50 |

FD series

Flexible trunking

Material: NYLON66 (gray)

| Model | Dimension | | |
|-------|------------|-------------|-------------|
| | Width (mm) | Height (mm) | Length (mm) |
| FD-20 | 20.4 | 14.4 | 50 |
| FD-30 | 29 | 24.9 | 50 |
| FD-40 | 39 | 36 | 50 |



MKD series



| Wide slot/finger Model No. | Dimemnsion | | Package meter |
|-------------------------------|-------------|------------|------------------|
| | Height (mm) | Width (mm) | |
| MKD 25 25 | 25 | 25 | 100 |
| MKD 30 20 | 30 | 20 | 100 |
| MKD 30 35 | 30 | 35 | 100 |
| MKD 30 30 | 30 | 30 | 100 |
| MKD 30 35 | 30 | 35 | 100 |
| MKD 35 35 | 35 | 35 | 100 |
| MKD 40 25 | 40 | 25 | 100 |
| MKD 40 40 | 40 | 40 | 80 |
| MKD 40 60 | 40 | 60 | 60 |
| MKD 50 25 | 50 | 25 | 100 |
| MKD 50 35 | 50 | 35 | 100 |
| MKD 50 45 | 50 | 45 | 80 |
| MKD 50 50 | 50 | 50 | 80 |
| MKD 50 60 | 50 | 60 | 64 |
| MKD 50 80 | 50 | 80 | 48 |
| MKD 60 40 | 60 | 40 | 64 |
| MKD 60 60 | 60 | 60 | 48 |
| MKD 60 80 | 60 | 80 | 36 |
| MKD 65 33 | 65 | 33 | 80 |
| MKD 65 45 | 65 | 45 | 80 |
| MKD 65 65 | 65 | 65 | 48 |
| MKD 80 25 | 80 | 25 | 60 |
| MKD 80 35 | 80 | 35 | 60 |
| MKD 80 40 | 80 | 40 | 48 |
| MKD 80 45 | 80 | 45 | 48 |
| MKD 80 50 | 80 | 50 | 48 |
| MKD 80 60 | 80 | 60 | 36 |
| MKD 80 80 | 80 | 80 | 36 |
| MKD 80 100 | 80 | 100 | 24 |
| MKD 80 120 | 80 | 120 | 24 |
| MKD 100 35 | 100 | 35 | 48 |
| MKD 100 40 | 100 | 40 | 48 |
| MKD 100 50 | 100 | 50 | 48 |
| MKD 100 60 | 100 | 60 | 36 |
| MKD 100 80 | 100 | 80 | 24 |
| MKD 100 100 | 100 | 100 | 24 |
| MKD 100 120 | 100 | 120 | 24 |
| MKD 100 140 | 100 | 140 | 24 |
| MKD 130 100 | 130 | 100 | 24 |
| MKD 150 100 | 150 | 100 | 16 |

Cover



Model: KB-Width

| Model No. | Model No. | Model No. | Model No. |
|-----------|-----------|-----------|-----------|
| KB-15 | KB-35 | KB-60 | KB-120 |
| KB-20 | KB-40 | KB-65 | KB-140 |
| KB-25 | KB-45 | KB-80 | KB-535 |
| KB-30 | KB-50 | KB-100 | |
| KB-33 | KB-55 | | |

BK series



Dimensioned drawing

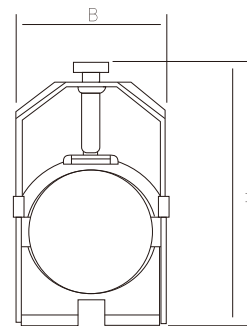

| Model No. | | Cable diameter Ø(mm) | Dimensional | |
|------------------|-----------------|-------------------------|-------------|-------|
| Galvanized steel | Stainless steel | | B(mm) | H(mm) |
| BK 14 | BK 14 E | 6-12 | 21 | 70 |
| BK 18 | BK 18 E | 12-18 | 23 | 70 |
| BK 22 | BK 22 E | 18-22 | 27 | 75 |
| BK 30 | BK 30 E | 22-30 | 39 | 85 |
| BK 38 | BK 38 E | 30-38 | 45 | 90 |
| BK 42 | BK 42 E | 38-42 | 47 | 95 |
| BK 50 | BK 50 E | 42-50 | 57 | 120 |
| BK 64 | BK 64 E | 50-64 | 70 | 130 |
| BK 70 | BK 70 E | 64-72 | 77 | 165 |
| BK 80 | BK 80 E | 72-82 | 87 | 183 |
| BK 100 | BK 100 E | 95-102 | 108 | 217 |

UZ series



Fix the cable on the cable clamp orbit by plastic pad.

| Model No. | Dimeter [mm] | Model No. | Dimeter [mm] |
|-----------|--------------|-----------|--------------|
| UZ6-12 | 6-12 | UZ30-34 | 30-34 |
| UZ12-16 | 12-16 | UZ34-38 | 34-38 |
| UZ14-18 | 14-18 | UZ38-42 | 38-42 |
| UZ18-22 | 18-22 | UZ42-46 | 42-46 |
| UZ22-26 | 22-26 | UZ46-50 | 46-50 |
| UZ26-30 | 26-30 | | |

Type C guide(Used in conjunction with BK cable clamp)

BK cable clamp is used

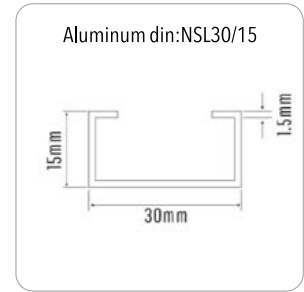

IF001 series cabinet sealing strip



IF001-16x3 / 5 / 7

| | | |
|------------|------------|------------|
| | | |
| IF001-16x3 | IF001-16x5 | IF001-16x7 |

ENCLOSURE SERIES Cable fastener

P4319.090



- Used for professional, safe and reliable fixing of cables and pipes.
- Can be inserted into punched rails 23×23mm
- Can be screwed to the round holes in the cabinet
- Can be screwed onto punched rails and punched profiles
- Multiple fixings of different sizes can be fixed with only two screws to achieve parallel connection of the fixings.



| Model No. | Suitable for cable diameter [mm] |
|-----------|----------------------------------|
| P4319.090 | 6-9 |
| P4319.120 | 9-12 |
| P4319.160 | 12-16 |
| P4319.200 | 16-20 |

TS series Din rail



The installing guide is designed according to the new Europe standard EN 50 022, EN 50 035, EN50 045. It has a precise height, strict tolerance, fine surface and good finish. The steel guide has been zinc-plated and yellow processed.

For the convenience of installing and making holes, there is a line printed on the center of guide which also exists on the aluminum and copper guide. Length and can be with round hole, long hole or trough.

Dimensioned

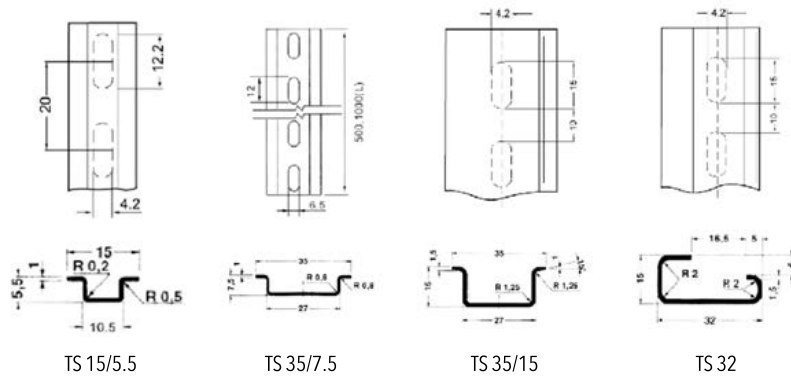

Product description

| | |
|-----------|---|
| TS 15/5.5 | According to 50 045-15×5mm Made of steel, yellow, without hole length: 2m NS 15/5.5 without hole |
| TS 35/7.5 | According to EN 50 022-35X7.5mm Made of steel, yellow, without hole length: 2m TS 35/7.5 without hole |
| TS 35/15 | According to EN 50 022-35X15mm Made of steel, yellow, without hole length: 2m TS 35/15 without hole |
| TS 32 | According to EN 50 035-G 32 Made of steel, yellow, without hole length: 2m TS 32 without hole |

Aluminum Din rail and accessories



Aluminum DIN rail

AL 35/15 thickness : 1.5mm
AL 35/7.5 thickness : 1.1mm or 1.5mm
AL 30/15 thickness : 1mm or 2mm



DIN rail retainer TST2/TST3/TSTW

Thickness : 2mm



LKWC-001

LKWC-001 wiring duct cutter

Used to cut wiring duct and cover, Max available width:125mm
 High strength cutting blade, anti-abrasion
 High efficient, free of burrs after cutting



LKDC-002

LKDC-002 Standard Din Rail Cutter

Used for: Din rail 35(W)x7.5(H)x1.0(T) mm or 35(w)x15(H)x1.5(T)mm,customizable for other size. Din rail Use Method and Notes:

- Lift the handle and insert the guide rail that needs to be cut into the corresponding cavity gap. When inserting the guide rail, try to maintain a 90 degree angle with the cavity surface to allow the guide rail to pass smoothly. Press down on the handle with force, and the guide rail will be cut off.
- When cutting, try to choose a relatively flat work site, which can ensure that the bottom plate of the cutter is under stable force and also reduce the cutting pressure on the cutter cavity.



LKDC-003

LKDC-003 Bench Type Din Rail Cutter

This guide rail cutter needs to be installed on a workbench and comes with a measuring ruler. It can cut any size you need. The standard type cutter can cut specifications: 35 (W) × 7.5 (H) × 1.0 (T)mm , 35 (W) × 15 (H) × 1.5 (T)mm, if other specifications of guide rails need to be cut, they can be customized. Usage and precautions:

- Lift the handle, insert the Din Rail into the matching cavity, make it vertical to the cavity surface at the same time and Din Rail will go through,press the handle, Din Rail will be cut off.
- Choose the flat ground during the operation, it ensures the cutter base bear stress evenly and reduces the stress on cavity.
- This cutter needs to be installed in the workbench, which also makes cutting guide rail more relaxed, no longer need to bend over for a long time to work, humanized design.