

DISTRIBUTION BOARDS

The CBI SFR Flush Mount Range

RESIDENTIAL COMMERCIAL



SFRFLC12 |
Load Centre | 12 Pole |

SFRFLC18 |
Load Centre | 18 Pole |

SFRFLC24 |
Load Centre | 24 Pole |

SFRFLC36 |
Load Centre | 36 Pole |

Features

- > Current ratings of up to 100 A
- > Available in 12, 18, 24, 36 way
- > Fire and UV resistant materials
- > Approvals: CE and RoHS
- > IEC / EN 61643-1 approved
- > Earthing can be reversed
- > Busbar can be removed
- > Rail is height adjustable
- > Conduit knockouts provided

SFR Flush Mount Distribution Board Range | Dimensions

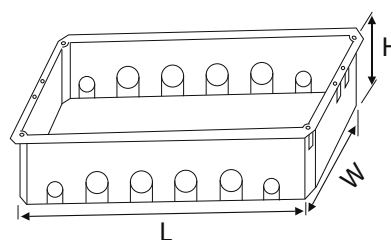
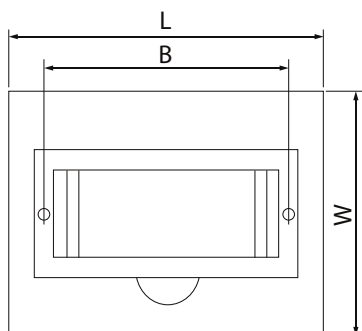

DISTRIBUTION BOARDS

SFR Flush Mount Distribution Board Range | Technical Data

	SFR Flush Mount
Equipment Type	Distribution Board
Standards	IEC / EN 60439-3
Approvals / Marks	RoHS 
Number of Modules	12, 18, 24, 36
On Load Current (A)	100/1-phase, 63/3-phase
Electric Ratings	Up to 100 A, 240/415 V, AC50/60 Hz
IP Rating	40
Material of Body	HIPS, ABS, ABS-UV Fire Resistant
Front Cover (Hinged)	AS, UV Resistant PC

SFR Flush Mount Distribution Board Range | Selection Data

Flush Mount Distribution Boards

BOM No.	Poles	Dimensions				Qty / CTN (pcs)
		L	W	H	B	
SFRFLC12	12	280	222	70	230	10
SFRFLC18	18	398	252	70	338	10
SFRFLC24	24	300	345	70	232	10
SFRFLC36	36	341	503	70	265	5
Qty / Box		1				

