

# CD COVER 40 - Cover profile

3240286

<https://www.phoenixcontact.com/au/products/3240286>



Please be informed that the data shown in this PDF document is generated from our online catalog. Please find the complete data in the user documentation. Our general terms of use for downloads are valid.

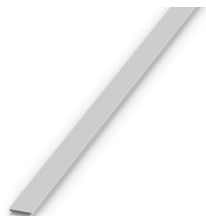

Cover for cable duct, gray, width: 40 mm, length: 2000 mm

## Commercial data

Item number	3240286
Packing unit	10 pc
Minimum order quantity	10 pc
Sales key	BE7431
Product key	BE7431
Catalog page	Page 555 (C-5-2015)
GTIN	4046356470131
Weight per piece (including packing)	362 g
Weight per piece (excluding packing)	357.1 g
Customs tariff number	39259020
Country of origin	DE

# CD COVER 40 - Cover profile

3240286

<https://www.phoenixcontact.com/au/products/3240286>



## Technical data

### Product properties

Product type	Cover
--------------	-------

### Dimensions

Width	40 mm
Height	2000 mm
Depth	11 mm
Length	2000 mm

### Material specifications

Color	stone gray (RAL 7030)
Material	PVC
Flammability rating according to UL 94	V0
Components	Lead-free

### Environmental and real-life conditions

#### Ambient conditions

Ambient temperature (operation)	-25 °C ... 60 °C
---------------------------------	------------------

# CD COVER 40 - Cover profile



3240286

<https://www.phoenixcontact.com/au/products/3240286>

## Classifications

### ECLASS

ECLASS-13.0	27400776
-------------	----------

### ETIM

ETIM 9.0	EC000727
----------	----------

### UNSPSC

UNSPSC 21.0	39131700
-------------	----------

# CD COVER 40 - Cover profile



3240286

<https://www.phoenixcontact.com/au/products/3240286>

## Environmental product compliance

### EU RoHS

Fulfills EU RoHS substance requirements	Yes, No exemptions
---	--------------------

### China RoHS

Environment friendly use period (EFUP)	EFUP-E
	No hazardous substances above the limits

### EU REACH SVHC

REACH candidate substance (CAS No.)	No substance above 0.1 wt%
-------------------------------------	----------------------------

Phoenix Contact 2025 © - all rights reserved  
<https://www.phoenixcontact.com>

PHOENIX CONTACT PTY Ltd  
Unit 7, 2-8 South Street  
Rydalmere NSW 2116  
1300 786 411  
[customerservice@phoenixcontact.com.au](mailto:customerservice@phoenixcontact.com.au)